



## Abridged user's manual

CRL82112/CRL82212/CRL82312/  
CRL82352/CRL82412/CRL82452  
DECT 6.0 cordless telephone/  
answering system with  
caller ID/call waiting



This Abridged user's manual provides you with basic installation and major operation instructions. A limited set of features are described in an abridged form.

Please refer to the online **CRL82112/CRL82212/CRL82312/CRL82352/CRL82412/CRL82452 DECT 6.0 cordless telephone/answering system with caller ID/call waiting** Complete user's manual for a full set of installation and operation instructions at **[www.telephones.att.com/manuals](http://www.telephones.att.com/manuals)**.

For customer service, visit our website at **[www.telephones.att.com](http://www.telephones.att.com)** or call **1 (800) 222-3111**. In Canada, dial **1 (866) 288-4268**.

This telephone system is compatible with certain AT&T DECT 6.0 cordless headsets. Visit **[www.telephones.att.com/headsets](http://www.telephones.att.com/headsets)** for a list of compatible cordless headsets.

Model number: CRL82112 (one handset)  
CRL82212 (two handsets)  
CRL82312/CRL82352 (three handsets)  
CRL82412/CRL82452 (four handsets)

Type: DECT 6.0 cordless telephone/answering system  
with caller ID/call waiting

Serial number: \_\_\_\_\_

Purchase date: \_\_\_\_\_

Place of purchase: \_\_\_\_\_

Both the model and serial numbers of your AT&T product can be found on the bottom of the telephone base.

Save your sales receipt and original packaging in case it is necessary to return your telephone for warranty service.

# Parts checklist

Your telephone package contains the following items. Save your sales receipt and original packaging in the event warranty service is necessary.

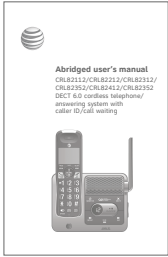

Abridged user's manual

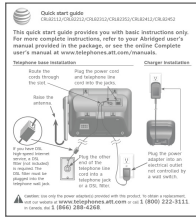

Quick start guide



Cordless handset  
(1 for CRL82112)  
(2 for CRL82212)  
(3 for CRL82312/CRL82352)  
(4 for CRL82412/CRL82452)



Telephone base

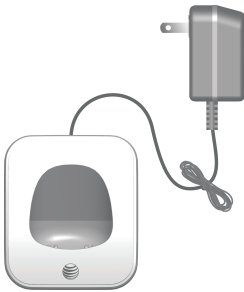

Charger for cordless handset with power adapter installed  
(1 for CRL82212)  
(2 for CRL82312/CRL82352)  
(3 for CRL82412/CRL82452)



Battery for cordless handset  
(1 for CRL82112)  
(2 for CRL82212)  
(3 for CRL82312/CRL82352)  
(4 for CRL82412/CRL82452)



Battery compartment cover  
(1 for CRL82112)  
(2 for CRL82212)  
(3 for CRL82312/CRL82352)  
(4 for CRL82412/CRL82452)

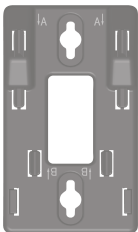

Wall-mount bracket

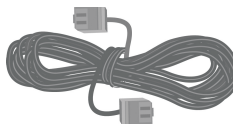

Telephone line cord



Power adapter for telephone base

# Abridged user's manual

CRL82112/CRL82212/CRL82312/  
CRL82352/CRL82412/CRL82452  
DECT 6.0 cordless telephone/  
answering system with  
caller ID/call waiting



For more detailed instructions, refer to the Complete user's manual at [www.telephones.att.com/manuals](http://www.telephones.att.com/manuals).

## Table of contents

### Getting started

Quick reference guide - handset.....	1
Quick reference guide - handset & telephone base.....	2
Telephone base and charger installation .....	3
Telephone base installation .....	3
Charger installation.....	3
Battery installation and charging.....	4
Installation options.....	6
Tabletop to wall-mount installation.....	6

### Telephone settings

Handset settings.....	7
Ringer volume.....	7
Ringer tone.....	7
LCD language .....	8
Set date/time .....	8
Caller ID announce.....	9
Set speed dial voicemail number.....	9
Voicemail (visual message waiting) indicator.....	10
Clear voicemail indicator .....	10
Key tone.....	10
Home area code.....	11
Dial mode.....	11
QUIET mode .....	12

### Telephone operation

Handset operation.....	13
Making a call.....	13
Answering a call .....	13
Ending a call.....	13
Temporary ringer silencing.....	13
Speakerphone .....	13
Last number redial.....	13
Equalizer.....	13
Volume control .....	14
Call waiting.....	14
Mute .....	14
Handset locator.....	14
Join a call in progress.....	14
Chain dialing.....	15
Audio Assist®.....	15
Blind transfer.....	15

### Multiple handset use

Intercom.....	16
Call transfer using intercom .....	17

### Directory

Directory .....	18
Create a new directory entry .....	18
Review directory entries .....	19
Search by name.....	19
Delete a directory entry.....	19
Edit a directory entry.....	19

Speed dial .....	20
Assign a speed dial number.....	20
Assign your speed dial voicemail number.....	20
Make a call using speed dial .....	20
Check your voicemail using speed dial.....	20

## Caller ID

Caller ID .....	21
Information about caller ID with call waiting.....	21
Missed (new) call indicator .....	21
Review the caller ID history.....	21
Dial a caller ID log entry .....	21
View dialing options.....	21
Save a caller ID log entry to the directory .....	22

## Answering system

Answering system settings.....	23
Announcement .....	23
Answer on/off.....	24
Call screening.....	24
Number of rings .....	25
Remote access code.....	25
Message alert tone .....	26
Message recording time.....	26
About the answering system.....	27
Answering system and voicemail indicators .....	27
Using the answering system and voicemail together.....	27
Message capacity .....	28
Voice prompts .....	28
Call screening at the telephone base.....	28
Call screening at the handset....	28
Call intercept.....	28
Temporarily turning off the message alert tone.....	28
Message playback.....	29
Options during playback.....	29
Delete all old messages.....	30
Recording and playing memos.....	30
Record a memo .....	30
Play back a memo .....	30
Remote access.....	31

## Appendix

Adding and registering handsets/ headsets.....	32
Register a handset to your telephone base.....	32
Deregistering handsets .....	33
Deregister all handsets from your telephone base.....	33
Troubleshooting .....	34
Maintenance.....	37
Important safety information.....	38
Safety information.....	38
Especially about cordless telephones .....	39
Precautions for users of implanted cardiac pacemakers.....	39
Pacemaker patients.....	39
Especially about telephone answering systems.....	39
For C-UL compliance.....	40
Mesures de sécurité importantes .....	40
FCC Part 68 and ACTA.....	43
FCC Part 15.....	45
Limited warranty.....	46
Technical specifications .....	48
DECT 6.0 digital technology.....	48
Telephone operating range .....	48
Redefining long range coverage and clarity .....	48
HD audio .....	48

## Index

Index .....	49
-------------	----

# Quick reference guide - handset

## CHARGE indicator

On when the handset is charging in the telephone base or charger.

## ▼CID/VOLUME

Press ▼CID to show caller ID history (page 21).

Press to scroll down while in menus.

While entering names or numbers, press to move the cursor to the left.

Press to decrease the listening volume when on a call (page 14), or to decrease the message playback volume (page 29).

## REDIAL/PAUSE

Press repeatedly to view the last 10 numbers dialed (page 13).

While entering numbers, press and hold to insert a dialing pause (page 18).

## PHONE/FLASH

Press to make or answer a call.

During a call, press to answer an incoming call when you receive a call waiting alert (page 14).

## 1

While reviewing a caller ID log entry, press repeatedly to add or remove 1 in front of the telephone number before dialing or saving it in the directory (page 21).

Press and hold to set (page 9) or dial your voicemail number (page 20).

## TONEX

Press to switch to tone dialing temporarily during a call if you have pulse service.

## 🔊/SPEAKER

Press to switch between the speakerphone and the handset (page 13).

Audio Assist® is a registered trademark of Advanced American Telephones.

## ▲DIR/VOLUME

Press ▲DIR to show directory entries (page 19).

Press to scroll up while in menus.

While entering names or numbers, press to move the cursor to the right.

Press to increase the listening volume when on a call (page 14), or to increase the message playback volume (page 29).

## MENU/SELECT

Press to show the menu.

While in the menu, press to select an item or save an entry or setting.

## 🔇 OFF/CANCEL

During a call, press to hang up.

While in a menu, press to cancel an operation, back up to the previous menu, or exit the menu display; or press and hold this key to exit to idle mode.

Press and hold while the telephone is not in use to erase the missed call indicator.

## QUIET # (pound key)

Press repeatedly to display other dialing options when reviewing a caller ID log entry (page 21).

Press and hold to enter the QUIET mode setting screen, or to deactivate QUIET mode (page 12).

## AUDIO ASSIST®

Voices will sound louder and clearer when you press **AUDIO ASSIST®** while on a call using the handset (page 15).

## MUTE/DELETE

During a call, press to mute the microphone.

While reviewing the caller ID history, the directory or the redial memory, press to delete an individual entry.

While predialing, press to delete digits.

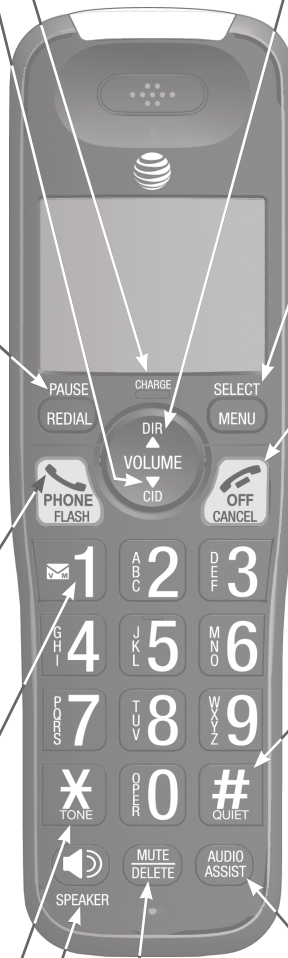

# Quick reference guide - handset & telephone base

## Handset side view



### EQ

During an outside call, intercom call, message or announcement playback, press to change the audio quality to best suit your hearing.

## Telephone base

### ANSWER ON

Press to turn the built-in answering system on or off (page 24).

### HANDSET LOCATOR

While the phone is idle, press to page all handsets (page 14).

Press and hold to begin handset deregistration (page 33).

### Message counter

Shows the number of messages or other answering system information.

### X/DELETE

Press to delete the message currently playing (page 29).

Press twice to delete all old messages when the phone is not in use (page 30).

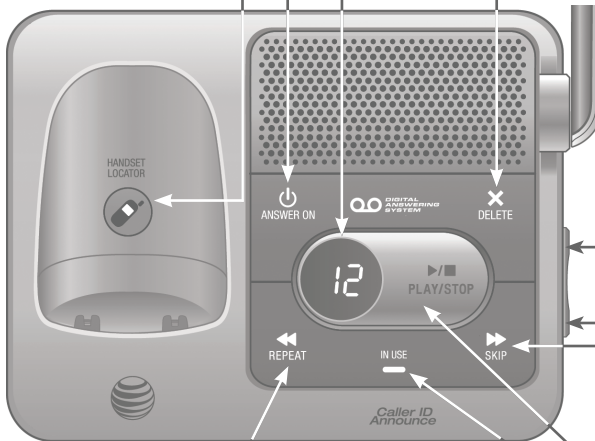

### VOL/VOL

During message playback, press to adjust the listening volume (page 29).

While in idle mode, press to adjust the base ringer volume.

### SKIP

Press to skip a message (page 29).

### PLAY/STOP

Press to start or stop message playback (page 29).

### REPEAT

Press to repeat a message.  
Press twice to play the previous message (page 29).

### IN USE indicator

On when the handset is in use, or when the answering system is answering an incoming call.

On when a handset is being registered.

Flashes when there is an incoming call or when handsets are being deregistered.

Flashes when another telephone is in use on the same line.

## Telephone base and charger installation

Install the telephone base and charger, as shown below.

### Telephone base installation

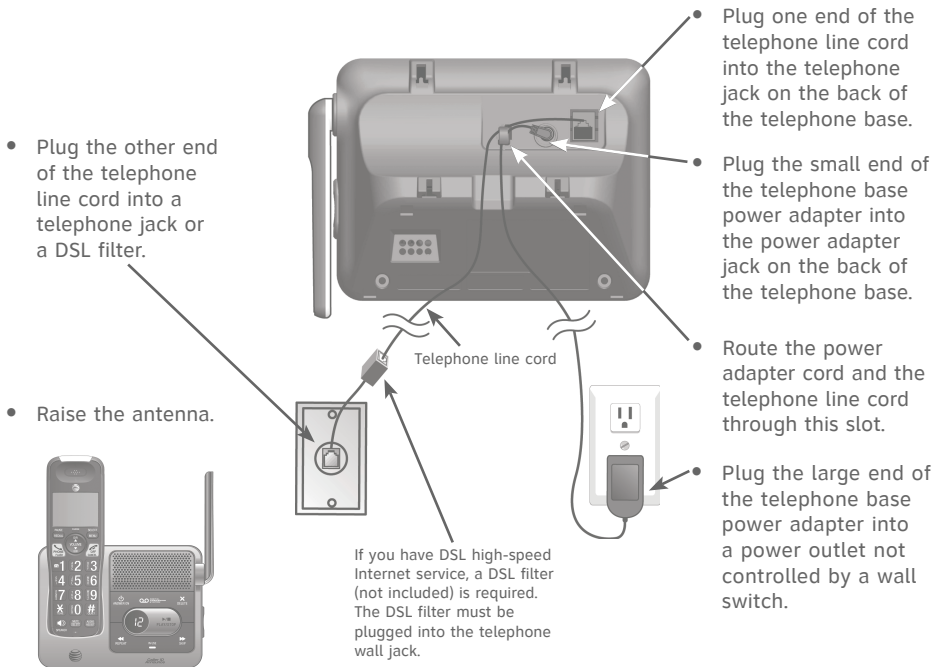

### Charger installation

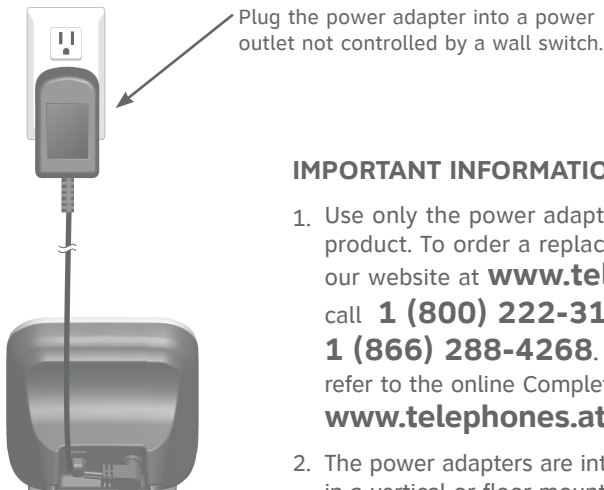

#### IMPORTANT INFORMATION



1. Use only the power adapter(s) supplied with this product. To order a replacement power adapter, visit our website at [www.telephones.att.com](http://www.telephones.att.com) or call **1 (800) 222-3111**. In Canada, dial **1 (866) 288-4268**. For more detailed instructions, refer to the online Complete user's manual at [www.telephones.att.com/manuals](http://www.telephones.att.com/manuals).
2. The power adapters are intended to be correctly oriented in a vertical or floor mount position. The prongs are not designed to hold the plug in place if it is plugged into a ceiling, under-the-table or cabinet outlet.



Getting started

## Battery installation and charging

Once you have installed the battery, the screen indicates the battery status (see the following table). For best performance, keep the handset in the telephone base or charger when not in use. The battery is fully charged after 10 hours of continuous charging. See the table in the **Technical specifications** section on page 48 for battery operating times.

Battery indicators	Battery status	Action
The screen is blank, or shows <b>Place in charger</b> and  (flashing).	Battery has no or very little charge. The handset cannot be used.	Charge without interruption (at least 30 minutes).
The screen shows <b>Low battery</b> and  (flashing).	Battery has enough charge to be used for a short time.	Charge without interruption (at least 30 minutes).
The screen shows <b>HANDSET X.</b>	Battery is charged.	To keep the battery charged, place it in the telephone base or charger when not in use.

### Step 1

Plug the battery connector securely into the socket inside the handset battery compartment. Insert the supplied battery with the label **THIS SIDE UP** facing up, as indicated.

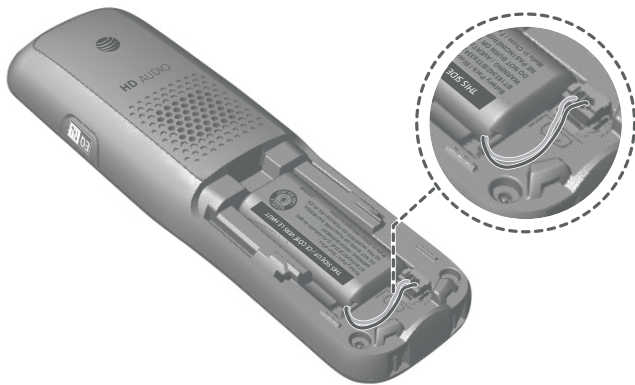

## Battery installation and charging

### Step 2

Align the cover flat against the battery compartment, then slide it upwards until it clicks into place.

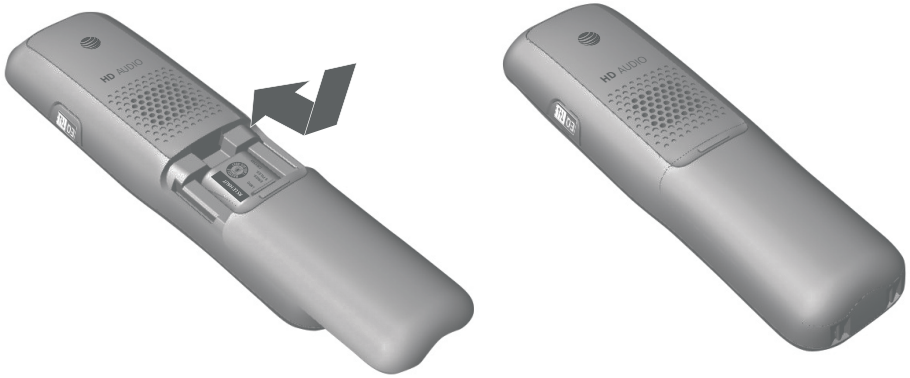

### CHARGE light



### Step 3

Charge the handset by placing it face forward in the telephone base or charger. The **CHARGE** light on the handset is on during charging.

## IMPORTANT INFORMATION

1. Use only the supplied rechargeable battery or replacement battery (model BT183342/BT283342). To order, visit our website at **[www.telephones.att.com](http://www.telephones.att.com)** or call **1 (800) 222-3111**. In Canada, dial **1 (866) 288-4268**. For more detailed instructions, refer to the online Complete user's manual at **[www.telephones.att.com/manuals](http://www.telephones.att.com/manuals)**.
2. If you do not use the handset for a long time, disconnect and remove the battery to prevent possible leakage.

## Installation options

Your telephone base is ready for tabletop use. If you want to mount your telephone on a wall, use the provided wall-mount bracket to connect with a standard dual-stud telephone wall-mounting plate. If you do not have this mounting plate, you can purchase one from many hardware or consumer electronics retailers. You might need a professional to install the mounting plate.

### Tabletop to wall-mount installation

1. Plug the power cord and telephone line into the telephone base. If you are using a DSL filter, plug the other end of the telephone line into the filter. Route the telephone line cord (or DSL filter) through the wall-mount bracket hole.
2. Position the telephone base, as shown below. Insert the extended tabs (see below figure 2) of the wall-mount bracket into the slots on the back of the telephone base (marked **B**). Push the telephone base down until it is securely in place.
3. Plug the telephone line cord (or DSL filter) into the wall jack. Plug the power adapter into a power outlet not controlled by a wall switch.
4. Align the holes on the wall-mount bracket with the standard wall plate and slide the wall-mount bracket down until it locks securely. Bundle the telephone line cord and power adapter cord neatly with twist ties.

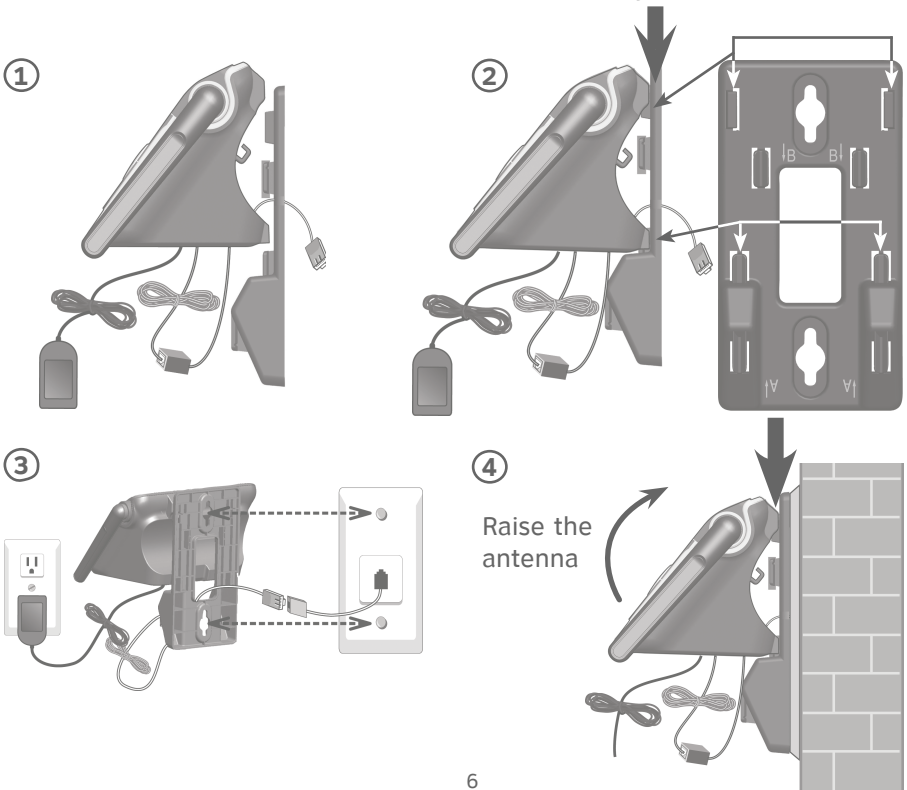

## Handset settings

Use the menu to change the telephone settings.

1. Press **MENU/SELECT** when the telephone is not in use to enter the main menu.
2. Press **▼CID** or **▲DIR** to scroll to the feature to be changed. When scrolling through the menu, the **>** symbol indicates the selected menu item.
3. Press **MENU/SELECT** to select the highlighted item.



**NOTE:** Press **OFF/CANCEL** to cancel an operation, back up to the previous menu or exit the menu display. Press and hold **OFF/CANCEL** to return to idle mode.

### Ringer volume

---

You can adjust the ringer volume level or turn the ringer off.

1. Press **MENU/SELECT** in idle mode to enter the main menu.
2. Use **▼CID** or **▲DIR** to scroll to **>Ringers**, then press **MENU/SELECT**.
3. Press **MENU/SELECT** again to select **>Ringer volume**.
4. Press **▼CID** or **▲DIR** to sample each volume level.
5. Press **MENU/SELECT** to save your preference.



**NOTE:** The handset ringer volume also determines the ringer volume for intercom calls.

### Ringer tone

---

You can choose one of 10 ringer tones.

1. Press **MENU/SELECT** in idle mode to enter the main menu.
2. Use **▼CID** or **▲DIR** to scroll to **>Ringers**, then press **MENU/SELECT**.
3. Press **▼CID** or **▲DIR** to scroll to **>Ringer tone**, then press **MENU/SELECT**.
4. Press **▼CID** or **▲DIR** to sample each ringer tone.
5. Press **MENU/SELECT** to save your preference.



**NOTE:** If you turn off the ringer volume, you do not hear ringer tone samples.

## Handset settings

### LCD language

---

You can select English, French, or Spanish to be used for all screen displays.

1. Press **MENU/SELECT** in idle mode to enter the main menu.
2. Use **▼CID** or **▲DIR** to scroll to **>Settings**, then press **MENU/SELECT**.
3. Press **MENU/SELECT** to choose **>LCD language**.
4. Press **▼CID** or **▲DIR** to scroll to the desired language, then press **MENU/SELECT**. The screen prompts **Set English/Français/Español as LCD language?**
5. Press **MENU/SELECT** to confirm.



**NOTE:** If you accidentally change the LCD language to French or Spanish, you can reset it back to English without going through the French or Spanish menus. Press **MENU/SELECT** in idle mode, then enter **364#**. There is a confirmation tone.

### Set date/time

---

The answering system announces the day and time of each message prior to playing it. Before using the answering system, set the date and time as follows. If you subscribe to caller ID service, the day, month and time are set automatically with each incoming call. The year must be set so that the day of the week can be calculated from the caller ID information.

1. When the handset is in idle mode, press **MENU/SELECT** to enter the main menu.
2. Press **▼CID** or **▲DIR** to scroll to **>Set date/time** and then press **MENU/SELECT**.
3. Enter the month using the dialing keys.
4. Enter the day using the dialing keys.
5. Enter the year using the dialing keys, then press **MENU/SELECT** to move on to set the time.
6. Enter the hour using the dialing keys.
7. Enter the minute using the dialing keys.
8. Press **▼CID** or **▲DIR** to highlight **AM** or **PM**, then press **MENU/SELECT** to confirm.



**NOTE:** If the clock is not set when a message is recorded, the system announces, "Time and day not set," before it plays the message.

## Handset settings

### Caller ID announce

---

The caller ID announce feature lets you know who's calling without having to look at the display.

#### To turn on/off the caller ID announce on your handset or base:

1. Press **MENU/SELECT** in idle mode to enter the main menu.
2. Use **▼CID** or **▲DIR** to scroll to **>Settings**, then press **MENU/SELECT**.
3. Use **▼CID** or **▲DIR** to scroll to **>Caller ID annnc**, then press **MENU/SELECT**.
4. Use **▼CID** or **▲DIR** to highlight the desired option, then press **MENU/SELECT**.
  - **Set all On/Off** - Change the setting for the base and all handsets.
  - **Local handset** - Change the setting for that handset only.
  - **Base** - Change the setting for the telephone base only.
5. Use **▼CID** or **▲DIR** to highlight **>On** or **>Off**, then press **MENU/SELECT**.



#### NOTES:

- To use the caller ID announce feature, you must subscribe to caller ID service from your telephone service provider.
- Pronunciation of names may vary with this feature. Not all names may be pronounced correctly.

### Set speed dial voicemail number

---

This feature lets you save your voicemail number for quick access when you press and hold the  **1** key.

#### To set your voicemail number:

1. Press **MENU/SELECT** in idle mode to enter the main menu.
2. Use **▼CID** or **▲DIR** to scroll to **>Settings**, then press **MENU/SELECT**.
3. Use **▼CID** or **▲DIR** to scroll to **>Voicemail #**, then press **MENU/SELECT**.
4. Use the dialing keys to enter the voicemail access number provided by your telephone service provider.
  - Press **▼CID** or **▲DIR** to move the cursor to the left or right.
  - Press **MUTE/DELETE** to erase a digit.
  - Press and hold **MUTE/DELETE** to erase all digits.
  - Press **REDIAL/PAUSE** to enter a three-second dialing pause (a **p** appears).
5. Press **MENU/SELECT** to save.

### **Voicemail (visual message waiting) indicator**

---

If you subscribe to a voicemail service offered by your telephone service provider, **New voicemail** and the  icon appear on the handset screen when you have new voicemail messages. Contact your service provider for more information and assistance about using your voicemail service.

### **Clear voicemail indicator**

---

Use this feature when the telephone indicates there is new voicemail but there is none. For example, when you have accessed your voicemail while away from home. This feature only turns off the displayed **New voicemail** and the  icon; it does not delete your voicemail messages. As long as you have new voicemail messages, your telephone service provider continues to send the signal to turn on the indicator.

#### **To manually turn off the new voicemail indicator:**

1. Press **MENU/SELECT** when in idle mode to enter the main menu.
2. Use **▼CID** or **▲DIR** to scroll to **>Settings**, then press **MENU/SELECT**.
3. Use **▼CID** or **▲DIR** to scroll to **>Clr voicemail**, then press **MENU/SELECT**.  
The screen shows **Reset Voicemail Indicator?**
4. Press **MENU/SELECT** again to turn the voicemail indicator off.



**NOTE:** For information about using your voicemail service, contact your telephone service provider.

### **Key tone**

---

The handset is set to beep with each key press. You can adjust the key tone volume or turn it off.

1. Press **MENU/SELECT** in idle mode to enter the main menu.
2. Use **▼CID** or **▲DIR** to scroll to **>Settings**, then press **MENU/SELECT**.
3. Use **▼CID** or **▲DIR** to scroll to **>Key tone**, then press **MENU/SELECT**.
4. Use **▼CID** or **▲DIR** to select the desired volume or **Off**.
5. Press **MENU/SELECT** to save your preference.

## Handset settings

### Home area code

---

If you dial seven digits to make a local call (no area code required), enter your area code into the telephone as the home area code. When you receive a call from within your home area code, the caller ID history only displays the seven digits of the telephone number.

This feature makes it easy for you to place a call from the caller ID log. If you dial 10 digits to make a local phone call, do not use this home area code feature. If you do, you cannot place local calls from your caller ID log, as they will have only seven digits.

#### To set the home area code:

1. Press **MENU/SELECT** in idle mode to enter the main menu.
2. Use **▼CID** or **▲DIR** to scroll to **>Settings**, then press **MENU/SELECT**.
3. Use **▼CID** or **▲DIR** to scroll to **>Home area code**, then press **MENU/SELECT**.
4. Use the dialing keys to enter a three-digit home area code.
  - Press **MUTE/DELETE** to delete a digit.
  - Press and hold **MUTE/DELETE** to delete all digits.
5. Press **MENU/SELECT** to save.



**NOTE:** If in the future, your telephone service provider requires you to dial 10 digits to make a local call (area code plus telephone number), you need to delete your home area code and dial out locally from the caller ID log. With the home area code displayed, press and hold **MUTE/DELETE** until the digits are deleted, and then press **MENU/SELECT**. The home area code is now restored to its default setting of \_ \_ \_ (empty).

### Dial mode

---

The dial mode is preset to tone dialing. If you have pulse (rotary) service, you must change the dial mode to pulse dialing before using the telephone.

1. Press **MENU/SELECT** in idle mode to enter the main menu.
2. Use **▼CID** or **▲DIR** to scroll to **>Settings**, then press **MENU/SELECT**.
3. Use **▼CID** or **▲DIR** to scroll to **>Dial mode**, then press **MENU/SELECT**.
4. Use **▼CID** or **▲DIR** to highlight **>Touch-tone** or **>Pulse**, then press **MENU/SELECT**.



## Handset settings

### QUIET mode

---

When **QUIET** mode is turned on, the telephone silences all sounds during the set period of time (1-12 hours). After you turn on **QUIET** mode, this feature activates immediately and the answering system turns on automatically. When **QUIET** mode is on, the answering system takes calls and records messages without broadcasting them.

#### To turn QUIET mode on:

1. Press and hold QUIET # in idle mode. The screen shows **Quiet: \_\_ hours (1-12 hours)**.
2. Use the dialing keys to enter the desired number of hours (1-12) you would like to turn on **QUIET** mode, then press **MENU/SELECT**.

#### To turn QUIET mode off:

- While **QUIET** mode is on, press and hold QUIET #.



#### NOTES:

- If you change the base ringer, handset ringer, ringer volume, key tone, or caller ID announce features when **QUIET** mode is on, the sample plays but the feature is still muted after saving the setting.
- After **QUIET** mode is turned off or the set period of time has expired, all muted features will be activated again.

## Handset operation

### Making a call

---

- Press **\PHONE/FLASH** or **📞/SPEAKER**, then enter the telephone number.

### Answering a call

---

- Press **\PHONE/FLASH** or **📞/SPEAKER**.  
-OR-
- Press any dialing key (**0-9**, **TONE X** or **#**).

### Ending a call

---

Press **📞OFF/CANCEL** or return the handset to the telephone base or charger.

### Temporary ringer silencing

---

Press **📞OFF/CANCEL** or **MUTE/DELETE** while the telephone is ringing to silence the ringer temporarily on that handset only. This turns off the ringer without disconnecting the call. The next incoming call rings normally at the preset volume.

### Speakerphone

---

During a call, press **📞/SPEAKER** to switch between handsfree speakerphone and normal handset use. Press **📞OFF/CANCEL** to hang up, or return the handset to the telephone base or charger.



**NOTE:** The speakerphone uses more power than the normal handset. If the handset battery becomes very low while you are using the speakerphone, the call remains in speakerphone mode until you hang up or the battery becomes depleted.

### Last number redial

---

Each handset stores the last 10 telephone numbers dialed (up to 30 digits).

Press **REDIAL/PAUSE**, then press **▼CID** or **▲DIR**, or press **REDIAL/PAUSE** repeatedly to view up to 10 recently called numbers. Press **\PHONE/FLASH** or **📞/SPEAKER** to dial the displayed number.

### Equalizer

---

The equalizer feature on the handset enables you to change the quality of the audio to best suit your hearing.

While on an outside call or intercom call, or listening to a message or announcement, press **EQ** to select the equalizer setting **Treble 1**, **Treble 2**, **Bass** or **Natural** (the default setting).

## Handset operation

### Volume control

---

While on a call, press **▼CID/VOLUME** to decrease or press **▲DIR/VOLUME** to increase the listening volume. You can set the listening volume to one of six levels.

### Call waiting

---

If you subscribe to call waiting service from your telephone service provider, and someone calls while you are already on a call, you hear two beeps. Press **☎PHONE/FLASH** to put your current call on hold and take the new call.

Press **☎PHONE/FLASH** at any time to switch back and forth between calls.

### Mute

---

The mute function allows you to hear the other party, but the other party cannot hear you.

Press **MUTE/DELETE** while on a call to enable or disable the mute feature.

### Handset locator

---

Use this feature to find misplaced handsets.

#### To start the paging tone:

- Press **☎/HANDSET LOCATOR** on the telephone base to start the paging tone on all handsets for 60 seconds.



**NOTE:** If you press **☎OFF/CANCEL** or **MUTE/DELETE** on a handset, the ringer of that handset stops, but the paging to the rest of the handsets continues.

#### To stop the paging tone:

- Press **☎PHONE/FLASH**, **🔊/SPEAKER**, or any dialing key (**0-9**, **TONE ✕**, or **#**) on the handset(s).

**-OR-**

- Press **☎/HANDSET LOCATOR** on the telephone base.

### Join a call in progress

---

When a handset is already on a call and you would like to join the call, press **☎PHONE/FLASH** or **🔊/SPEAKER** on your handset.

Press **☎OFF/CANCEL** or place the handset in the telephone base or charger to end the call. The call does not end until all handsets hang up.



**NOTE:** You can use a maximum of four system handsets at the same time on an outside call.

## Options while on calls

### Chain dialing

---

Use this feature to initiate a dialing sequence from the numbers in the directory, caller ID history or redial memory while you are on a call.

#### To access the directory or caller ID log while on a call:

1. Press **MENU/SELECT**.
2. Press **▼CID** or **▲DIR** to scroll to **>Directory** or **>Caller ID log**, then press **MENU/SELECT**.
3. Press **▼CID** or **▲DIR** to scroll to the desired number.
4. Press **MENU/SELECT** to dial the number shown.

#### To access the redial list while on a call:

1. Press **REDIAL/PAUSE** to show the most recently dialed number.
2. Press **▼CID** or **▲DIR** to scroll to the desired number, or press **REDIAL/PAUSE** repeatedly to show the last 10 recently dialed numbers. Then, press **MENU/SELECT** to dial the number shown.

### Audio Assist®

---

The Audio Assist® feature makes voices sound louder and clearer. Press **AUDIO ASSIST®** while you are on a call using the handset to turn Audio Assist® on or off. This feature turns off automatically after you hang up.

### Blind transfer

---

While on an outside call, you can transfer it to a specific handset or any handset. This feature is not available for model CRL82112 unless you purchase an accessory handset (AT&T model CRL80112).

#### To transfer an outside call directly without notifying the desired handset:

1. During the call, press **MENU/SELECT**.
2. Press **MENU/SELECT** to choose **>Transfer**.
  - If you have a two-handset system, the outside call is put on hold and your handset screen shows **Transferring call....** The other handset rings and its screen shows **Transfer from other handset**.
  - If you have more than two handsets, your screen shows **TRANSFER TO:**. Press **▼CID** or **▲DIR** to scroll to the desired handset and press **MENU/SELECT**. The outside call is put on hold and your handset screen shows **Transferring call...** or **Transferring call to all...**
3. To answer the call on the destination handset, press **\PHONE/FLASH** or **🔊/SPEAKER**. The original handset shows **Call transferred** and goes to idle mode.

## Intercom

Use the intercom feature for conversations between two handsets. This feature is only available if you have at least two system handsets. Intercom is not available for the CRL82112 model. You can buy accessory handsets (AT&T model CRL80112) to expand your system.

Use a handset to initiate intercom calls and transfer calls.

1. Press **MENU/SELECT** in idle mode to enter the main menu. Press **▼CID** or **▲DIR** to scroll to **>Intercom**, then press **MENU/SELECT**. Choose from the following options.
  - If you have a two-handset system, your handset screen shows **Calling other handset**.
  - If you have more than two handsets, your screen shows **INTERCOM TO:**. Press **▼CID** or **▲DIR** to scroll to the desired handset and press **MENU/SELECT**. Your handset screen shows **Calling HANDSET X** or **Calling all handsets**.

The other handset(s) rings and shows either **Other handset is calling** or **HANDSET X is calling**, or **HANDSET X is calling all** (**X** represents the handset number).

2. To answer the intercom call, press **PHONE/FLASH**, **📞/SPEAKER** or any dialing key (**0-9**, **TONE ✕**, or **#**) on any called handset.
3. To end the intercom call, one party presses **OFF/CANCEL**, or places the handset back in the telephone base or charger. The other party hears four beeps. Both handsets display **Intercom ended**.

## Call transfer using intercom

Use the intercom feature to transfer an outside call to another system handset. You can also share an outside call with another system handset. This feature is available only if you have two or more handsets.

### To transfer or share an outside call using intercom:

1. During the call, press **MENU/SELECT**.
2. Press **▼CID** or **▲DIR** to scroll to **>Intercom** and press **MENU/SELECT**.
3. Choose the handset(s) you would like to transfer the call to:
  - If you have a two-handset system, your handset screen shows **Calling other handset**.
  - If you have more than two handsets, your screen shows **INTERCOM TO:**. Press **▼CID** or **▲DIR** to scroll to the desired handset and press **MENU/SELECT**. Your handset screen shows **Calling HANDSET X** or **Calling all handsets**.
4. When the destination handset(s) picks up, your handset shows **Intercom** and the outside call is put on hold. Then, you have the following options:
  - You can transfer the call. Press **MENU/SELECT** twice to select **>Transfer** on the calling handset. Your screen shows **Call transferred**. The other handset automatically connects to the outside call.
  - You can let the other handset join you on the outside call in a three-way conversation. Press **MENU/SELECT**. Press **▼CID** or **▲DIR** to highlight **>Share call** on the calling handset, then press **MENU/SELECT**.
  - You can end the intercom call and continue the outside call with your handset. Press **☎PHONE/FLASH** on your handset (the ended intercom call party hears four beeps), or the other person can press **☎OFF/CANCEL** on the other system handset.

## Directory

The directory can store up to 50 entries, which are shared by all system handsets.

### **Create a new directory entry**

---

1. Press **MENU/SELECT** when the handset is not in use.
2. Scroll to select **>Directory**, then select **>Add contact**.
3. Use the dialing keys to enter a telephone number (up to 30 digits) when prompted.
  - Press **▼CID** or **▲DIR** to move the cursor to the left or right.
  - Press **MUTE/DELETE** to erase a digit.
  - Press and hold **MUTE/DELETE** to erase all digits.
  - Press and hold **REDIAL/PAUSE** to enter a three-second dialing pause (a **p** appears).

**-OR-**

Copy a number from the redial list by pressing **REDIAL/PAUSE** repeatedly to locate the number. Press **MENU/SELECT** to copy the number.

4. Press **MENU/SELECT** to move on to the name.
5. Use the dialing keys to enter a name (up to 15 characters) when prompted. Each time you press a key, the character on that key appears. Additional key presses produce other characters on that key.
  - Press **▼CID** or **▲DIR** to move the cursor to the left or right.
  - Press **0** to add a space.
  - Press **MUTE/DELETE** to erase a character.
  - Press and hold **MUTE/DELETE** to erase all characters.
6. Press **MENU/SELECT** to store your new directory entry.

## Review directory entries

---

Press **DIR▲** when the handset is not in use. Press **▼CID** or **▲DIR** to browse through the directory.

## Search by name

---

1. Press **DIR▲** in idle mode to show the first listing in the directory.
2. When an entry appears, use the dialing keys (**0-9**) to start a name search. The directory shows the first name beginning with the first letter associated with the dialing key, if there is an entry in the directory beginning with that letter. Press **▼CID** or **▲DIR** to scroll through the directory.
3. To see other names starting with the letters on the same dialing key, keep pressing the key. The names appear in alphabetical order.

## Delete a directory entry

---

To delete the displayed directory entry, press **MUTE/DELETE**. Press **MENU/SELECT** to confirm. You cannot retrieve a deleted entry.

## Edit a directory entry

---

1. When a directory entry displays, press **MENU/SELECT**. The screen shows **EDIT NUMBER** along with the phone number to be edited. If you only want to edit the name, skip to Step 3.
2. To edit the number:
  - Use the dialing keys to add digits.
  - Press **▼CID** or **▲DIR** to move the cursor to the left or right.
  - Press **MUTE/DELETE** to erase a digit.
  - Press and hold **MUTE/DELETE** to erase all digits.
  - Press and hold **REDIAL/PAUSE** to add a three-second pause, if desired.
3. Press **MENU/SELECT** to save the number. The screen shows **EDIT NAME** along with the name to be edited.
4. To edit the name:
  - Use the dialing keys to add characters.
  - Press **▼CID** or **▲DIR** to move the cursor to the left or right.
  - Press **MUTE/DELETE** to erase a character.
  - Press and hold **MUTE/DELETE** to erase all characters.
5. Press **MENU/SELECT**.



## Speed dial

The telephone system has 9 speed dial locations (**2-9, 0**) and a voicemail access location  **1** where you can store the telephone numbers you wish to dial more quickly. You can store up to 30 digits in each location. Speed dial assignments can only be selected from the existing directory entries. The voicemail access number must be manually entered. In the directory, speed dial locations are indicated by their number on the bottom left side of the screen.

### **Assign a speed dial number**

---

1. When the telephone is idle, press **MENU/SELECT**.
2. Press **▼CID** or **▲DIR** to scroll to **>Directory**. Press **MENU/SELECT**.
3. Press **▼CID** or **▲DIR** to scroll to **>Speed dial**. Press **MENU/SELECT**.
4. Press **▼CID** or **▲DIR** to choose your desired speed dial location (**2-9, 0**), then press **MENU/SELECT**. The screen briefly shows **Copy from Directory...** and then enters your directory list.
5. Press **▼CID** or **▲DIR** to scroll to the phone number you wish to assign to the selected speed dial location.
6. Press **MENU/SELECT** to save.

### **Assign your speed dial voicemail number**

---

See the **Set speed dial voicemail number** section on page 9 for instructions on assigning your speed dial voicemail number.

### **Make a call using speed dial**

---

When in idle mode, press and hold the dialing key (**2-9, 0**) corresponding to the assigned location you wish to call.

### **Check your voicemail using speed dial**

---

Press and hold the  **1** key on your handset to dial your voicemail number.

## Caller ID

This product supports caller ID services offered by most telephone service providers. The telephone stores caller ID information of the last 50 incoming calls in the telephone base. This information is common to all handsets.

### Information about caller ID with call waiting

---

Caller ID with call waiting lets you see the name and telephone number of the caller before answering the call, even while on another call.

There are fees for caller ID services. In addition, services may not be available in all areas. Contact your telephone service provider for more information about caller ID services.

### Missed (new) call indicator

---

When a handset is in idle mode and has new or missed calls, its screen shows **XX Missed calls**.

If you do not want to review the missed calls one by one, but still want to keep them in the caller ID history, you can press and hold  **OFF/CANCEL** for four seconds when the handset is idle.

### Review the caller ID history

---

1. When a handset is in idle mode, press **▼CID** to review the caller ID history in reverse chronological order starting with the most recent call.
2. Press **▼CID** or **▲DIR** to scroll through the list.
3. Press  **OFF/CANCEL** to exit the caller ID history.

### Dial a caller ID log entry

---

1. When in the caller ID log, press **▼CID** or **DIR▲** to browse.
2. Press **\PHONE/FLASH** or  **SPEAKER** to dial the displayed entry.

### View dialing options

---

While reviewing the caller ID log, press **#** repeatedly to show different dialing options for local and long distance numbers before dialing or saving the telephone number in the directory.

Press **1** repeatedly if you need to add or remove **1** in front of the telephone number before dialing or saving it in the directory.

When the number is in the correct format for dialing, press **\PHONE/FLASH** or  **SPEAKER** to call the number.



### Save a caller ID log entry to the directory

---

1. When in the caller ID log, press ▼**CID** or ▲**DIR** to browse.
2. Press **MENU/SELECT** to select an entry. The screen displays **EDIT NUMBER**.
3. Use the dialing keys to edit the number.
  - Press ▼**CID** or ▲**DIR** to move the cursor to the left or right.
  - Press **MUTE/DELETE** to backspace and erase a digit.
  - Press and hold **MUTE/DELETE** to erase all digits.
  - Press and hold **REDIAL/PAUSE** to insert a three-second dialing pause (a **p** appears).
4. Press **MENU/SELECT** to move to the name. The screen displays **EDIT NAME**. Use the dialing keys to edit the name.
  - Press ▼**CID** or ▲**DIR** to move the cursor to the left or right.
  - Press **MUTE/DELETE** to erase a character.
  - Press and hold **MUTE/DELETE** to erase all characters.
  - Press **#** to move the last word to the front. For example, **Johnson Charlie** becomes **Charlie Johnson** when you press **#**.
5. Press **MENU/SELECT** when done. The handset shows **Saved**.



**NOTES:**

- You might need to change how a caller ID number is dialed if the entry does not appear in the correct format. Caller ID numbers might appear with an area code that is not necessary for local calls, or without a 1 that is necessary for long distance calls (see **View dialing options** on the previous page).
- If the name you received from the telephone service provider is all in capital letters, the first letter of every word remains a capital letter, while other letters become lower case. However, the next letter after the prefix "Mac", "Mc", or "O", is kept as a capital letter. For example, the "D" in "MacDonald" is kept as a capital letter. Another exception is that "VAN DER" will be changed to "Van der".
- If the telephone number from the caller ID information has already been saved in the directory under a different name, the new name will overwrite the old one.

## Answering system settings

Use the answering system menu of a system handset to set up the announcement message, turn on or off the answering system or message alert tone, activate call screening, or change the number of rings, message recording time, or remote access code.

### Announcement

---

Your outgoing announcement plays when calls are answered by the answering system.

The telephone has a default outgoing announcement, *"Hello. Please leave a message after the tone."* You can use this announcement, or record your own.

#### To record a new outgoing announcement:

1. When the handset is in idle mode, press **MENU/SELECT** to enter the main menu.
2. Press **▼CID** or **▲DIR** to scroll to **>Answering sys**, then press **MENU/SELECT**.
3. Press **MENU/SELECT** again to select **>Announcement**.
4. Press **MENU/SELECT** again to select **>Record annnc**. The system announces, *"Record after the tone. Press 5 when you are done."*
5. Facing the handset, record your announcement and press **5** to end recording. Your recorded announcement plays.

To listen to the recorded announcement again, wait after playback completed, then scroll to **>Play annnc** and press **MENU/SELECT**.

#### To reset your outgoing announcement:

1. When the handset is in idle mode, press **MENU/SELECT** to enter the main menu.
2. Press **▼CID** or **▲DIR** to scroll to **>Answering sys**, then press **MENU/SELECT**.
3. Press **MENU/SELECT** again to select **>Announcement**.
4. Press **▼CID** or **▲DIR** to scroll to **>Reset annnc** and press **MENU/SELECT**. The screen prompts **Reset to default annnc?**. Press **MENU/SELECT** to confirm.

When your announcement is reset, the system answers calls with the default announcement, as described above. You cannot delete the default announcement.

## Answering system settings

### Answer on/off

---

By default, the answering system is on and ready to record messages. If you turn the answering system off, it does not answer calls and record messages.

#### To turn the answering system on or off:

##### Using the telephone base:

- Press **⏻/ANSWER ON** to turn the answering system on or off.



##### Using a handset:

1. When the handset is in idle mode, press **MENU/SELECT** to enter the main menu.
2. Press **▼CID** or **▲DIR** to scroll to **>Answering sys**, then press **MENU/SELECT**.
3. Press **▼CID** or **▲DIR** to scroll to **>Answer ON/OFF**, then press **MENU/SELECT**.
4. Press **▼CID** or **▲DIR** to highlight **>On** or **>Off**, then press **MENU/SELECT** to save the setting.

### Call screening

---

Use this feature to choose whether incoming messages can be heard over the telephone base speaker when they are being recorded. If you turn call screening on, you hear the incoming message.

#### To change the setting:

1. When the handset is in idle mode, press **MENU/SELECT** to enter the main menu.
2. Press **▼CID** or **▲DIR** to scroll to **>Answering sys**, then press **MENU/SELECT**.
3. Press **▼CID** or **▲DIR** to scroll to **>Ans sys setup**, then press **MENU/SELECT**.
4. Press **MENU/SELECT** to select **>Call screening**.
5. Press **▼CID** or **▲DIR** to choose **>On** or **>Off**.
6. Press **MENU/SELECT** to save the setting.

## Answering system settings

### Number of rings

---

You can set the answering system to answer an incoming call after two, three, four, five, or six rings. You can also select toll saver, which is explained, as mentioned below. By default, the answering system answers an incoming call after four rings.

#### To set the number of rings:

1. When the handset is in idle mode, press **MENU/SELECT** to enter the main menu.
2. Press **▼CID** or **▲DIR** to scroll to **>Answering sys**, then press **MENU/SELECT**.
3. Press **▼CID** or **▲DIR** to scroll to **>Ans sys setup**, then press **MENU/SELECT**.
4. Press **▼CID** or **▲DIR** to scroll to **># of rings**, then press **MENU/SELECT**.
5. Press **▼CID** or **▲DIR** to scroll and choose among **2, 3, 4, 5, 6** or **Toll saver**.
  - Toll saver - the answering system answers a call after two rings when you have new messages, and after four rings when there are no new messages. This feature allows you to check for new messages and avoid paying long distance charges when calling from out of your local area.
6. Press **MENU/SELECT** to save the setting.

### Remote access code

---

To access your answering system remotely from any touch-tone phone, you need to enter a two-digit number (00-99). By default, the remote access code is 19.

#### To change the remote access code:

1. When the handset is in idle mode, press **MENU/SELECT** to enter the main menu.
2. Press **▼CID** or **▲DIR** to scroll to **>Answering sys**, then press **MENU/SELECT**.
3. Press **▼CID** or **▲DIR** to scroll to **>Ans sys setup**, then press **MENU/SELECT**.
4. Press **▼CID** or **▲DIR** to scroll to **>Remote code**, then press **MENU/SELECT**.
5. Use the dialing keys to enter a two-digit number. Use **MUTE/DELETE** to backspace and delete a digit.
6. Press **MENU/SELECT** to save the setting.

## Answering system settings

### Message alert tone

---

When the message alert tone is set to **On**, and there is at least one new message, the telephone base beeps every 10 seconds. By default, the message alert tone is set to off.

There is no audible alert at the handset.

#### To change the setting:

1. When the handset is in idle mode, press **MENU/SELECT** to enter the main menu.
2. Press **▼CID** or **▲DIR** to scroll to **>Answering sys**, then press **MENU/SELECT**.
3. Press **▼CID** or **▲DIR** to scroll to **>Ans sys setup**, then press **MENU/SELECT**.
4. Press **▼CID** or **▲DIR** to scroll to **>Msg alert tone**, then press **MENU/SELECT**.
5. Press **▼CID** or **▲DIR** to choose **>On** or **>Off**.
6. Press **MENU/SELECT** to save the setting.

### Message recording time

---

You can set the recording time allowed for incoming messages. The message length is three minutes by default.

#### To change the setting:

1. When the handset is in idle mode, press **MENU/SELECT** to enter the main menu.
2. Press **▼CID** or **▲DIR** to scroll to **>Answering sys**, then press **MENU/SELECT**.
3. Press **▼CID** or **▲DIR** to scroll to **>Ans sys setup**, then press **MENU/SELECT**.
4. Press **▼CID** or **▲DIR** to scroll to **>Recording time**, then press **MENU/SELECT**.
5. Press **▼CID** or **▲DIR** to choose **>3 minutes**, **>2 minutes**, or **>1 minute**, then press **MENU/SELECT** to save the setting.

## About the answering system

### Answering system and voicemail indicators

---

Your telephone has separate indicators for two different types of voice messages: those left on its built-in digital answering system and those left at your telephone service provider's voicemail (fees may apply). Your telephone's built-in digital answering system messages and voicemail messages are separate. Each alerts you to new messages differently.



- If **OO** and **XX New messages** show on the handset and the message window on the telephone base flashes, there are new messages in the built-in answering system. To listen to messages recorded on your digital answering system, press **▶/■/PLAY/STOP** on the telephone base (page 29).
- If **✉** and **New voicemail** display on the handset, your telephone service provider is indicating that it has new voicemail for you. To listen to your voicemail, dial an access number provided by your telephone service provider, followed by a security code or PIN.



Some telephone service providers bundle or combine multiple services like voicemail and call waiting, so you may not be aware that you have voicemail. To check what services you have and how to access them, contact your telephone service provider.

To use your voicemail service rather than the answering system, turn off the answering system. To use the answering system rather than your voicemail service, contact your telephone service provider to deactivate your voicemail service.



**NOTE:** After reviewing all new messages, the number of old messages appears on the message window.

### Using the answering system and voicemail together

---

You can also use your telephone answering system and voicemail together by setting your built-in answering system to answer before voicemail answers, as described below. To learn how to program your voicemail settings, contact your telephone service provider. Then, if you are on a call, or if the answering system is busy recording a message and you receive another call, the second caller can leave a voicemail message.

Set your answering system to answer calls at least two rings earlier than your voicemail is set to answer. For example, if your voicemail answers after six rings, set your answering system to answer after four rings. Some voicemail providers may program the delay before answering calls in seconds instead of rings. In this case, allow six seconds per ring when determining the appropriate setting.



## About the answering system

### Message capacity

---

The answering system can record up to 99 messages, depending on the length of each message. Individual messages can be up to three minutes, and the maximum recording time is approximately 14 minutes. The actual recording time depends on individual message characteristics. Messages remain available for replay until you delete them.

### Voice prompts

---

The system provides voice prompts to guide you through the setup procedures at the telephone base, message playback, remote access and recording outgoing announcements.

### Call screening at the telephone base

---

If the answering system and call screening are on, the announcement and the incoming message broadcast at the telephone base when a call is answered at the telephone base.

You can turn call screening on or off using the handset (see page 24). When call screening is off, you can temporarily turn on call screening by pressing **▲/VOL** on the telephone base. Call screening will be off for the next incoming call.

If call screening is on and you want to silence the telephone base while it is recording messages, press **▶/■/PLAY/STOP**.

### Call screening at the handset

---

If the answering system is on, you can hear the announcement and the incoming message with the handset when a call is answered by the answering system. While a message is being recorded, the handset shows **To screen call, press [SELECT]**. Press **MENU/SELECT** to screen the call.

### Call intercept

---

While screening a call, you can stop recording and speak to the caller by pressing **☎/PHONE/FLASH** on the handset.

### Temporarily turning off the message alert tone

---

If the new message alert tone is turned on, the telephone base beeps every 10 seconds when there are new or missed messages. Pressing any telephone base key (except **☎/HANDSET LOCATOR**) temporarily silences the message alert tone.

If you press **X/DELETE** in idle mode to temporarily turn off the message alert tone, there is a voice prompt directing you to press **X/DELETE** again to delete all old messages. The message alert tone is temporarily off. Only press **X/DELETE** a second time if you wish to erase all old messages.

The message alert tone resumes when you receive another message.

## Message playback

### To listen to messages at the telephone base:

Press ►/■/PLAY/STOP. Press ►/■/PLAY/STOP again to end the message playback.

### To listen to messages on a cordless handset:

1. Press **MENU/SELECT** when the handset is not in use.
2. Select **>Play messages**.
  - If there are new and old messages, select **>Play new msgs** or **>Play old msgs**.
  - If there are only new or only old messages, they will play automatically.

### Options during playback

---

#### When messages are playing on the telephone base:

- Press ▼/VOL/▲ to adjust the message playback volume.
- Press ►/SKIP to skip to the next message.
- Press ◀/REPEAT to repeat the message. Press twice to hear the previous message.
- Press X/DELETE to delete the message.
- Press ►/■/PLAY/STOP to stop playback.

#### When messages are playing on the handset:

- Press \PHONE/FLASH to stop playback. The screen shows **Call back?**, then press **MENU/SELECT**, \PHONE/FLASH, or ◀/SPEAKER to call back the caller if the caller's number is available. If the dialing format used is not correct, then use the following option to choose the correct dialing format before calling back the caller.
- Press **MENU/SELECT** to pause playback and show the caller ID information if available. From here, you can press ↗/OFF/CANCEL to resume playback, press # to show different dialing options (page 21), or press \PHONE/FLASH or ◀/SPEAKER to call back the caller. If you do not call back within 10 seconds, message playback resumes automatically.
- Press ▼CID/VOLUME or ▲DIR/VOLUME to adjust the message playback volume.
- Press **EQ**  to adjust the message playback audio quality.
- Press **6** to skip to the next message.
- Press **4** to repeat the message. Press twice to hear the previous message.
- Press **MUTE/DELETE** to delete the message.
- Press **5** to stop the playback.
- Press ◀/SPEAKER to switch between speakerphone mode and handset mode.

## Message playback

### Delete all old messages

---

#### To delete all old messages on the telephone base:

1. When the telephone is idle, press **X/DELETE**. The system announces, *"To delete all old messages, press delete again."*
2. Press **X/DELETE** again. The system announces, *"All old messages deleted."*

#### To delete all old messages on the handset:

1. Press **MENU/SELECT** when in idle mode to enter the main menu.
2. Press **▼CID** or **▲DIR** to scroll to **>Answering sys.** Press **MENU/SELECT**.
3. Press **▼CID** or **▲DIR** to highlight **Delete all old**, then press **MENU/SELECT**. The screen shows **Delete all old messages?**
4. Press **MENU/SELECT** again to confirm.

## Recording and playing memos

Memos are messages you record at a handset. You can play back and delete them like incoming messages.

### Record a memo

---

1. When the handset is in idle mode, press **MENU/SELECT** to enter the main menu.
2. Press **▼CID** or **▲DIR** to scroll to **>Answering sys.** Press **MENU/SELECT**.
3. Press **▼CID** or **▲DIR** to highlight **Record memo**, then press **MENU/SELECT**. The system announces, *"Record after the tone. Press 5 when you are done."* You can record a memo of up to four minutes.
4. Speak facing the handset to record a memo.
5. Press **5** to stop recording. The system announces, *"Recorded."* The system does not save memos shorter than two seconds.

### Play back a memo

---

Play memos the same way as messages. See **Message playback** on page 29.

## Remote access

You can reach your answering system remotely by dialing your home telephone number from any touch-tone telephone.

### To remotely reach your answering system:

1. Dial your telephone number from any touch-tone telephone.
2. When the system answers, enter the two-digit remote access code (**19** is the default code. See page 25 to change it).
  - The system automatically announces the number of new or old messages (if any), and then begins to play them.
3. You can also enter the following remote commands:

#### Remote commands

<b>1</b>	Press to listen to all messages.
<b>2</b>	Press to listen to new messages only.
<b>3</b>	Press to delete the current message (during playback).
<b>33</b>	Press twice to delete all old messages.
<b>4</b>	Press to repeat the current message (during playback).
<b>44</b>	Press twice to listen to the previous message.
<b>5</b>	Press to stop any operation (including recording).
<b>*5</b>	Press to listen to a list of remote commands.
<b>6</b>	Press to skip to the next message (during playback).
<b>*7</b>	Press to record a new announcement.
<b>8</b>	Press to end remote access (the call will be terminated).
<b>0</b>	Press to turn the answering system on or off.

4. Hang up or press **8** to end the call and save all messages that have not been deleted.

## Adding and registering handsets/headsets

Your telephone can support up to 12 DECT 6.0 cordless handsets (AT&T model CRL80112, sold separately) or up to 10 cordless handsets and 2 cordless headsets (sold separately). Visit [www.telephones.att.com/headsets](http://www.telephones.att.com/headsets) for a list of compatible DECT 6.0 cordless headsets. Each new handset or headset must be registered to the telephone base before use. You must register each handset or headset separately.

To register a cordless headset to this telephone system, please refer to the user's manual of the cordless headset for more details. To register a cordless handset, see below.

The handsets provided within your product box are already registered as **HANDSET 1**, and so forth. Additional handsets are assigned numbers in the sequential order they are registered (up to **HANDSET 12**).

### Register a handset to your telephone base

1. Before you begin registration, make sure the handset is out of the telephone base or charger and shows **To register HS, see manual..**
2. Put the handset you wish to register on the telephone base cradle.
3. The screen shows **Registering... Please wait** and the **IN USE** light turns on. It takes up to 90 seconds to complete registration. Then, **HANDSET X Registered** appears on the screen, with **HANDSET** being the handset name and **X** being the handset number (**1-12**). The handset beeps and the **IN USE** light turns off. The handset is now registered with the telephone base.

If registration fails, the system will automatically try to register again. If registration fails after the third try, **Registration failed** appears on the screen for a few seconds, and then **To register HS, see manual..** This may take up to five minutes to occur. Please start again from Step 1.



For registration, put the handset on the telephone base, not the handset charger.

## Deregistering handsets



You may need to deregister your handsets if:

- You have 12 registered handsets and need to replace a handset.
- OR-**
- You wish to change the designated handset number of your registered handsets.

You must first deregister ALL the handsets, and then register each handset you wish to use again, one at a time.

**Please read carefully through all the instructions on this page before beginning the deregistration process.**

### Deregister all handsets from your telephone base

1. Make sure that all handsets are out of the telephone base and chargers before you begin deregistration.
2. Press and hold  /**HANDSET LOCATOR** on the telephone base for about 10 seconds (until the **IN USE** light starts to flash), then release the  /**HANDSET LOCATOR** button.
3. Immediately press  /**HANDSET LOCATOR** while the **IN USE** light is still flashing. (The light flashes for about seven seconds. If the light stops flashing, start again with Step 1.)
4. It takes up to 10 seconds to complete the deregistration process. Before registering the handset again, wait for the cordless handset screen to display **To register HS, see manual..**
5. To register the handset(s) to the telephone base again, follow the registration instructions on the previous page.



#### **NOTES:**

- If the deregistration process is not successful, you might need to reset the system and try again. To reset, unplug the power from the telephone base and plug it back in.
- You cannot deregister the handset(s) if any other system handset is in use.
- Even if the battery is depleted, you can still deregister the handset by following the steps mentioned above. After the handset is charged for at least 10 minutes, the screen shows **To register HS, see manual..**

## Troubleshooting

If you have difficulty with your phone, please try the following suggestions. For customer service, visit our website at **www.telephones.att.com** or call **1 (800) 222-3111**. In Canada, dial **1 (866) 288-4268**.

For more detailed instructions, please refer to the online Complete user's manual at **www.telephones.att.com/manuals**.

### **My telephone doesn't work at all.**

- Make sure the power cord is securely plugged in.
- Make sure you plug the battery connector securely into the cordless handset.
- Make sure you plug the telephone line cord securely and firmly into the telephone base and the telephone wall jack.
- Charge the battery in the cordless handset for at least 10 hours. For optimum daily performance, return the cordless handset to the telephone base or charger when not in use.
- If the battery is depleted, it might take approximately 30 minutes to charge the handset before it shows **Low battery**. See page 4 for details.
- Reset the telephone base. Unplug the electrical power. Wait for approximately 15 seconds, then plug it back in. Allow up to one minute for the cordless handset and telephone base to reset.
- You may need to purchase a new battery. Please refer to **Battery installation and charging** in this user's manual on pages 4-5.

### **The display shows No line. I cannot get a dial tone.**

- Try all the suggestions, as mentioned above.
- If the previous suggestions do not work, disconnect the telephone line cord from your telephone and connect the telephone line cord to another telephone.
  - If there is no dial tone on that other telephone either, your telephone line cord may be defective. Install a new telephone line cord.
  - If changing the telephone line cord does not help, the wall jack (or the wiring to this wall jack) may be defective. Try using a different wall jack in your home to connect your CRL82112/CRL82212/CRL82312/CRL82352/CRL82412/CRL82452 telephone, or contact your telephone service provider (charges may apply).

### **I cannot dial out.**

- Try all the suggestions, as mentioned above.
- Make sure you have a dial tone before dialing. The cordless handset might take a second or two to find the telephone base and produce a dial tone. This is normal. Wait an extra second before dialing.
- Eliminate any background noise. Noise from a television, radio or other appliances might cause the phone to not dial out properly. If you cannot eliminate the background noise, first try muting the cordless handset before dialing, or dialing from another room with less background noise.
- If other phones in your home are having the same problem, contact your telephone service provider (charges might apply).

## **My cordless handset isn't performing normally.**

- Make sure you plug the power cord securely into the telephone base. Plug the power adapter into a different, working electrical outlet without a wall switch.
- Move the cordless handset closer to the telephone base. You might have moved out of range.
- Reset the telephone base. Unplug the electrical power. Wait for 15 seconds, then plug it back in. Allow up to one minute for the cordless handset and telephone base to reset.
- Other electronic products such as HAM radios and other DECT phones, can cause interference with your cordless phone. Try installing your phone as far away as possible from these types of electronic devices.

## **The batteries do not hold a charge.**

- Charge the battery in the cordless handset for at least 10 hours. For optimum daily performance, return the cordless handset to the telephone base or charger when not in use.
- If the battery is depleted, it might take approximately 30 minutes to charge the handset before it shows **Low battery**. Refer to the table on page 4 for details.
- You might need to purchase a new battery. Please refer to **Battery installation and charging** in this user's manual on pages 4-5.

## **I experience poor sound quality when using the speakerphone.**

- For increased sound quality while using the speakerphone, place the handset on a flat surface with the dial pad facing up.

## **I get noise, static, or weak signals even when I'm near the telephone base.**

- If you subscribe to high-speed Internet service (DSL - digital subscriber line) through your telephone line, you must install a DSL filter between the telephone line cord and the telephone wall jack (see page 3). The filter prevents noise and caller ID problems as a result of DSL interference. Please contact your DSL service provider for more information about DSL filters.
- You may be able to improve the performance of your cordless phone by installing your new telephone base as far as possible from any other existing cordless telephone system that may already be installed.
- Other electronic products such as HAM radios and other DECT phones, can cause interference with your cordless phone. Try installing your phone as far away as possible from these types of electronic devices.
- Do not install this phone near a microwave oven or on the same electrical outlet. You might experience decreased performance while the microwave oven is operating.
- If you plug your phone in with a modem or a surge protector, plug the phone (or modem/surge protector) into a different location. If this does not solve the problem, relocate your phone or modem farther apart from one another, or use a different surge protector.
- Move your phone to a higher location. The phone might have better reception in a high area.
- If other phones in your home are having the same problem, contact your telephone service provider (charges may apply).



## Troubleshooting

### **My caller ID isn't working.**

- Caller ID is a subscription service. You must subscribe to this service from your telephone service provider for this feature to work on your phone.
- The caller may not be calling from an area which supports caller ID.
- Both your and your caller's telephone service providers must use caller ID compatible equipment.
- If you subscribe to high-speed Internet service (DSL - digital subscriber line) through your telephone line, you must install a DSL filter between the telephone line cord and the telephone wall jack (page 3). The filter prevents noise and caller ID problems resulting from DSL interference. Please contact your DSL service provider for more information about DSL filters.

### **System does not receive caller ID when on a call.**

- Make sure you subscribe to caller ID with call waiting features from your telephone service provider. Caller ID features works only if both you and the caller are in areas offering caller ID service, and if both telephone service providers use compatible equipment.

### **System does not answer after the correct number of rings.**

- Make sure that the answering system is on. **ANS ON** should show on the handset and the **📞/ANSWER ON** light on the telephone base should be on.
- If toll saver is activated, the number of rings changes to two when you have new messages stored (page 25).
- If the memory is full or the system is off, the system will answer after 10 rings.
- In some cases, the answering system is affected by the ringing system used by your telephone service provider.
- If you subscribe to voicemail service, change the number of rings so that your answering system answers before your voicemail (page 25). To determine how many rings activate your voicemail, contact your telephone service provider.
- If there is a fax machine connected to the same telephone line, try disconnecting the fax machine. If that solves the problem, consult your fax machine documentation for information on compatibility with answering systems.

### **I've set my LCD language to Spanish or French and I don't know how to change it back to English.**

- Press **MENU/SELECT** in idle mode, then enter **364#**. You hear a confirmation tone.

### **I cannot retrieve voicemail messages.**

- Your telephone has both a built-in answering system and voicemail indicator. They are independent features and each alerts you to new messages differently (page 27). If you subscribe to voicemail service from your telephone service provider, contact your telephone service provider for more information on how to access your voicemail.

## Maintenance

### Taking care of your telephone

- Your cordless telephone contains sophisticated electronic parts, so you must treat it with care.
- Avoid rough treatment.
- Place the handset down gently.
- Save the original packing materials to protect your telephone if you ever need to ship it.

### Avoid water

- You can damage your telephone if it gets wet. Do not use the handset in the rain, or handle it with wet hands. Do not install the telephone base near a sink, bathtub or shower.

### Electrical storms

- Electrical storms can sometimes cause power surges harmful to electronic equipment. For your own safety, take caution when using electric appliances during storms.

### Cleaning your telephone

- Your telephone has a durable plastic casing that should retain its luster for many years. Clean it only with a soft cloth slightly dampened with water or mild soap.
- Do not use excess water or cleaning solvents of any kind.

Remember that electrical appliances can cause serious injury if used when you are wet or standing in water. If the telephone base should fall into water, DO NOT RETRIEVE IT UNTIL YOU UNPLUG THE POWER CORD AND TELEPHONE LINE CORDS FROM THE WALL. Pull the unit out by the unplugged cords.

## Important safety information



This symbol is to alert you to important operating or servicing instructions that may appear in this user's manual. Always follow basic safety precautions when using this product to reduce the risk of injury, fire, or electric shock.

### Safety information

- Read and understand all instructions in the user's manual. Observe all markings on the product.
- Avoid using a telephone during a thunderstorm. There may be a slight chance of electric shock from lightning.
- Do not use a telephone in the vicinity of a gas leak. Under certain circumstances, a spark may be created when the adapter is plugged into the power outlet, or when the handset is replaced in its cradle. This is a common event associated with the closing of any electrical circuit. The user should not plug the phone into a power outlet, and should not put a charged handset into the cradle, if the phone is located in an environment containing concentrations of flammable or flame-supporting gases, unless there is adequate ventilation. A spark in such an environment could create a fire or explosion. Such environments might include: medical use of oxygen without adequate ventilation; industrial gases (cleaning solvents; gasoline vapors; etc.); a leak of natural gas; etc.
- Do not use this product near water, or when you are wet. For example, do not use it in a wet basement or shower, or next to a swimming pool, bathtub, kitchen sink, or laundry tub. Do not use liquids or aerosol sprays for cleaning. If the product comes in contact with any liquid, unplug any line or power cord immediately. Do not plug the product back in until it has dried thoroughly.
- Install this product in a protected location where no one can trip over any line or power cords. Protect cords from damage or abrasion.
- If this product does not operate normally, see the **Troubleshooting** section on pages 34-36 of this user's manual. If you cannot solve the problem, or if the product is damaged, refer to the **Limited warranty** section on pages 46-47. Do not open this product except as directed in your user's manual. Opening the product or reassembling it incorrectly may expose you to hazardous voltages or other risks.
- Replace batteries only as described on pages 4-5 in this user's manual. Do not burn or puncture batteries — they contain caustic chemicals.
- The power adapters are intended to be correctly oriented in a vertical or floor mount position. The prongs are not designed to hold the plug in place if it is plugged into a ceiling or an under-the-table/cabinet outlet.



### CAUTIONS:

- Use only the power adapters provided with this product. To obtain a replacement, visit our website at **[www.telephones.att.com](http://www.telephones.att.com)** or call **1 (800) 222-3111**. In Canada, dial **1 (866) 288-4268**.
- Use only the supplied rechargeable battery or replacement battery (model BT183342/ BT283342). To order, visit our website at **[www.telephones.att.com](http://www.telephones.att.com)** or call **1 (800) 222-3111**. In Canada, dial **1 (866) 288-4268**.
- To prevent risk of fire or battery explosion, replace with the correct battery type. Dispose of used batteries according to the instructions.

## Important safety information

### Especially about cordless telephones

---

- **Privacy:** The same features that make a cordless telephone convenient create some limitations. Telephone calls are transmitted between the telephone base and the handset by radio waves, so there is a possibility that your cordless telephone conversations could be intercepted by radio receiving equipment within range of the cordless handset. For this reason, you should not think of cordless telephone conversations as being as private as those on corded telephones.
- **Electrical power:** The telephone base of this cordless telephone must be connected to a working electrical outlet which is not controlled by a wall switch. Calls cannot be made from the handset if the telephone base is unplugged, switched off or if the electrical power is interrupted.
- **Potential TV interference:** Some cordless telephones operate at frequencies that may cause interference to TVs and VCRs. To minimize or prevent such interference, do not place the telephone base of the cordless telephone near or on top of a TV or VCR. If interference is experienced, moving the cordless telephone farther away from the TV or VCR will often reduce or eliminate the interference.
- **Rechargeable batteries:** This product contains nickel-metal hydride rechargeable batteries. Exercise care in handling batteries in order not to create a short circuit with conductive material such as rings, bracelets and keys. The battery or conductor may overheat and cause harm. Observe proper polarity between the battery and the battery charger.
- **Nickel-metal hydride rechargeable batteries:** Dispose of these batteries in a safe manner. Do not burn or puncture. Like other batteries of this type, if burned or punctured, they could release caustic material which could cause injury.



The RBRC<sup>®</sup> Seal means that the manufacturer is voluntarily participating in an industry program to collect and recycle nickel-metal hydride rechargeable batteries when taken out of service within the United States. These batteries may be taken to a participating local retailer of replacement batteries or recycling center. Or you may call 1-800-8-BATTERY<sup>®</sup> for locations accepting spent Ni-MH batteries.

RBRC<sup>®</sup> and 1-800-8-BATTERY<sup>®</sup> are registered trademarks of the Rechargeable Battery Recycling Corporation.

### Precautions for users of implanted cardiac pacemakers

---

Cardiac pacemakers (applies only to digital cordless telephones):

Wireless Technology Research, LLC (WTR), an independent research entity, led a multidisciplinary evaluation of the interference between portable wireless telephones and implanted cardiac pacemakers. Supported by the U.S. Food and Drug Administration, WTR recommends to physicians that:

#### Pacemaker patients

---

Should keep wireless telephones at least six inches from the pacemaker.

Should NOT place wireless telephones directly over the pacemaker, such as in a breast pocket, when it is turned ON.

Should use the wireless telephone at the ear opposite the pacemaker.

WTR's evaluation did not identify any risk to bystanders with pacemakers from other persons using wireless telephones.

### Especially about telephone answering systems

---

**Two-way recording:** This unit does not sound warning beeps to inform the other party that the call is being recorded. To ensure that you are in compliance with any federal or state regulations regarding recording a telephone call, you should start the recording process and then inform the other party that you are recording the conversation.

## SAVE THESE INSTRUCTIONS

## For C-UL compliance

In compliance with the bilingual requirements for safety, caution, and warning markings of Canadian Federal and Provincial/Territorial statutes and regulations, the French version of Important safety information is included.

### Mesures de sécurité importantes

---



Ce symbole vous alertera d'informations importantes ou d'instructions d'entretien pouvant apparaître dans ce guide d'utilisation. Respectez toujours les mesures de sécurité et de sécurité de base lorsque vous utilisez ce produit, afin de réduire les risques de blessures, d'incendie, ou d'électrocution.

### Information relative à la sécurité

---

- Veuillez lire et comprendre toutes les instructions de ce guide d'utilisation. Relectez toutes les inscriptions apparaissant sur le produit.
- Évitez d'utiliser le téléphone pendant un orage. Il pourrait y avoir un faible risque d'électrocution.
- N'utilisez pas un téléphone près d'une fuite de gaz. Dans certaines circonstances, une flammèche pourrait se produire lorsque l'adaptateur est branché à une prise de courant, ou lorsque le combiné est déposé sur son chargeur. Ceci est un événement fréquent associé avec la fermeture d'un circuit électrique. L'utilisateur ne devrait pas brancher un téléphone dans une prise de courant, et ne devrait pas déposer un combiné chargé dans le chargeur, si le téléphone se trouve dans un environnement comportant une concentration de gaz inflammables ou ignifuges, à moins de se trouver dans un endroit où la ventilation est adéquate. Une flammèche dans de tels environnements pourrait provoquer une explosion. De tels environnements peuvent comprendre : les endroits où de l'oxygène à des fins médicales est utilisé sans ventilation adéquate; des endroits où se trouvent des gaz industriels (dissolvants de nettoyage, des vapeurs de gazoline, etc.), une fuite de gaz naturel, etc.
- N'utilisez pas ce produit près de l'eau ou lorsque vous êtes mouillés. Par exemple, ne l'utilisez pas dans des sous-sols humides ou sous la douche, ou près d'une piscine, d'un bain, d'un évier de cuisine, ou d'une cuve de lavage. N'utilisez pas de liquides, ou de vaporisateurs aérosol de nettoyage. Si le produit entre en contact avec du liquide, débranchez immédiatement le fil téléphonique ou le cordon d'alimentation. Ne rebranchez pas le produit avant qu'il soit complètement sec.
- Installez cet appareil dans un endroit protégé où personne ne peut trébucher sur les cordons d'alimentation ou la ligne téléphonique. Protégez les câbles contre les dommages ou l'abrasion.
- Si le produit ne fonctionne pas correctement, consultez la section **Dépannage (Troubleshooting)** des pages 34-36 de ce guide d'utilisation. Si vous ne pouvez pas régler le problème, ou si le produit est endommagé, consultez la section **Garantie limitée (Limited warranty)** des pages 46-47. N'ouvrez pas ce produit, sauf tel qu'indiqué dans le guide d'utilisation. L'ouverture du produit ou le remontage inadéquat pourrait vous exposer à des tensions dangereuses ou autres dangers.
- Remplacez les piles uniquement tel que décrit dans votre guide d'utilisation (pages 4-5). N'incinerez pas et ne percez pas les piles — elles contiennent des produits chimiques caustiques.
- Les adaptateurs secteurs sont conçus pour être orientés verticalement ou installés sur le plancher. Les broches ne sont pas conçues pour se maintenir en place si la fiche est branchée dans une prise de courant au plafond, sous la table ou sous une armoire.

## Appendix For C-UL compliance



### MISES EN GARDE:

- N'utilisez que les adaptateurs inclus avec ce produit. Pour obtenir une pièce de rechange, visitez notre site Web au **www.telephones.att.com** ou composez le **1-800-222-3111**. Au Canada, composez le **1-866-288-4268**.
- N'utilisez que la pile de rechargeable incluse ou une pile de rechange (modèle BT183342/ BT283342). Pour commander, visitez notre site Web **www.telephones.att.com** ou composez le **1-800-222-3111**. Au Canada, composez le **1-866-288-4268**.
- Afin de prévenir les risques d'incendie ou d'explosion de la pile, remplacez la pile avec une pile du même type. Jetez les piles épuisées en respectant les instructions.

### Especially about cordless telephones

---

- Confidentialité : Les mêmes caractéristiques qui rendent les téléphones sans fil si pratiques créent également des restrictions. Les appels téléphoniques sont transmis entre le socle du téléphone et le combiné par le biais d'ondes radio, et il se peut que vos conversations téléphoniques soient interceptées par d'autres équipements de réception d'ondes radio au sein de la portée du téléphone sans fil. Pour cette raison, vous ne devez pas considérer les conversations sur un téléphone sans fil comme étant aussi confidentielles que celles d'un téléphone à cordon.
- Alimentation électrique : La base de ce téléphone sans fil doit être branchée à une prise de courant électrique fonctionnelle. La prise électrique ne doit pas être contrôlée par un interrupteur mural. Les appels ne peuvent pas être effectués à partir du combiné si la base n'est pas branchée, si elle est hors fonction ou si le courant électrique est coupé.
- Interférences potentielles aux téléviseurs : Certains téléphones sans fil fonctionnent sur des fréquences pouvant causer des interférences aux téléviseurs et magnétoscopes. Pour réduire ou prévenir de tels parasites, ne pas déposer la base du téléphone sans fil à proximité d'un téléviseur ou magnétoscope, ni directement sur celui-ci. Si votre téléviseur affiche des interférences, éloignez le téléphone sans fil de celui-ci afin de réduire les parasites.
- Piles rechargeables : Ce produit comporte des piles rechargeables à l'hydrure métallique de nickel. Utilisez de prudence lorsque vous manipulez de telles piles et veillez à ne pas les court-circuiter avec des matériaux conducteurs, tels que des bagues, bracelets et clés. La pile ou le conducteur peut surchauffer et vous brûler. Respectez la polarité adéquate entre les piles et le chargeur de piles.
- Piles rechargeables à l'hydrure métallique de nickel : Jetez ces piles de manière sécuritaire. N'incinerez pas et ne percez pas les piles. Comme pour les autres piles du même type, si elles sont brûlées ou percées, des matières corrosives peuvent s'en échapper, ce qui risque de causer des brûlures ou autres blessures corporelles.



Le sceau de l'organisme de recyclage RBRC<sup>MD</sup> sur les piles à l'hydrure métallique de nickel signifie que le fabricant de cet appareil participe volontairement au programme industriel visant à reprendre et recycler ce type de piles lorsqu'elles ne servent plus, au sein du territoire des États-Unis et du Canada. Vous devez apporter ces piles chez un détaillant participant ou le centre de recyclage le plus près de chez vous. Ou vous pouvez composer le 1-800-8-BATTERY<sup>MD</sup> afin de connaître les endroits qui acceptent les piles à l'hydrure métallique de nickel mortes.

RBRC<sup>MD</sup> et 1-800-8-BATTERY<sup>MD</sup> sont des marques déposées de Rechargeable Battery Recycling Corporation.

## For C-UL compliance

### **Mesures préventives pour les utilisateurs de stimulateurs cardiaques implantés dans l'organisme**

---

Stimulateurs cardiaques (ne s'applique qu'aux téléphones sans fil numériques) :

L'organisme 'Wireless Technology Research, LLC (WTR)', une firme de recherche indépendante, a mené une évaluation pluridisciplinaire des interférences entre les téléphones sans fil portatifs et les stimulateurs cardiaques implantés dans l'organisme. Appuyée par l'Administration des aliments et drogues (FDA) des États-unis, la firme WTR recommande aux médecins :

#### **Avis aux détenteurs de stimulateurs cardiaques**

---

Ils doivent tenir le téléphone sans fil à une distance d'au moins six pouces du stimulateur cardiaque.

Ils ne doivent PAS placer le téléphone sans fil directement sur le stimulateur cardiaque, tel que dans une poche de chemise, lorsque celui-ci est en fonction.

Ils doivent utiliser le téléphone sans fil en l'appuyant sur l'oreille qui se trouve dans la direction opposée au stimulateur cardiaque.

L'étude effectuée par l'organisme WRS n'a pas identifié de risque pour les détenteurs de simulateurs cardiaques causé par les gens qui utilisent un téléphone sans fil à proximité de ceux-ci.

#### **Spécifiquement en rapport avec les répondeurs téléphoniques**

---

Enregistrement deux voies : Cet appareil n'émet pas de bips d'avertissement qui permettent de prévenir l'autre partie que vous enregistrez la conversation. Pour assurer votre conformité aux règlements fédéraux ou provinciaux en rapport avec les enregistrements des conversations téléphoniques, vous devriez informer l'autre partie lorsque vous activez l'enregistrement.

## **CONSERVEZ CES INSTRUCTIONS**

## Appendix FCC Part 68 and ACTA

This equipment complies with Part 68 of the FCC rules and with technical requirements adopted by the Administrative Council for Terminal Attachments (ACTA). The label on the back or bottom of this equipment contains, among other things, a product identifier in the format US:AAAEQ##TXXXX. This identifier must be provided to your telephone service provider upon request.

The plug and jack used to connect this equipment to premises wiring and the telephone network must comply with the applicable Part 68 rules and technical requirements adopted by ACTA. A compliant telephone cord and modular plug is provided with this product. It is designed to be connected to a compatible modular jack that is also compliant. An RJ11 jack should normally be used for connecting to a single line and an RJ14 jack for two lines. See the installation instructions in the user's manual.

The Ringer Equivalence Number (REN) is used to determine how many devices you may connect to your telephone line and still have them ring when you are called. The REN for this product is encoded as the 6th and 7th characters following the US: in the product identifier (e.g., if ## is 03, the REN is 0.3). In most, but not all areas, the sum of all RENs should be five (5.0) or less. For more information, please contact your telephone service provider.

This equipment may not be used with Party Lines. If you have specially wired alarm dialing equipment connected to your telephone line, ensure the connection of this equipment does not disable your alarm equipment. If you have questions about what will disable the alarm equipment, consult your telephone service provider or a qualified installer.

If this equipment is malfunctioning, it must be unplugged from the modular jack until the problem has been corrected. Repairs to this telephone equipment can only be made by the manufacturer or its authorized agents. For repair procedures, follow the instructions outlined under the Limited warranty.

If this equipment is causing harm to the telephone network, the telephone service provider may temporarily discontinue your telephone service. The telephone service provider is required to notify you before interrupting service. If advance notice is not practical, you will be notified as soon as possible. You will be given the opportunity to correct the problem and the telephone service provider is required to inform you of your right to file a complaint with the FCC. Your telephone service provider may make changes in its facilities, equipment, operation, or procedures that could affect the proper functioning of this product. The telephone service provider is required to notify you if such changes are planned.

If this product is equipped with a corded or cordless handset, it is hearing aid compatible.

If this product has memory dialing locations, you may choose to store emergency telephone numbers (e.g., police, fire, medical) in these locations. If you do store or test emergency numbers, please:

Remain on the line and briefly explain the reason for the call before hanging up.

Perform such activities in off-peak hours, such as early morning or late evening.



## FCC Part 68 and ACTA

### **Industry Canada**

This device complies with Industry Canada licence-exempt RSS standard(s).

Operation is subject to the following two conditions: (1) this device may not cause harmful interference, and (2) this device must accept any interference received, including interference that may cause undesired operation.

Privacy of communications may not be ensured when using this telephone.

The term "IC:" before the certification/registration number only signifies that the Industry Canada technical specifications were met.

The Ringer Equivalence Number (REN) for this terminal equipment is 1.0. The REN is an indication of the maximum number of devices allowed to be connected to a telephone interface. The termination on an interface may consist of any combination of devices subject only to the requirement that the sum of the RENs of all the devices does not exceed five.

This product meets the applicable Industry Canada technical specifications.

## Appendix FCC Part 15

This equipment has been tested and found to comply with the requirements for a Class B digital device under Part 15 of the Federal Communications Commission (FCC) rules. These requirements are intended to provide reasonable protection against harmful interference in a residential installation. This equipment generates, uses and can radiate radio frequency energy and, if not installed and used in accordance with the instructions, may cause harmful interference to radio communications. However, there is no guarantee that interference will not occur in a particular installation. If this equipment does cause harmful interference to radio or television reception, which can be determined by turning the equipment off and on, the user is encouraged to try to correct the interference by one or more of the following measures:

- Reorient or relocate the receiving antenna.
- Increase the separation between the equipment and receiver.
- Connect the equipment into an outlet on a circuit different from that to which the receiver is connected.
- Consult the dealer or an experienced radio/TV technician for help.

Changes or modifications to this equipment not expressly approved by the party responsible for compliance could void the user's authority to operate the equipment.

This device complies with Part 15 of the FCC Rules. Operation is subject to the following two conditions: (1) this device may not cause harmful interference, and (2) this device must accept any interference received, including interference that may cause undesired operation. Privacy of communications may not be ensured when using this telephone.

To ensure safety of users, the FCC has established criteria for the amount of radio frequency energy that can be safely absorbed by a user or bystander according to the intended usage of the product. This product has been tested and found to comply with the FCC criteria. The handset may be safely held against the ear of the user. The telephone base shall be installed and used such that parts of the user's body other than the hands are maintained at a distance of approximately 20 cm (8 inches) or more.

This Class B digital apparatus complies with Canadian requirement:  
CAN ICES-3 (B)/NMB-3(B).

## Appendix Limited warranty

The AT&T brand is used under license - any repair, replacement or warranty service, and all questions about this product should be directed to our website at **[www.telephones.att.com](http://www.telephones.att.com)** or call **1 (800) 222-3111**. In Canada, dial **1 (866) 288-4268**.

For more detailed instructions, refer to the online Complete user's manual at **[www.telephones.att.com/manuals](http://www.telephones.att.com/manuals)**.

### 1. What does this limited warranty cover?

The manufacturer of this AT&T branded product warrants to the holder of a valid proof of purchase ("CONSUMER" or "you") that the product and all accessories provided in the sales package ("PRODUCT") are free from defects in material and workmanship, pursuant to the following terms and conditions, when installed and used normally and in accordance with the PRODUCT operating instructions. This limited warranty extends only to the CONSUMER for products purchased and used in the United States of America and Canada.

### 2. What will be done if the PRODUCT is not free from defects in materials and workmanship during the limited warranty period ("materially defective PRODUCT")?

During the limited warranty period, the manufacturer's authorized service representative will repair or replace at the manufacturer's option, without charge, a materially defective PRODUCT. If the manufacturer repairs the PRODUCT, they may use new or refurbished replacement parts. If the manufacturer chooses to replace the PRODUCT, they may replace it with a new or refurbished PRODUCT of the same or similar design. The manufacturer will retain defective parts, modules, or equipment. Repair or replacement of the PRODUCT, at the manufacturer's option, is your exclusive remedy. The manufacturer will return repaired or replacement products to you in working condition. You should expect the repair or replacement to take approximately 30 days.

### 3. How long is the limited warranty period?

The limited warranty period for the PRODUCT extends for ONE (1) YEAR from the date of purchase. If the manufacturer repairs or replaces a materially defective PRODUCT under the terms of this limited warranty, this limited warranty also applies to repaired or replacement PRODUCT for a period of either (a) 90 days from the date the repaired or replacement PRODUCT is shipped to you or (b) the time remaining on the original one-year limited warranty; whichever is longer.

### 4. What is not covered by this limited warranty?

This limited warranty does not cover:

- PRODUCT that has been subjected to misuse, accident, shipping or other physical damage, improper installation, abnormal operation or handling, neglect, inundation, fire, water, or other liquid intrusion; or
- PRODUCT that has been damaged due to repair, alteration, or modification by anyone other than an authorized service representative of the manufacturer; or
- PRODUCT to the extent that the problem experienced is caused by signal conditions, network reliability or cable or antenna systems; or
- PRODUCT to the extent that the problem is caused by use with non-AT&T accessories; or
- PRODUCT whose warranty/quality stickers, PRODUCT serial number plates or electronic serial numbers have been removed, altered or rendered illegible; or
- PRODUCT purchased, used, serviced, or shipped for repair from outside the United States of America or Canada, or used for commercial or institutional purposes (including but not limited to products used for rental purposes); or
- PRODUCT returned without valid proof of purchase (see item 6); or
- Charges for installation or setup, adjustment of customer controls, and installation or repair of systems outside the unit.

## Limited warranty

### 5. How do you get warranty service?

To obtain warranty service, visit our website at **[www.telephones.att.com](http://www.telephones.att.com)** or call **1 (800) 222-3111**. In Canada, dial **1 (866) 288-4268**.

For more detailed instructions, refer to the online Complete user's manual at

**[www.telephones.att.com/manuals](http://www.telephones.att.com/manuals)**.

NOTE: Before calling for service, please review the user's manual; a check of the PRODUCT's controls and features may save you a service call.

Except as provided by applicable law, you assume the risk of loss or damage during transit and transportation and are responsible for delivery or handling charges incurred in the transport of the PRODUCT(s) to the service location. The manufacturer will return repaired or replaced PRODUCT under this limited warranty to you. Transportation, delivery or handling charges are prepaid. The manufacturer assumes no risk for damage or loss of the PRODUCT in transit. If the PRODUCT failure is not covered by this limited warranty, or proof of purchase does not meet the terms of this limited warranty, the manufacturer will notify you and will request that you authorize the cost of repair prior to any further repair activity. You must pay for the cost of repair and return shipping costs for the repair of products that are not covered by this limited warranty.

### 6. What must you return with the PRODUCT to get warranty service?

You must:

- Return the entire original package and contents including the PRODUCT to the service location along with a description of the malfunction or difficulty; and
- Include a "valid proof of purchase" (sales receipt) identifying the PRODUCT purchased (PRODUCT model) and the date of purchase or receipt; and
- Provide your name, complete and correct mailing address, and telephone number.

### 7. Other limitations

This warranty is the complete and exclusive agreement between you and the manufacturer of this AT&T branded PRODUCT. It supersedes all other written or oral communications related to this PRODUCT. The manufacturer provides no other warranties for this PRODUCT. The warranty exclusively describes all of the manufacturer's responsibilities regarding the PRODUCT. There are no other express warranties. No one is authorized to make modifications to this limited warranty and you should not rely on any such modification.

State/Provincial Law rights: This warranty gives you specific legal rights, and you may also have other rights which vary from state to state or province to province.

Limitations: Implied warranties, including those of fitness for a particular purpose and merchantability (an unwritten warranty that the PRODUCT is fit for ordinary use) are limited to one year from date of purchase. Some states/provinces do not allow limitations on how long an implied warranty lasts, so the above limitation may not apply to you. In no event shall the manufacturer be liable for any indirect, special, incidental, consequential, or similar damages (including, but not limited to lost profits or revenue, inability to use the PRODUCT or other associated equipment, the cost of substitute equipment, and claims by third parties) resulting from the use of this PRODUCT. Some states/provinces do not allow the exclusion or limitation of incidental or consequential damages, so the above limitation or exclusion may not apply to you.

**Please retain your original sales receipt as proof of purchase.**

Appendix  
Technical specifications

Operation	Operating time*
Talk time (cordless handset)	Up to 7 hours
Talk time (cordless handset speakerphone)	Up to 5 hours
Standby	Up to 7 days

\* Operating times vary depending on your actual use and the age of the battery.

**DECT 6.0 digital technology**

---

The AT&T DECT 6.0 products offer unsurpassed range performance and sound clarity. This is achieved through a unique antenna design and advances in noise-filtering technology. An independent laboratory has confirmed that AT&T DECT 6.0 products perform up to 45% better in range competitions against similarly equipped phones of the leading competition. Now, calls can be taken in the basement, backyard and garage with exceptional sound quality.

**Telephone operating range**

---

This cordless telephone operates within the maximum power allowed by the Federal Communications Commission (FCC). Even so, this handset and telephone base can communicate over a certain distance — which can vary with the locations of the telephone base and handset, the weather, and the construction of your home or office.

**Redefining long range coverage and clarity**

---

This telephone base comes with an antenna which gives much better clarity and covers a longer range than before.

**HD audio**

---

HD audio improves sound quality by expanding and rebuilding frequencies that are lost with traditional phone calls. There is no additional telephone service requirement to use HD audio. It is designed to work with standard telephone service. Your system will automatically enhance all received sound with HD audio.



Telephones identified with this logo have reduced noise and interference when used with most T-coil equipped hearing aids and cochlear implants. The TIA-1083 Compliant Logo is a trademark of the Telecommunications Industry Association. Used under license.

---

**A**

---

Answering calls, 13  
Answering system, 23–31  
Assign a speed dial entry, 20  
Audio Assist®, 15

---

**B**

---

Battery charging, 4-5  
Battery installation, 4-5  
Blind transfer, 15

---

**C**

---

Call transfer using intercom,  
17  
Call waiting, 14  
Caller ID (CID),  
Add entries to phone directory, 22  
Dial entries, 21  
Save entries, 22  
Chain dialing, 15  
Charger installation, 3  
Clock, 8

---

**D**

---

Day and time, 8  
Deregistering handset, 33  
Dialing,  
From a record in the caller ID  
history, 21  
Directory,  
Delete, 19  
Edit, 19  
New entries, 18  
Review, 19  
Search by name, 19  
DSL, 3

---

**E**

---

Ending calls, 13  
Equalizer, 13

---

**H**

---

Handset,  
Handset locator, 14  
Quick reference guide, 1, 2  
Ringer tone, 7  
Speakerphone, 13  
HD audio, 48

---

**I**

---

Important safety information, 38–39  
Intercom, 16–17

---

**L**

---

Language reset, 8, 36  
LCD language, 8  
Reset to English, 8, 36  
Limited warranty, 46–47

---

**M**

---

Maintenance, 37  
Making calls, 13  
Memos, 30  
Message,  
Alert tone, 26  
Playback, 29

---

**N**

---

Names,  
Enter into directory, 18  
Search for, 19

---

**O**

---

Outgoing announcement, 23

---

**P**

---

Paging tone, 14  
Power adapter, 3

## Q

---

Quick reference guide, 1–2  
QUIET mode, 12

## R

---

Receiving calls, 13  
Recharging, 5  
Registering handset, 32  
Remote access, 31  
Ringer silencing, 13  
Ring tone options, 7

## S

---

Safety information, 38–39  
Speakerphone, 13  
Speed dial, 20  
    Assign number, 20  
    Make a call, 20  
    Set voicemail number, 9

## T

---

Technical specifications, 48  
Telephone operating range, 48  
Time, setting, 8  
Troubleshooting, 34–36

## V

---

Visual message waiting indicator, 10  
Voicemail, 9–10, 27  
    Quick access, 9, 20  
Voice prompts, 28  
Volume control,  
    Base, 29  
    Handset, 7

## W

---

Wall-mount installation, 6  
Warranty, 46–47



**For more detailed instructions, refer to the Complete user's manual at [www.telephones.att.com/manuals](http://www.telephones.att.com/manuals).**

**For customer service or product information, please visit our website at [www.telephones.att.com](http://www.telephones.att.com), or call 1 (800) 222-3111. In Canada, dial 1 (866) 288-4268.**

Audio Assist<sup>®</sup> is a registered trademark of Advanced American Telephones.

© 2012-2015 Advanced American Telephones. All Rights Reserved.  
AT&T and the AT&T logo are trademarks of AT&T Intellectual Property licensed to  
Advanced American Telephones, San Antonio, TX 78219.  
RBRC<sup>®</sup> and 1-800-8-BATTERY<sup>®</sup> are registered trademarks of the  
Rechargeable Battery Recycling Corporation.  
Printed in China. Issue 4.0 AT&T 03/15.