



Quick start guide

5.8 GHz Cordless Telephone/Answering System E5917/E5938B/ E5939B

with Caller ID/Call Waiting



Installation and setup

After battery installation, place each handset in the telephone base or a charger and allow it to charge for sixteen hours before use. You can keep the battery packs charged by returning the handsets to the telephone base or chargers after each use. When the battery is fully depleted, a recharge takes about sixteen hours. The average talk time on a fully charged battery is about eight hours depending on environmental conditions, and the standby time is approximately four days.

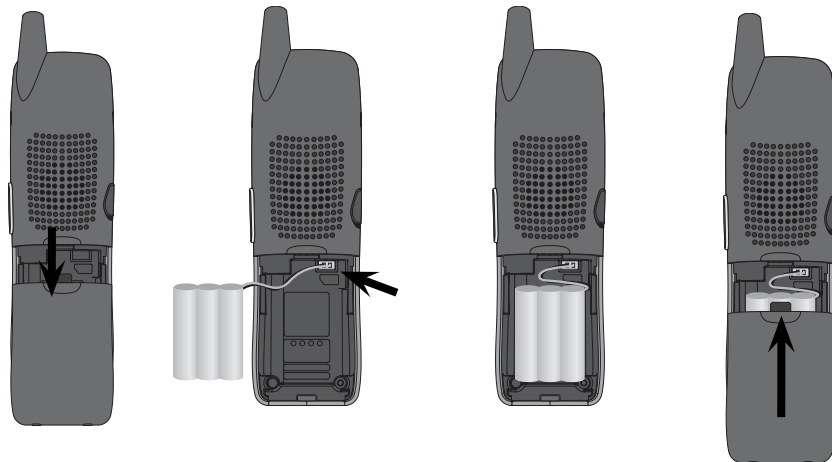

Press in and downward on the tab to open the battery compartment cover.

Plug the battery pack connector into handset.

Place the battery pack and wires in the compartment.

Slide battery compartment cover up until it clicks closed.

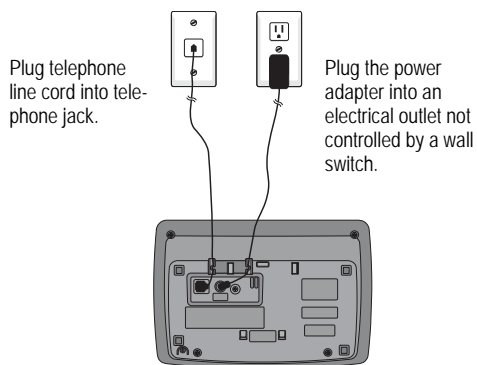

Plug telephone line cord into telephone jack.

Plug the power adapter into an electrical outlet not controlled by a wall switch.



Place handset in base or charger to charge for sixteen hours before first use.



Caution: Use only the supplied rechargeable battery or replacement battery pack (part number 80-5848-00-00).



NOTE: Use only the power adapter supplied with this product. If you need a replacement, call 1 (800) 222-3111. In Canada, call 1 (866) 288-4268. Be sure to use an electrical outlet not controlled by a wall switch.

Quick reference guide

Cordless handset

CID

Press to scroll down while in menus.
Press to display caller ID information.
While entering names or numbers, press to move the cursor to the left.

PHONE FLASH

Press to make or answer a call.
During a call, press to receive an incoming call if call waiting is activated.

MUTE DELETE

While on a call, press to mute microphone.
While reviewing the call log, press to delete an individual entry, or press and hold to clear the caller ID log.
While pre-dialing, press to delete digits from a string.

SPEAKER

Press to activate handset speakerphone.
Press again to resume normal handset use.

SELECT MENU

Press to display menu, or to select a highlighted item from menu or save an entry.

DIR

Press to scroll up while in menus.
Press to display directory entries. While entering names, press to move the cursor to the right.

OFF CLEAR

During a call, press to hang up.
While using menus, press to cancel an operation, return to the previous menu, or exit the menu display.

REDIAL PAUSE

Press to view redial memory. While entering numbers, press and hold to insert a dialing pause.

INTERCOM

Press to initiate an intercom conversation, transfer or forward a call.

Feature menu

 **NOTE:** For more information, please refer to the user's manual.

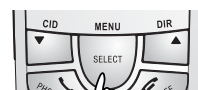
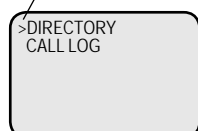

> shows a highlighted item



Menu

Feature menu

DIRECTORY
CALL LOG
RINGER VOLUME
RINGER TONE
KEY TONE
LANGUAGE
CLR VOICE MAIL
DIAL TYPE

Press  **CID** or  **DIR** to scroll through menu items.

Press **SELECT MENU** to select or modify a highlighted item.

Press  **OFF CLEAR** to cancel an operation, return to the previous menu, or exit the menu display.

Quick reference guide

Telephone base

HANDSET LOCATOR/ INTERCOM

Press to make handset(s) beep, initiate an intercom conversation, transfer or forward a call.

REDIAL/PAUSE

Press to activate the speakerphone to dial out the most recently called number.

When the speakerphone is already on, press to dial out the most recently called number or press and hold to insert a three-second dialing pause.

FLASH

During a call, press to receive an incoming call if call waiting is activated.

VOLUME

Press to adjust speakerphone listening volume or base ring volume.

MUTE

While on a call, press to mute microphone; press again to resume.

SPEAKER

Press to turn speakerphone on or off.



Answering system controls



Press to repeat message. Hold to slow playback. Press twice to hear previous message.

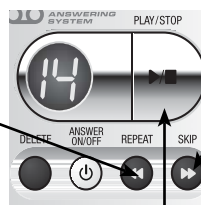

Press to skip to next message. Hold to speed up playback.

Press to play or stop playing messages.

ANSWER ON/OFF..

Press to turn answering system on or off.

DELETE Press to delete a message during playback. Press and hold to delete all old messages when set is idle.

TIME/SET Press to review or set the answering system clock.

SETUP Press to review or change answering system options.

CHANGE Press to change a setup option.

REC/MEMO Press to record a memo or press after pressing SETUP to record an outgoing announcement.