



User Manual (Part 2)

5.8 GHz Cordless Telephone/Answering System E5630/E5633/E5634B

with Caller ID & Call Waiting



**You must install and
charge battery before
using the telephone.**

STOP!

**See page 9
for easy instructions.**

For customer service or product
information, visit our web site at
www.telephones.att.com
or call **1-800-222-3111**.

Please also read
Important Product Information
Enclosed in product package.

Add new handsets to make your phone more versatile (see page 34)

Your telephone can accommodate up to four cordless handsets. You can add new handsets (Model E560-I, sold separately) at any time.

The handset provided with your telephone is automatically registered as Handset 1. Additional handsets will be assigned numbers in the order they are registered (2, 3 or 4). You can register a maximum of four handsets.



Handset 1



Handset 2



Handset 3



Handset 4



i NOTE: The E5634B has 4 pre-registered handsets. You cannot register any additional handsets to the E5634B.

User Manual (Part 2)

5.8 GHz Cordless Telephone/Answering System E5630/E5633/E5634B

with Caller ID & Call Waiting



Table of contents

Getting Started

Quick reference guide	2
Parts checklist	4
Before you begin	7
Telephone base installation	8
Battery installation & charging	9
Wall mounting	10
Belt clip & optional headset	11

Telephone Operation

Basic operation	12
Options while on calls	13
Intercom calls	14
Call Transfer	15
Handset settings	16

Phone book

About the phone book	18
New phone book entries	19
Phone book search	20
To dial, change or delete entries ...	21

Caller ID Logs

How Caller ID works	22
---------------------------	----

To review your call log	23
-------------------------------	----

Answering System Operation

Answering system operation	24
Day and time announcements	25
Outgoing announcements	26
Announce Only mode	27
Changing feature options	28
Message playback	29
Recording and playing memos	30
Message window displays	31
Remote access	32

Appendix

Screen icons, indicator lights & tones	33
Adding new handsets	34
Replacing a Handset	35
Re-Registering a Handset	36
In case of difficulty	37
Technical specifications	39
Index	40
Remote access wallet card	41

Getting Started

Quick reference guide

Handset

▼ CID

Press to scroll down in menus.
Press when phone is not in use to display Caller ID information (see page 23). While entering names, press to move the cursor to the left.

Select/Menu

Press to display menu, or to select highlighted item from menu.

▲ PHONE BOOK

Press to scroll up in menus.
Press when phone is not in use to display phone book entries (see page 20). While entering names, press to advance cursor.

Phone/Flash

Press to begin a call, then dial a number.
During a call, press to receive an incoming call if Call Waiting is activated (see page 13).

Off/Clear

During a call, press to hang up.
While using menus, press to cancel an operation, back up to the previous menu, or exit the menu display.

Redial/Pause

Press to view redial memory (see page 12).
While entering numbers, press and hold to insert a dialing pause (see page 19).

Mute/Delete

Press to mute microphone (see page 13).
While reviewing call log, press and hold to clear Caller ID log (see page 23).

Speaker

Press to activate handset speakerphone.
Press again to resume normal handset use (see page 12).

Intercom

Press to initiate an intercom conversation or transfer a call. (See page 14 and 15)

Feature menu

> shows highlighted item

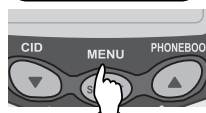
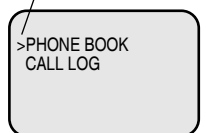

Menu

Feature Menu

Phone bookSee page 18
Call LogSee page 22
Ringer VolumeSee page 16
Ringer ToneSee page 16
Key ToneSee page 16
Language.....See page 17
Clear MSG WAITSee page 17
Dial TypeSee page 17

Press **▲** or **▼** to scroll through menu items.

Press **SELECT** to select or modify a highlighted item.

Press **OFF** to cancel an operation, back up to the previous menu, or exit the menu display.

Getting Started

Quick reference guide

Telephone Base

Handset Locator

Press to locate handset if lost (see page 12).

Volume

Press to adjust message playback volume.



Charging

On when handset battery is charging.

In Use

On when handset is in use. Flashes when another phone is in use on the same line, or answering system is answering an incoming call.

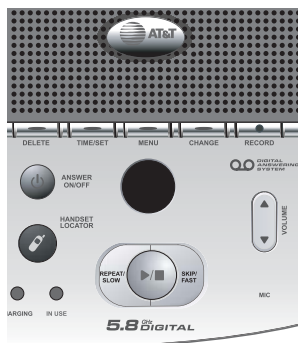

Answering System Controls (see pages 24-32)

Press to repeat message.
Hold to slow playback.
Press twice to hear previous message.



Press to skip to next message. Hold to speed up playback.

Press to play or stop playing messages.

ANSWER ON/OFF...Press to turn answering system on or off.

DELETEPress to delete message. Hold to delete all old messages.

TIME/SETPress to review or set the answering system clock.

MENUPress to review or change answering system options.

CHANGEPress to change a menu option.

RECORDPress to record a memo or outgoing announcement.

Getting Started

Parts checklist for E5630

Remember to save your sales receipt and original packaging in case you ever need to ship your telephone for warranty service. Check to make sure the telephone package includes the following:



Telephone base



Telephone handset

Power
adapter



Belt clip

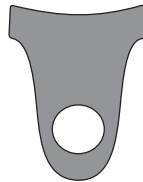

Battery



Telephone line cord



Wall mount bracket

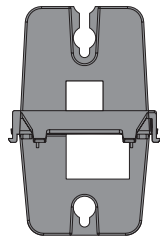

Getting Started

Parts checklist for E5633

Remember to save your sales receipt and original packaging in case you ever need to ship your telephone for warranty service. Check to make sure the telephone package includes the following:



Telephone base

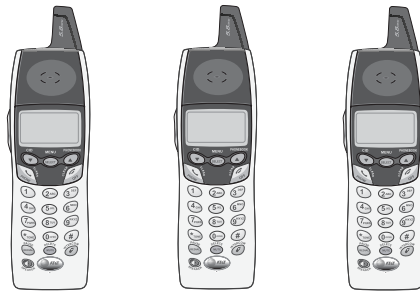

Handset chargers



Power adapters



Batteries

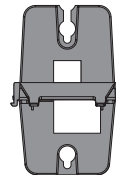

Wall mount bracket



Belt clips



Telephone line cord

Getting Started

Parts checklist for E5634B

Remember to save your sales receipt and original packaging in case you ever need to ship your telephone for warranty service. Check to make sure the telephone package includes the following:



Telephone base



Handset chargers

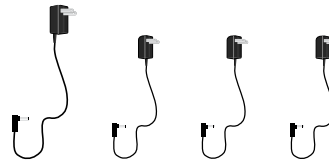

Power adapters



Batteries

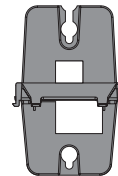

Wall mount bracket

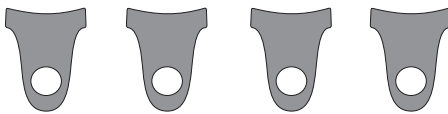

Belt clips



Telephone line cord

*Getting Started***Before you begin****About Caller Identification**

Caller ID with Call Waiting features in this telephone lets you see who's calling before you answer the phone, even when you're on another call. These features require services provided by your local telephone company.

Contact your telephone service provider if:

- You have both Caller ID and Call Waiting, but as separate services (you may need combined service).
- You have only Caller ID service, or only Call Waiting service.
- You don't subscribe to any Caller ID or Call Waiting services.

You can use this phone with regular Caller ID service, and you can use its other features without subscribing to either Caller ID or combined Caller ID with Call Waiting service. There may be fees for these services, and they may not be available in all areas.

Caller ID features will work only if both you and the caller are in areas offering Caller ID service, and if both telephone companies use compatible equipment.

See Caller ID Operation, beginning on page 22, for more details about how these features work.

Telephone operating range

This cordless telephone operates with the maximum power allowed by the Federal Communications Commission (FCC). Even so, this handset and base can communicate over only a certain distance — which can vary with the locations of the base and handset, the weather, and the construction of your home or office.

If you receive a call while you are out of range, the handset might not ring — or if it does ring, the call might not connect when you press **PHONE**. Move closer to the base, then press **PHONE** to answer the call.

If you move out of range during a phone conversation, you might hear noise or interference. To improve reception, move closer to the base.

If you move out of range without pressing OFF, your phone will be left off the hook. To hang up properly, walk back towards the telephone base, periodically pressing **OFF** until the call is disconnected.

Getting Started

Telephone base installation

Install the telephone base as shown below. Choose a base location away from electronic equipment, such as personal computers, television sets or microwave ovens. Avoid excessive heat, cold, dust or moisture.

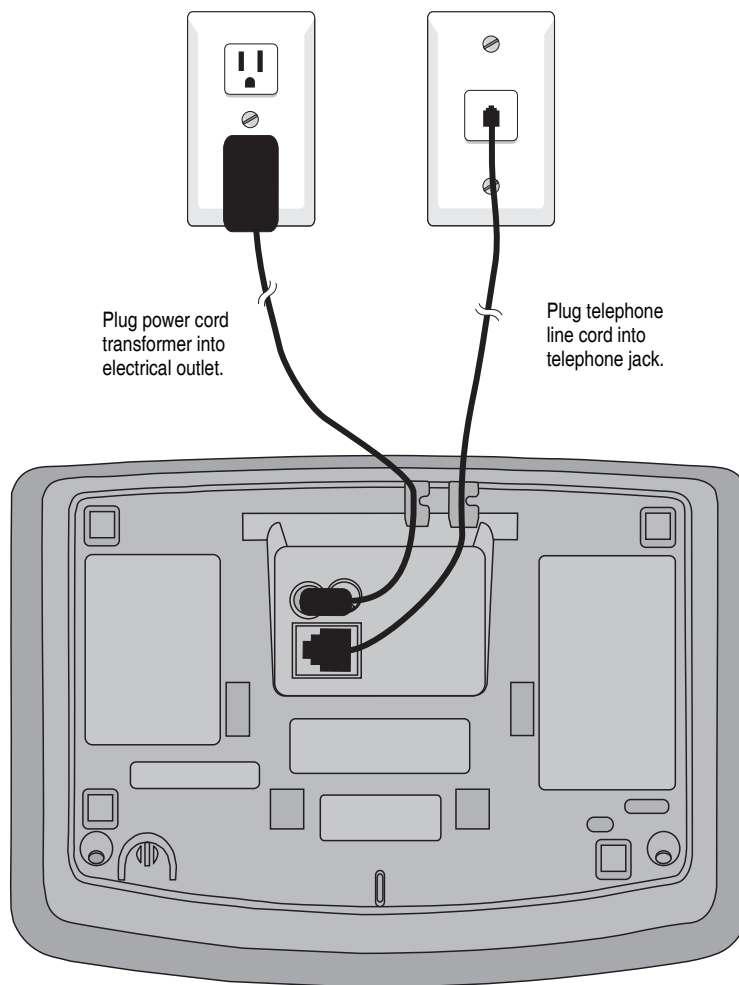

NOTE: Use only the power cord supplied with this product. If you need a replacement, call 1-800-222-3111. Be sure to use an electrical outlet not controlled by a wall switch.

*Getting Started***Battery installation & charging**

After battery installation, place the handsets in their base unit or charger and allow to charge for 15 hours before use. You can keep the batteries charged by returning the handsets to their base unit or charger after each use. When the battery is fully depleted, a recharge takes about 12 hours. Average talk time on a fully charged battery is about eight hours depending on environmental conditions. Standby time is approximately four days.

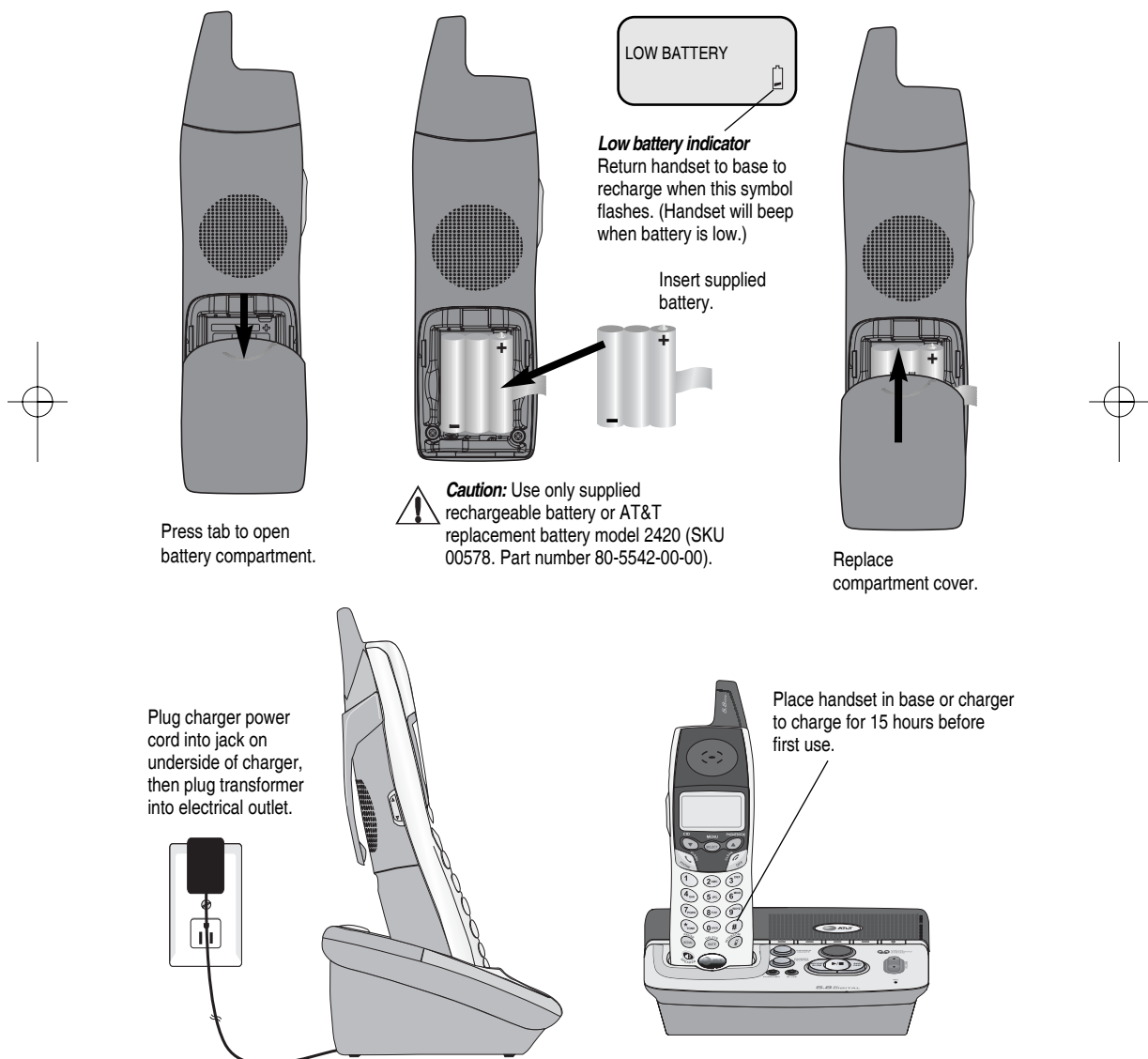

Getting Started

Wall mounting

The base can be installed on any standard wall-phone outlet as shown below. Choose a location away from electronic equipment such as personal computers, television sets or microwave ovens. Avoid excessive heat, cold, dust or moisture.

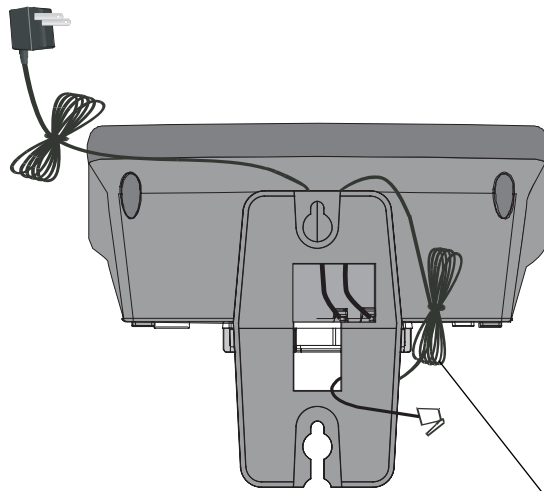

Install the line cord as shown in the diagram.

Connect cords as shown on page 8, then press and slide down firmly so base is held securely on outlet mounting pegs.

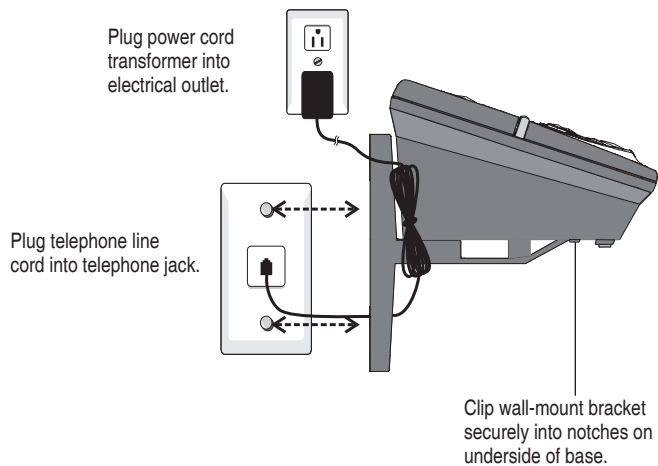

Plug power cord transformer into electrical outlet.

Plug telephone line cord into telephone jack.

Clip wall-mount bracket securely into notches on underside of base.

Getting Started

Belt clip & optional headset

Install belt clip as shown below if desired.

For hands-free telephone conversations, you can use any industry standard 2.5 mm headset (purchased separately). For best results use an AT&T 2.5 mm headset.

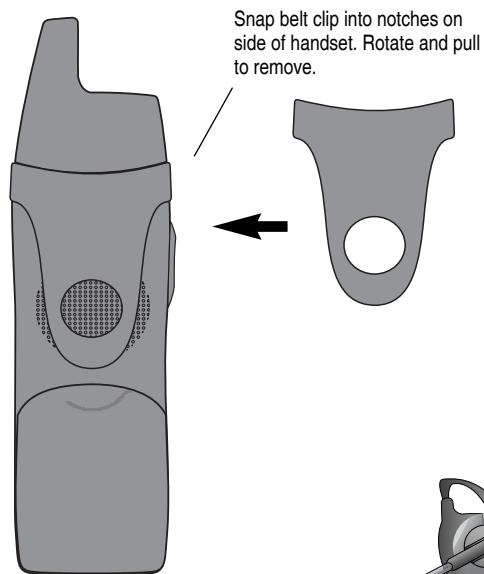

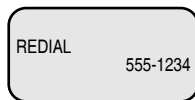
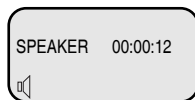
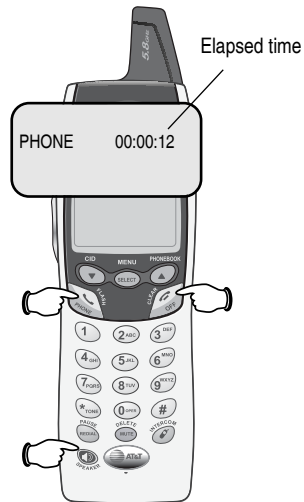

Telephone Operation

Basic operation

Making and answering calls

To answer an incoming call, press **PHONE** (or **SPEAKER**, or any dial pad key). To make a call, press **PHONE** or **SPEAKER**, then dial a number. Press **OFF** to hang up.

To preview numbers before dialing, enter numbers first, then press **PHONE** or **SPEAKER** to dial. Press **DELETE** or **CLEAR** at any time to make corrections as you are entering numbers.

The screen displays the elapsed time as you talk (in hours, minutes and seconds).

Ending a Call

Press **OFF** to end a call.

Auto Off - simply place the handset back in the charger to end a call.

Hands-free speakerphone calls

To answer a call, press **SPEAKER**. To make a call, press **SPEAKER**, then dial a number. During a call you can press **SPEAKER** to toggle between hands-free speakerphone and normal handset use. Press **OFF** to hang up.

Last number redial

Press **REDIAL** to display the most recently called numbers (up to 32 digits). Use the **▲** **▼** buttons or continue to press **REDIAL** to view up to four other recently called numbers. The handset will beep twice at the beginning or end of the list.

Press **PHONE** to redial any displayed number. Press **DELETE** to delete the number from the redial memory.

Handset locator

If you misplace the handset, press **HANDSET LOCATOR** at the base. The handset will beep for 60 seconds to help you locate it. To stop the beeping, press **PHONE**, **SPEAKER**, or any dial pad button at the handset, or press **HANDSET LOCATOR** at the base.

Telephone Operation

Options while on calls

Volume control

Press the **VOLUME** buttons on the side of the handset to adjust listening volume. Each button press raises or lowers volume by one level.

When you change the volume level, the new setting becomes the default. The new volume level will be applied each time you use the handset, speakerphone or headset.

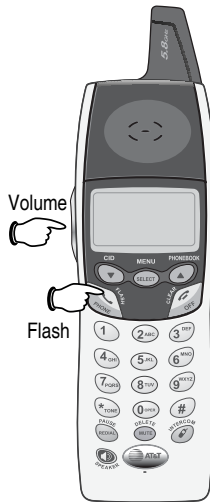

Call waiting

If you have Call Waiting service, you will hear a beep if someone calls while you are already on a call. Press **FLASH** to put your current call on hold and take the new call. You can press **FLASH** at any time to switch back and forth between calls.

3-way conference calls

During an outside call, if you have added additional handsets (see page 34), you can use two system handsets for a three-way conversation.

While a call is in progress, others can press **PHONE** or **SPEAKER** to join the conference call. Others can press **OFF** or place the handset in the base or charger to drop out of the conference call, but the call will not be terminated until all handsets hang up.



Mute

Press **MUTE** to silence the microphone. You will be able to hear, but your caller will not be able to hear you until you press **MUTE** again and resume speaking.

Ring silencing

Press **OFF** or **MUTE** while the phone is ringing to silence the ringer.

Temporary tone dialing

If you have dial pulse (rotary) service, you can switch to touch tone dialing during a call by pressing . This can be useful if you need to send tone signals for access to answering systems or long-distance services.

PHONE 00:00:12
MICROPHONE MUTED
MUTE

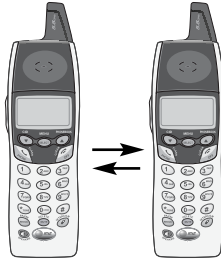

Telephone Operation

Intercom calls

Intercom calls

Use the intercom feature to have conversations between the handsets. If you have added additional handsets, see page 34 to register the handsets.

Press the **INTERCOM** button on a handset to initiate an intercom call. Then after entering the number of the handset you wish to intercom with, your handset will call the other handset.

Press **PHONE**, **INTERCOM**, **SPEAKER**, or any dial pad key on the handset being paged to enter intercom mode with the first handset.

To end the intercom call, press **OFF**, press **INTERCOM** or place the handset in the base or charger.



NOTE: The intercom feature cannot be utilized while any handset is in phone book or call log mode. Pressing **INTERCOM** while on an outside call will initiate Call Transfer (see page 15).

Handling incoming calls

The phone will beep if you receive an outside call during an intercom conversation. Now you can either:

- Press **PHONE** to terminate the intercom call and answer the incoming call.

OR

- Press **INTERCOM** or **OFF** to disconnect the intercom connection without answering the outside call.

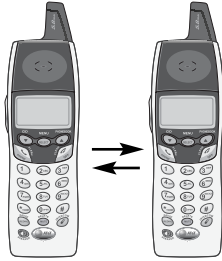

Telephone Operation

Call Transfer

Call Transfer

If you have added additional handsets (see page 34), you can transfer an external call from one handset to another handset.

- The first handset (HS1) can forward an external call to another handset (HS2, HS3, or HS4) by pressing the **INTERCOM** key. The first handset (HS1) will display "ENTER HANDSET #." After entering the handset number to which you want to forward the call, HS1 will display CALL FORWARDED.
- To answer the call, the selected system handset can press **PHONE**, **SPEAKER** or any dial pad keys.



NOTE: If the transferred call is not answered within 30 seconds, the external call will be returned to the handset that originated the transfer, and its display will show CALL BACK. If the returned call is not answered within an additional 30 seconds, the external call will end automatically.

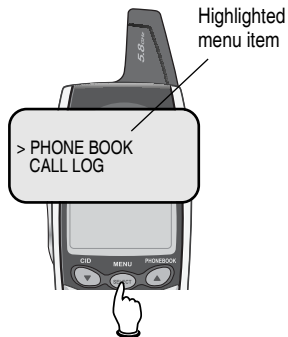

Telephone Operation

Handset settings

At the feature menu you can change settings to customize how the telephone works.

Press **MENU**, then use the **▲ ▼** buttons to scroll to the feature you want to change. As you scroll through the menu, the top menu item is always highlighted with a > symbol. Press **SELECT** to select the highlighted item.

Press **OFF** at any time to cancel an operation, back up to the previous menu, or exit the menu display.



Ringer volume

At this menu you can set a default ring volume level (1-6), or turn the ringer off. Use the **▲ ▼** buttons to hear an example of each volume level, then press **SELECT** to select the one you prefer.

Ringer volume can also be adjusted by pressing **VOLUME** on the side of the handset during incoming ringing.

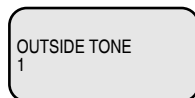

Ringer tone

This feature allows you to choose one of 10 ringing tones for outside calls or intercom calls. Use the **▲ ▼** buttons to hear an example of each ringer tone, then press **SELECT** to select the one you prefer.

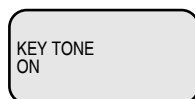
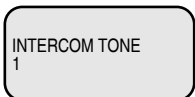

Key tone

The handset is factory programmed to beep at each key press. Use the **▲ ▼** buttons to select **ON** or **OFF**, then press **SELECT** to save your preference.

Telephone Operation

Handset settings

LANGUAGE
ENGLISH

>PHONEBOOK
CALL LOG

>CLEAR MSG WAIT
DIAL TYPE

TURN INDICATOR
OFF?

>CLEAR MSG WAIT
DIAL TYPE

DIAL TYPE
TONE

Language

At this menu you can select the language used in all menus and screen displays. Use the **▲ ▼** buttons to select English, Spanish, or French, then press **SELECT** to save your preference.

Clear Message Waiting Indicator

If you subscribe a voice mail service provided by your local telephone company, you will receive a text message on the handset when you have new voice mail. To manually remove the VOICE MAIL message on the display:

- Press **MENU**.
- Press **▲** and **▼** to highlight **CLEAR MSG WAIT**.
- Press **SELECT**.
- When asked to confirm, press **SELECT** to remove the indication, or press **OFF** to exit without changing.



NOTE: This only turns off the displayed message on the handset, it does not delete your voice mail message(s).

Dial Type

At this menu you can choose Tone or Pulse dialing. The factory default setting is **TONE**. Change this to **PULSE** only if you do not have touch-tone dialing service.

Use the **▲ ▼** buttons to select **TONE** or **PULSE**, then press **SELECT** to save your preference.

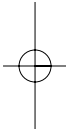

Phone book

Timeouts and error messages

If all memory locations are in use, the screen will display **PHONE BOOK IS FULL**. You will not be able to store a new number until you delete an existing one.

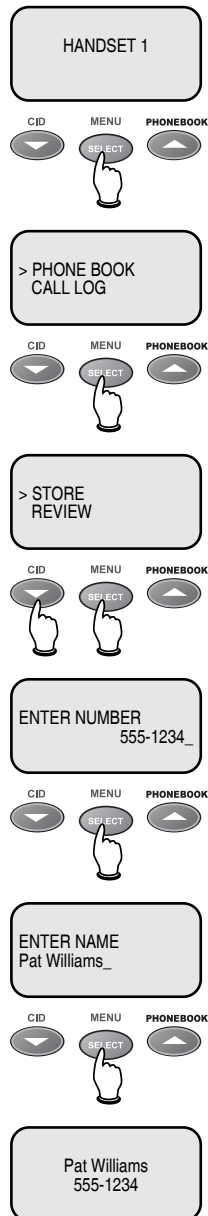

Phonebook

New phone book entries

To create a new phone book entry

Press **MENU** twice to select **PHONE BOOK**. Press **V** to highlight **STORE**. Press **SELECT**, then enter the telephone number when prompted.

Use the dial pad to enter up to 32 digits, then press **SELECT**. You will be notified if the number is already in your phone book.

To insert a number from your redial list, press **REDIAL**, then **▲ V** to find the number, then press **SELECT**.

- Press **DELETE** to erase numbers if you make a mistake.
- Press and hold **PAUSE** to enter a 3-second dialing pause.

To enter a name

Press dial pad buttons once for the first letter, twice for the second, three times for the third. Continue for lower-case letters or numerals.

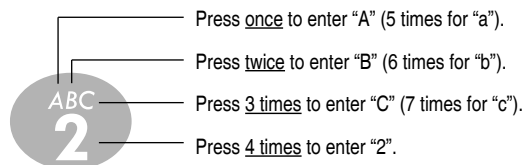

The cursor moves to the right when you press another dial pad button or the **▲** button. Press **V** to move the cursor to the left. Press **1** to enter a space, or press twice to enter "I".

- Press **DELETE** to erase letters if you make a mistake.
- Press ***** repeatedly to enter an asterisk (*), question mark (?), exclamation point (!), slash (/) or parentheses.
- Press **#** repeatedly to enter a pound sign (#), apostrophe ('), comma (,), hyphen (-), period (.), or ampersand (&).

Storing the entry

Press **SELECT** to store your new phone book entry. To change it later, see page 21.

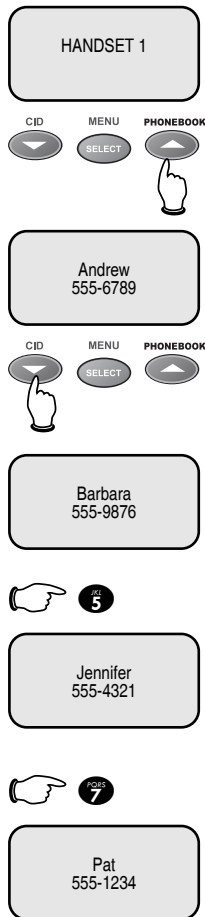

Phonebook

Phone book search

Press **PHONE BOOK** to display the first listing in the phone book. You can then use the **▲** or **▼** to browse through the phone book, or search to find a specific entry. Press **OFF** at any time to exit the phone book.

To browse through the phone book

To browse, press **▲** or **▼** to scroll through all entries one by one. Entries will be displayed alphabetically by the first letter in the name.

To search by name

When any entry is displayed, you can press a dial pad button to display the first name beginning with a letter associated with that key.

Press dial pad buttons once for the first letter, twice for the second, three times for the third, as shown on the previous page.

For example, press **5 (JKL)** once to find Jennifer, twice to find Kevin, or three times to find Linda.

To call a displayed number

When you find the entry you want, press **PHONE** (or **SPEAKER**) to dial. Or press **SELECT** to modify the entry (see next page).

Viewing long numbers

The screen can display only 16 digits at a time. To view numbers longer than this, press *** (Paging)** or **# (End of Call)** to display the remaining digits.



Phonebook

To dial, change or delete entries

To dial a number

When any phone book entry is displayed, press **PHONE** (or **SPEAKER**) to dial the displayed number.

To delete an entry

When any phone book entry is displayed, press **DELETE** to delete the displayed entry from the phone book. Once deleted, an entry cannot be recovered.

To change a listing

When any phone book entry is displayed, press **SELECT** to modify the entry. (See page 19 for help in modifying the name or number.)

Change the number as needed, then press **SELECT**. Change the name as needed, then press **SELECT** to save the modified entry.



Caller ID Logs

Caller ID Logs

How Caller ID works

If you subscribe to Caller ID service provided by your local phone company, information about each caller will be displayed after the first ring.

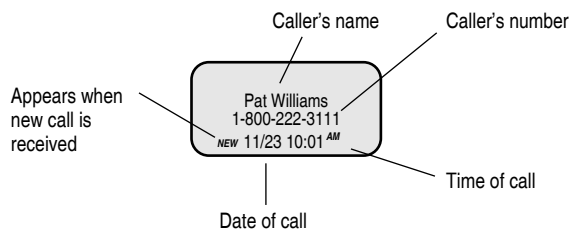

Information about the last 50 incoming calls is stored in your call log. You can review the call log to find out who has called, return the call without dialing, or copy the caller's name and number into your phone book.

When the call log is full, the oldest entry is deleted to make room for new incoming call information.

If you answer a call before the information appears on the screen, it will not be saved in your call log.



Note: Only one handset can review the call log at a time. If the other handset attempts to enter the call log, will display NOT AVAILABLE AT THIS TIME.

About names

Names of callers will be displayed only if this information is provided by your local telephone company.

If the telephone number of the person calling exactly matches a number in your phone book, the name that appears on the screen will match the name that you entered it into your phone book.

(Example: If Christine Smith calls, her name will appear as **Chris** if this is how you entered it into your phone book.)

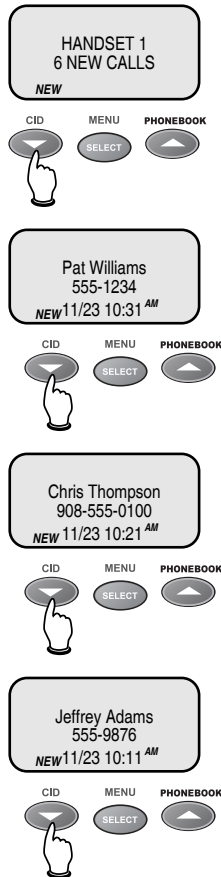

Caller ID Logs

To review your call log

To review your call log

Press **CID** to review your call log. The most recent call is displayed first. Use the arrow buttons to scroll through the list as shown at left.

To return a call

Press **PHONE** (or **SPEAKER**) to call the number as displayed.

To change the number before calling, press **#** repeatedly to see a list of dialing options (you can choose to dial with or without the area code), then press **PHONE** (or **SPEAKER**) to place the call.

Example:

CIDNumber displayed as **908-555-0100**

(press twice).....Number changes to **555-0100** (drops "1" + area code)

PHONE/

SPEAKERDials **555-0100**

Other options

- Press **DELETE** to delete this entry from your call log.
- Press and hold **DELETE** to delete all entries from your call log. When asked to confirm, press **SELECT** to clear your call log of all entries, or **OFF** to exit and leave all call log entries intact.
- Press **SELECT** to copy this entry into your phone book. If the name or number is not provided, you will be prompted to enter them.

Answering System Operation

Answering System Operation

Message capacity

The answering system can record up to 99 messages, depending on the length of each message. Individual messages can be up to 4 minutes long, but total maximum recording time is 15 minutes. Messages will remain available for replay until you delete them.



Message counter

Number of messages
(or during playback, message
number currently playing).

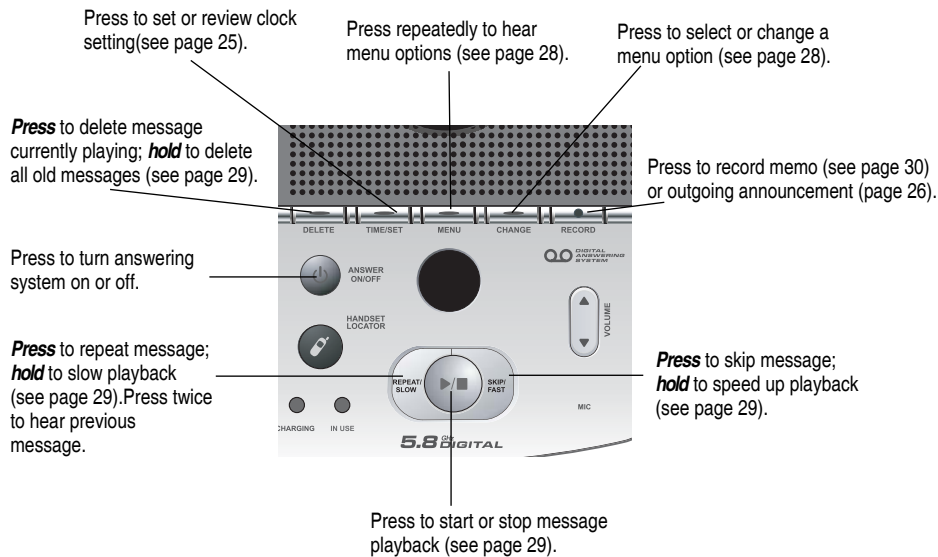

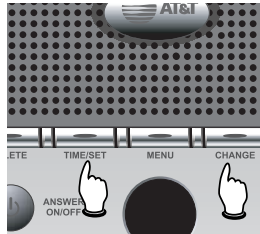

1. Make sure the answering system is on.

2. Press **TIME SET**

The system will announce the current clock setting, then announces *"To change clock, Press TIME SET!"*

3. Press **TIME SET**

4. Press **CHANGE**

until the system announces the correct day, then press **TIME SET**.

5. Press **CHANGE**

until the system announces the correct hour, then press **TIME SET**.

6. Press **CHANGE**

until the system announces the correct minutes, then press **TIME SET**.



NOTE: You can press and hold **CHANGE** to advance the minutes in increments of ten.

7. Press **CHANGE**

until the system announces the correct year, then press **TIME SET**. The system announces the current clock setting.

Answering System Operation

Day and time announcements

To set day and time

Before playing each message, the answering system announces the day and time the message was received.

Before using the answering system, you should follow the steps at left to set the day and time, so messages are dated correctly.

The system uses voice prompts to guide you. Each time you press **CHANGE**, the day, hour, minute or year advances by one. When you hear the correct setting, press **TIME SET** to move to the next setting.

To check day and time

You can press **TIME SET** at any time to hear the current day and time without changing it.



NOTE: Press and hold **CHANGE** to advance the minute or year by 10.



NOTE: After you set the time once, it will thereafter be set automatically with incoming Caller ID information. The time will be set automatically only if you subscribe to Caller ID service provided by your local telephone company (see page 7).

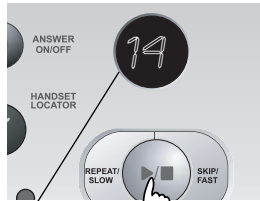

Elapsed recording time (seconds). Press to stop recording.

1. **MENU**

 "Change announcement"

2. **(Play/Stop)**

 (Plays announcement previously recorded).

Or

2. **RECORD**

 "Now recording..."

3. Speak into microphone.

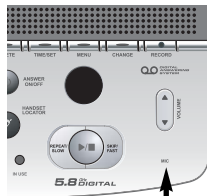

Microphone

4. **(Play/Stop)**

 (Announcement is played back).

Answering System Operation

Outgoing announcements

Outgoing announcements are the messages callers hear when calls are answered by the answering system.

The phone is pre-programmed with an announcement that answers calls with **"Hello. Please leave a message after the tone."** You can use this announcement, or replace it with a recording of your own voice.

To record your outgoing announcement

Press **MENU** until you hear **"Change announcement."** Then press **RECORD** and begin speaking after you hear **"Now recording."** Speak facing the telephone base from about nine inches away. Press **Play/Stop** when you are done.

Elapsed time (in seconds) will be shown in the message window as you record. You can record an announcement up to 90 seconds long. Announcements less than three seconds will not be recorded.

To delete your outgoing announcement

Press **MENU** until you hear **"Change announcement,"** then press **PLAY/STOP** to begin playback. Press **DELETE** during playback to delete your announcement.

When your announcement is deleted, calls will be answered with the pre-programmed announcement described above.

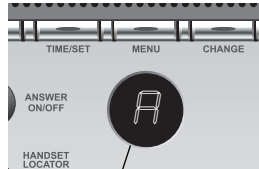

"A" is displayed when Announce Only is activated.

1. MENU

 "Change Announce Only"

2. CHANGE

 "Off"

3. CHANGE

 "On"

4. (Play/Stop)

 **Beep**
(Option selected).

Answering System Operation

Announce Only mode

In Announce Only mode, callers hear an announcement but cannot leave messages. This option can be used, for example, to notify callers that you will be away for an extended period and request that they call back after a certain date.

To turn Announce Only on or off

Press **MENU** repeatedly until you hear **"Change Announce Only."** Then press **CHANGE** until you hear the option you want (On or Off). Press **PLAY/STOP** to store your selection and exit, or press **MENU** again to modify other features (see page 28).

To record your outgoing announcement

When Announce Only is turned on, calls are answered with a pre-recorded announcement that says **"We're sorry, messages to this number cannot be accepted."** You can use this announcement, or replace it with a recording of your own voice.

After turning on the Announce Only feature, follow the steps on page 26 to record your announcement. Callers will hear this announcement only when the Announce Only feature is turned on. Otherwise they will hear the standard announcement asking them to leave a message.

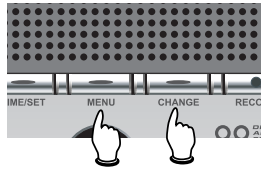

1. **MENU**

Press until desired feature is heard (see list at right).

2. **CHANGE**

Press until desired selection is heard.

3. **MENU**

Press to set selection and **move** to next menu option.

Or



Press to set selection and **exit** menu.

Answering System Operation

Changing feature options

Menu features can be changed to customize how the answering system operates. Press **MENU** repeatedly to hear each feature. Press **CHANGE** when you hear the feature you want to modify.

Feature options (Default settings underlined>.

System announces:	Feature description:
"Change announcement" Options: [record announcement]	Record your outgoing announcement (see page 26).
"Change remote access code" Options: [enter 2-digit code] <u>19</u>	Enter a 2-digit number (10-99) for remote access from another phone (see page 32).
"Change message alert" Options: On / <u>Off</u>	When on, the telephone beeps every 10 seconds when you have new messages.
"Change announce only" Options: On / <u>Off</u>	When on, callers hear an announcement but cannot leave messages (see page 27).
"Change base ringer" Options: <u>On</u> / Off	Choose this option to turn the base ringer on or off (does not affect handset).
"Change number of rings" Options: 2 / <u>4</u> / 6 / Toll Saver	Choose number of rings before the system answers a call. When Toll Saver is active, the system answers after 2 rings if you have new messages, and after 4 rings if you have no new messages.



NOTE: Press and hold **CHANGE** to advance the remote access code number by 10.



NOTE: If you turn your answering system off or if you experience a loss of power, the message alert feature will be turned off. To turn the message alert feature back on follow the above instructions.

Number of messages waiting
(or, during playback, message
number currently playing).

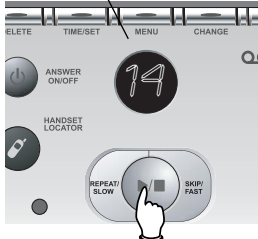

Press **PLAY/STOP** to begin or
end message playback.

- 1.** **(Play/Stop)**
 "You have [xx] new messages
and [xx] old messages"

Message playback begins. See
options at right.

- 2.** **(Play/Stop)**
 Message playback ends.

NOTE: If "F" is flashing in
the message window, memory is
full. You will have to delete some
messages before new ones can
be received.

NOTE: New (unheard)
messages cannot be deleted.

Answering System Operation

Message playback

Press **PLAY/STOP** to hear messages. The system
announces the number of messages, then begins playback.

If you have new messages waiting, you will hear only the
new messages (oldest first). If there are no new messages,
the system will play back all messages (oldest first).

Announcements

- When playback begins, you will hear the total
number of messages.
- Before each message, you will hear the day and time
it was received.
- After the last message, you will hear **"End of
messages."** If the system has less than 5 minutes of
recording time left, you will hear time remaining.

Options during playback

- Press **VOLUME** button to adjust speaker volume.
- Press **SKIP** to skip to next message (or hold down to
speed up message playback).
- Press **REPEAT** to repeat message currently playing.
Press twice to hear previous message (or hold down
to slow message playback).
- Press **DELETE** to delete message being played back.
- Press **PLAY/STOP** to stop playback.

To delete all messages

To delete all messages, press and hold **DELETE** while
the phone is idle (not during a call, or during message
playback).

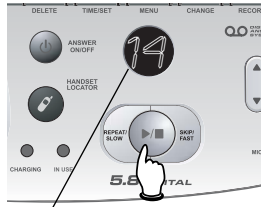

Elapsed recording time (seconds).

Press to stop recording.

1. **RECORD**

"Now recording..."

2. Speak into microphone.

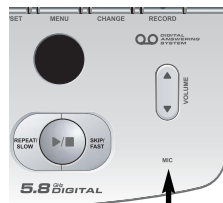

Microphone

3. **(Play/Stop)**

Beep (Memo has been recorded).

Answering System Operation

Recording and playing memos

Memos are messages you record yourself. They are saved, played back and deleted exactly like incoming messages. You can record a memo as a reminder to yourself, or leave a message for someone else if other members of your household use the answering system.

To record a memo

Follow the steps at left to record a memo. Elapsed time (in seconds) are shown in the message window as you record. You can record a memo up to 4 minutes long. Memos less than 1 second long will not be recorded.

To play back a memo

Press **PLAY/STOP** to hear messages and memos (see page 29 for other options).

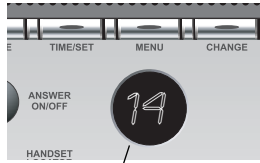

Message window

Answering System Operation

Message window displays

The message window usually displays the total number of memos and incoming messages. See the list below for explanations of other displays in this window.

Message window displays

\square	No messages.
1-98	Number of messages/memos, or message number currently playing (flashes if new message waiting).
10-99	Current Remote Access Code while setting (see page 28).
1-8	Current volume level while adjusting.
1-99 (counting)	Elapsed time while recording a memo (see page 30) or announcement up to 90 seconds (page 26).
99 (flashing)	Memo recording exceeded maximum time of 99 seconds.
F (flashing)	Memory is full. Messages must be deleted before new messages can be received.
CL (flashing)	Clock needs to be set (see page 25).
A	Announce Only mode is on (see page 27).
--	System is answering a call, or being accessed remotely.
-- (flashing)	System is being programmed or initialized.
$\square n$ (or) $\square F$	Displayed for 1 second when any answering system setting is turned on or off.

1. Dial your telephone number from any touch-tone phone.
2. When system answers, enter 2-digit Remote Access Code ("19" unless you have changed it).
3. Enter remote commands (see list at right).
4. Hang up to end call and save all undeleted messages.



NOTE: If you pause for more than 10 seconds during remote access, you will hear a help menu listing all features & commands. If you issue no command for another 20 seconds, the call will end automatically.

Answering System Operation

Remote access

A 2-digit security code is required to access your answering system from any touch-tone phone. This code is **19** by default; see page 28 to change it.

Play messages

2

Press to hear new messages (if none are new, all play back).

Repeat or go back

4

Press to repeat current message. Press twice (# 4 # 4) to hear previous message.

Skip to next message

6

Press to skip current message and advance to next message.

Stop

5

Press to stop any operation (stop playback, stop recording).

Delete message

9

Press during playback to delete current message.

Review announcement

7

Press to review current outgoing announcement.

Record announcement

* 7 to begin recording
5 to stop recording

Press * 7, wait for beep, then begin speaking. Press # 5 to stop recording and hear playback of new announcement.

Record memo

* 8 to begin recording
5 to stop recording

Press * 8, wait for beep, then begin speaking. Press # 5 to stop recording.

Turn system off

0

Press to turn off answering system. Incoming calls will no longer be answered.

Turn system on

0

If off, system will answer after 10 rings. Enter your access code, then press # 0 to turn on.

Help Menu

1

Press to hear list of features & commands.

Exit

* 0

End remote access call (or hang up).





Appendix

Screen icons, indicator lights & tones

Handset screen icons & alert tones



Screen icons

-  Speakerphone in use.
-  Ringer off.
-  Battery charging (animated display).
-  Low battery (flashing); place handset in base or charger to recharge.
- MUTE** Microphone is muted.
- NEW** New calls (press **CID** to review call log).

Alert tones

- Happy tone** Programming command completed successfully.
- 2 beeps** Programming error (or last record in list displayed).

Indicator lights

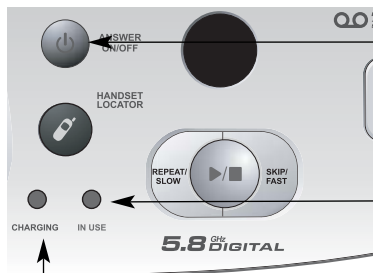

Answer On/Off

On when answering system is activated and ready to receive calls.

In Use

On when handset is in use. Flashes when another phone is in use on the same line, or answering system is answering an incoming call.

Charging

On when handset battery is charging.

Speaker

On when speakerphone is in use.



Appendix

Adding new handsets

Your telephone can accommodate up to four cordless handsets. You can add new handsets (E560-I, sold separately) to the E5630 and E5633 at any time, but each handset must be registered with the base before use.

The handset provided with your E5630 is automatically registered as Handset 1. Additional handsets will be assigned numbers in the order they are registered (Handset 2, Handset 3, or Handset 4). You can register a maximum of 4 handsets.

The E5633 has 3 handsets automatically registered as Handset 1, 2 and 3. You can register one additional handset, which will be assigned number 4.

The E5634B has 4 handsets automatically registered as Handsets 1, 2, 3 and 4. You cannot register any additional handsets to the E5634B.

Enter Base ID, then press **SELECT**.

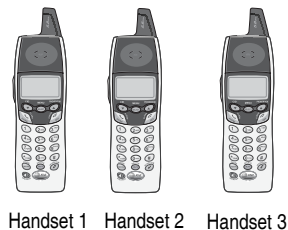
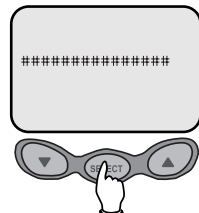

Before using a new E560-I handset, you must register it with the base. During registration, you must enter the 15-digit ID number of the telephone base. The Base ID is located on the bottom of the base unit.

To add a new handset:

- Make sure your handset batteries are properly installed and charged.
- Your handset will display “SEARCHING...”.
- Press and hold the **SELECT** key until the handset displays “ENTER BASE ID”.
- Enter the 15-digit Base ID number from the bottom of the base unit. (E5630 or E5633)
- Press **SELECT** to accept the code and complete registration.

NOTE: If an invalid Base ID code is entered, you will hear an error tone and the handset will continue to display “ENTER BASE ID”. To make corrections while entering the code, you can erase digits by pressing the **DELETE** key.

Once a valid Base ID code is entered and accepted by the base unit, the new handset will be assigned the next available handset number (Handset 2, Handset 3, or Handset 4). You can register a maximum of four handsets per base unit.

Appendix

Replacing a Handset

If you are replacing a handset on a system that has the maximum number of registered handsets (4) or wish to change the assigned handset number of your registered handsets, you must first de-register the handsets, then re-register all handsets.

De-Register All Handsets

- Unplug the power supply from the base unit.
- **Remove all handsets from the charge cradles and base.**
- Plug in the power supply while pressing the HANDSET LOCATOR button on the base.
- Continue pressing HANDSET LOCATOR until the IN USE and CHARGING indicators are lit. (This could take up to 10 seconds.)
- Release the HANDSET LOCATOR button.
- All Handsets will display:

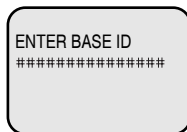

Once the base indicators turn off (up to 30 seconds), the handsets have been de-registered from the base, and can now be re-registered (see page 36).

Appendix

Re-Registering a Handset

You can re-register handsets after de-registering from the base. Or you can re-register handsets to a new base unit, if you have replaced your base unit for any reason.

To re-register a handset:

- Make sure your handset batteries are properly installed and charged.
- Your handset will display “ENTER BASE ID”.
- Enter the 15-digit Base ID number from the bottom of the base unit.
- Press **SELECT** to accept the new code and complete re-registration.

To re-register a handset to a new base unit:

- Make sure your handset batteries are properly installed and charged.
- Unplug the old base unit.
- Install the new base unit by plugging it into the electrical outlet and phone jack.
- Your handset will display “SEARCHING...”.
- Press and hold the **SELECT** key until the handset displays “ENTER BASE ID”.
- Enter the new 15-digit Base ID number from the bottom of the new base unit.
- Press **SELECT** to accept the new code and complete re-registration.



NOTE: If an invalid Base ID code is entered, you will hear an error tone and the handset will continue to display “ENTER BASE ID”. To make corrections while entering the code, you can erase digits by pressing the **DELETE** key.

Once a valid Base ID code is entered and accepted by the base unit, the new handset will be assigned the next available handset number. You can register a maximum of four handsets per base unit.

Appendix

In case of difficulty

If you have difficulty with your phone, please try the suggestions below. For Customer Service, visit our web site at **www.telephones.att.com**, or call 1-800-222-3111.

Telephone does not work at all

- Make sure battery is installed and charged correctly (see page 9).
- Make sure the AC adapter is plugged into an outlet not controlled by a wall switch.
- Make sure the telephone line cord is plugged firmly into the base unit and the modular jack.
- If you have dial-pulse telephone service, make sure the dial mode is set to Pulse (see page 17).
- If these suggestions do not work, unplug the base, remove and re-insert the battery, then place the handset in the base to re-initialize.

Phone does not ring

- Make sure the ringer is on (see page 16).
- Make sure the telephone line cord and AC adapter are plugged in properly (see page 8).
- Move the handset closer to the base.
- You might have too many extension phones on your telephone line to allow all of them to ring. Try unplugging some of them.

If you hear noise or interference during a call

- You may be out of range. Move closer to the base.
- Appliances plugged into the same circuit as the base can cause interference. Try moving the appliance or base to another outlet.
- The layout of your home or office might be limiting the operating range. Try moving the base to another location, preferably on an upper floor.
- Disconnect the base from the modular jack and plug in a corded telephone. If calls are still not clear, the problem is probably in your wiring or local service. Call your local telephone service company.
- Do you have DSL service? If so, you need to have a DSL filter installed at every phone jack that has a phone connected to it. Contact your DSL service provider for filter information.

Handset displays "Charging....", and buttons do not respond

- The base unit may have lost power. Make sure the base unit is plugged into the power source.
- Place the handset in the base unit (or Charge Cradle of E560-1), wait 4 minutes. The handset will return to "Searching" mode and link with the base unit.
- If this does not happen, remove the handset battery for at least 3 seconds, then replace it. The handset will return to "Searching" mode and link with the base unit.

Appendix

In case of difficulty

Incomplete messages

- If a caller leaves a very long message, part of it may be lost when the system disconnects the call after 4 minutes.
- If the caller pauses for more than 7 seconds, the system stops recording and disconnects the call.
- If the system's memory becomes full during a message, the system stops recording and disconnects the call.

Difficulty hearing messages

- Press  on the base to increase speaker volume.

System does not answer after correct number of rings

- Make sure that the answering system is on.
- If Toll Saver is activated, the number of rings changes to 2 when you have new messages waiting (see page 28).
- In some cases, the system may be affected by the ringing system used by the local telephone company.
- If the memory is full or the system is off, the system will answer after 10 rings.

"CL" flashes in message window

- You need to reset the answering system clock (see page 25).

System does not respond to remote commands

- Make sure to enter your Remote Access Code correctly (see page 32).
- Make sure you are calling from a touch-tone phone. When you dial a number, you should hear tones. If you hear clicks, the phone is not a touch-tone telephone and cannot activate the answering system.
- The answering system may not detect the Remote Access Code while your announcement is playing. Try waiting until the announcement is over before entering the code.
- There may be noise or interference on the phone line you are using. Press dial-pad buttons firmly.

Announcement message is not clear

- When you record your announcement, make sure you speak in a normal tone of voice, about 9 inches from the base.
- Make sure there is no "background" noise (TV, music, etc.) while you are recording.

*Appendix***Technical specifications**

<i>RF Frequency Band (Handset to base)</i>	2400 MHz — 2485 MHz
<i>RF Frequency Band (Base to handset)</i>	5740 MHz — 5830 MHz
<i>Channels</i>	95
<i>Channel Spacing</i>	864 KHz
<i>Output Power</i>	Handset: 19 dBm (nominal) Base: 29 dBm (nominal)
<i>Sensitivity</i>	-98 dBm
<i>Modulation</i>	GFSK
<i>Operating Temperature</i>	32°F — 122°F 0°C — 50°C
<i>Base Unit Voltage (AC Voltage, 60Hz)</i>	96 — 130 Vrms
<i>Base Unit Voltage (AC Adapter Output)</i>	9VDC @600mA
<i>Handset Voltage</i>	3.2 — 4.7 VDC @750 mA
<i>Replacement Battery</i>	Model 2420 (SKU 00578) 3.6V 700mAh

Appendix

Index

A

AC adapter, 8
 Adding new handsets, 34
 Alert tones, 33
 Answering calls, 12
 Answering system, 24-32
 Auto Off, 12

B

Battery charging, 9
 Battery installation, 9
 Belt clip, 11

C

Caller ID, 22
 add entries to phone book, 23
 delete entries, 23
 dial entries, 23
 CID, 22

D

Delete Call Log entries, 23
 Delete redial entries, 12
 Dialing,
 from a CID record, 23
 manual dialing, 12
 phone book dialing, 21

E

Elapsed time, 12
 Ending calls, 12

F

Flash (switchhook flash), 13

H

Hands-free use, 12
 Handset locator, 12
 Headset, 11

I

Incoming call log, 22
 Incoming calls, answering, 12
 Indicator lights, 33

L

Last number redial, 12
 Low battery, 9

M

Making calls, 12
 Menus, 2
 Messages, 24-32
 Mute, 13

N

Names,
 enter into phone book, 19
 search for, 20

O

Operating range, 7

P

Phone book, 18
 dial number, 21
 edit entries, 21
 name search, 20
 new entries, 19
 Problems, 37

Q

Quick reference guide, 2-3

R

Receiving calls, 12
 Recharging, 9
 Redial, 12
 Ring silencing, 13
 Ring tone options, 16
 Replacing a Handset, 35
 Re-Registering a Handset, 36

S

Search for name, 20
 Speakerphone, 12
 Switchhook flash, 13

T

Technical specifications, 39
 Troubleshooting, 37

V

Appendix

Remote access wallet card

Use the wallet card below to help you remember commands to control your answering system from any touch tone telephone.

Cut along dotted line.

Fold here.



Call your phone number, then enter your 2-digit access code (preset to 19).

Action	Remote Command
Voice help menu	# 1
Play messages	# 2
Repeat message	# 4
Skip message	# 6
Stop	# 5
Save messages	Hang up.
Delete message	# 9 while message plays.

Review announcement	# 7	
Record announcement	* 7	Speak after beep.
	# 5	to stop.
Record memo	* 8	Speak after prompt.
	# 5	to stop.
End remote access call	* 0	(or hang up).
Turn system off	# 0	(enter again to turn on).
Turn system on	If off, system answers after 10 rings. Enter your access code, then press # 0 to turn system on.	

5.8 GHz Cordless Telephone/Answering System E5630/E5633/E5634B

Copyright © 2005 Advanced American Telephones. All Rights Reserved.
AT&T and the Globe Design are trademarks of AT&T Corp.,
licensed to Advanced American Telephones. Printed in China.



www.telephones.att.com

Copyright © 2006 Advanced American Telephones. All Rights Reserved.
AT&T and the Globe Design are trademarks of AT&T Corp.,
licensed to Advanced American Telephones. Printed in China. Issue 7 AT&T 01/06.
91-000343-060-000