



2.4 GHz Expansion Handset 2300



For Customer Service Or Product
Information, Visit Our Website At
www.telephones.att.com

Please also read
**Part 1 — Important
Product Information**



Visit us at www.telephones.att.com

© 2002 Advanced American Telephones.

All rights reserved.

AT&T and the Globe Design are
trademarks of AT&T Corp. licensed to
Advanced American Telephones.

Printed in China. Issue 1AT&T 07/02

CONTENTS

BEFORE YOU BEGIN	1
Parts List	1
Compatibility	2
About Handset Registration	2
INSTALLATION	3
Charging Stand Installation	3
Belt Clip	5
Headset	5
FEATURE SETUP AND OPERATION	6
DEFAULT SETTINGS	7
TECHNICAL SPECIFICATIONS	8

BEFORE YOU BEGIN

Parts List

Your box should include:

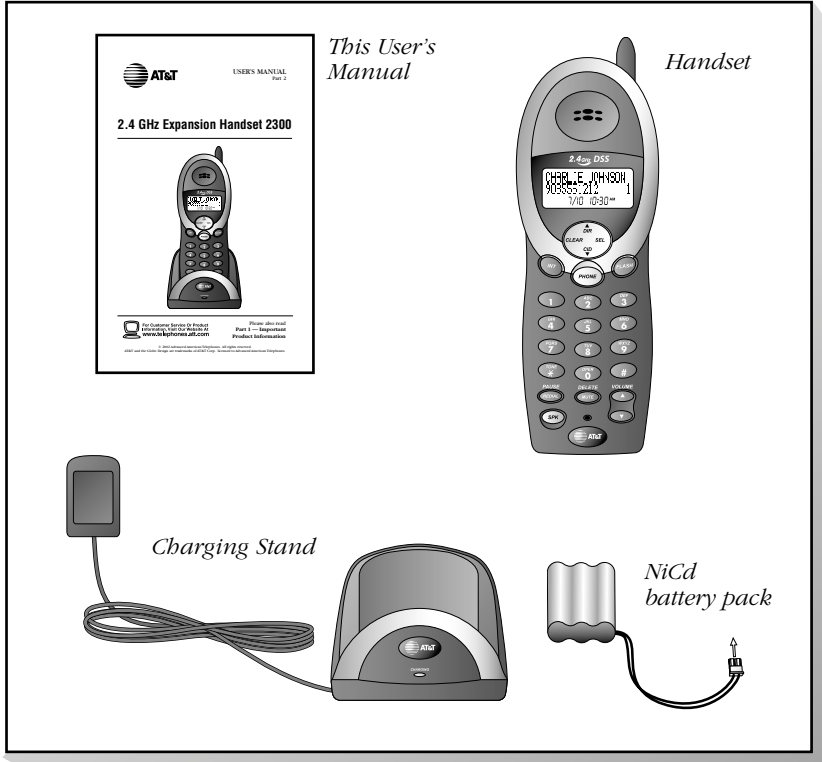

BEFORE YOU BEGIN

Compatibility

This AT&T 2300 expansion handset is compatible with the AT&T 2320, 2325, 2355 and 2365 telephones. You may add up to three expansion handsets to your compatible telephone, for a total of four handsets. If you try to install a fifth handset, registration will be blocked.

About Handset Registration

Each expansion handset must be individually registered with your AT&T 2320, 2325, 2355 or 2365 base. Registration happens automatically when you place this handset **fully charged** into your current base.

(See INSTALLATION beginning on page 3).

The original handset that came with the base is automatically registered as Handset 1. Additional handsets will be assigned Handset 2, Handset 3 and Handset 4. You can rename the handsets by following the directions under “Handset Name” in the FEATURE SETUP section of your base telephone User’s Manual.

INSTALLATION

Charging Stand Installation

Ⓢ **NOTE:** *Install the charging stand away from electronic equipment, such as personal computers, television sets or microwave ovens. Avoid excessive heat, cold, dust or moisture.*

- 1 **Connect the power cord to an electrical outlet not controlled by a wall switch.**

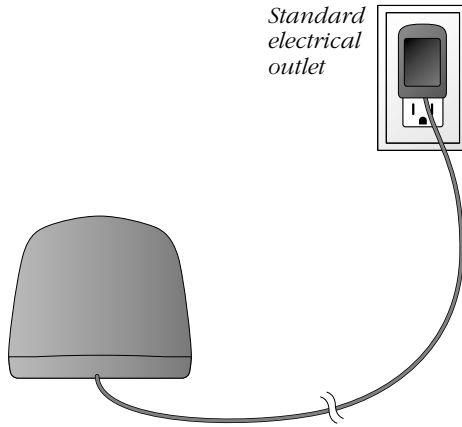

2 Install the handset battery.

Use only AT&T Battery 3301, SKU# 91076.

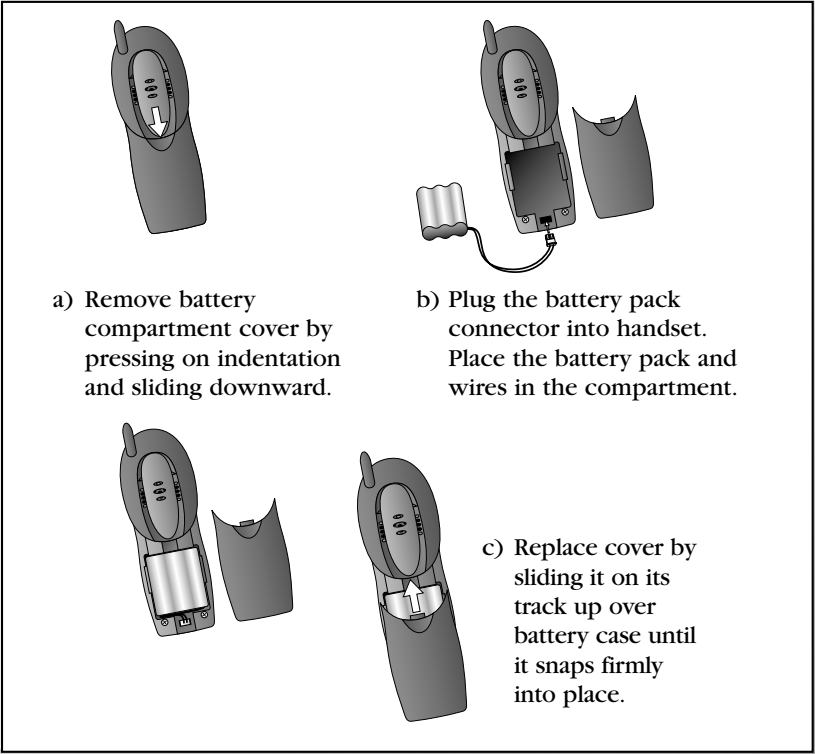

3 Charge the handset battery.

- Place the handset in the charging stand.
- Charge the battery at least 12 hours. After the first charge, the battery will charge in eight hours.

4 Register your handset.

After handset is *fully charged* place it in the base of your 2320, 2325, 2355, or 2365 telephone, it will automatically be registered and you will hear a single beep. If you try to register a fifth handset, registration will be blocked.

5 Check for dial tone.

Lift the handset and press **PHONE**; you should hear a dial tone.

Belt Clip

You can remove the belt clip from the handset.

Headset

You can use this telephone hands-free when you install any industry standard 2.5 mm headset (purchased separately). For best results use an AT&T 2.5 mm headset.

Plug the headset into the jack located on the right side of the handset (under the small rubber flap). Do not force the connection, but make sure the plug fits securely.

- a) Pull clip away from handset to remove.

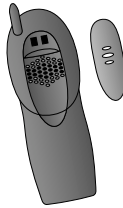

- b) Press tabs on belt clip into slots on back of handset to reattach.

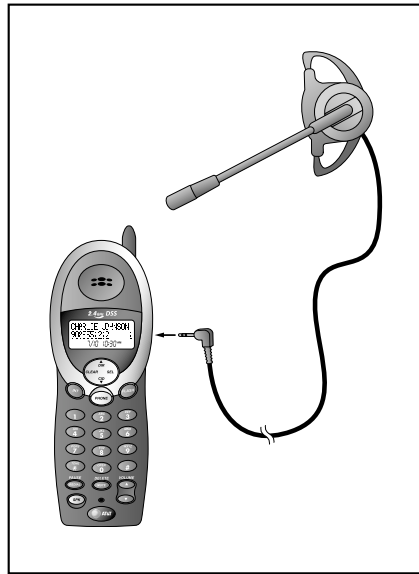
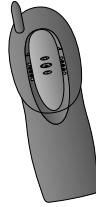

**FOR INSTRUCTIONS
TO SETUP AND OPERATE
THIS EXPANSION HANDSET,
REFER TO THE MANUAL
THAT CAME WITH YOUR
ORIGINAL BASE
TELEPHONE.**

DEFAULT SETTING

DEFAULT SETTINGS

<i>FUNCTION:</i>	<i>DEFAULT SETTING:</i>
Dial Method	Tone
Handset Volume	2
Ring Volume	6
External Ring Pattern	0
Internal Ring Pattern	1
Key Click	ON

TECHNICAL SPECIFICATIONS

TECHNICAL SPECIFICATIONS

Frequency Range	2400 MHz - 2483 MHz
Channels	95
Channel Spacing	864 kHz
Output Power	23 dBm
Sensitivity	-92 dBm
Modulation	GFSK
Operating Temperature	0°C - 40°C
Base Unit Voltage	96 - 144 Vrms (AC Voltage, 60Hz)
Base Unit Voltage	9 Vdc (AC Adapter Output)
Handset Voltage	3.6- 4.6 Vdc, 600mAh



