



User's manual

E2913B/E1113B **2.4 GHz cordless telephone/ answering system with caller ID/call waiting**



Congratulations

on purchasing
your new AT&T product.

Before using this AT&T product, please read the **Important safety instructions** on pages 55-57 of this manual.

Please thoroughly read the user's manual for all the feature operation and troubleshooting information you need to install and operate your new AT&T product. You can also visit our website at www.telephones.att.com or call 1 (800) 222-3111. In Canada dial 1 (866) 288-4268.

Model #: E2913B/E1113B

Product name: 2.4GHz cordless telephone/answering system

Serial #: _____

(found on the bottom of the telephone base)

Purchase date: _____

Place of purchase: _____

You must install and charge the battery before using the telephone.



See page 7
for easy instructions.

For customer service or product information, visit our website at www.telephones.att.com or call 1 (800) 222-3111. In Canada dial 1 (866) 288-4268.



CAUTION: To reduce the risk of fire or injury to persons or damage to the telephone, read and follow these instructions carefully:

- Use only the supplied rechargeable battery or replacement battery (model 27910, part number 89-0099-00-00) or equivalent. To order a replacement battery, visit our website at www.telephones.att.com or call 1 (800) 222-3111. In Canada dial 1 (866) 288-4268.
- Do not dispose of the battery in a fire. Like other batteries of this type, it could explode if burned. Check with local codes for special disposal instructions.
- Do not open or mutilate the battery. Released electrolyte is corrosive and may cause damage to the eyes or skin. It may be toxic if swallowed.
- Exercise care in handling batteries in order not to create a short circuit. Do not allow conductive materials such as rings, bracelets, or keys to touch the battery. The battery or conductor may overheat and cause harm.
- Charge the battery provided with or identified for use with this product only in accordance with the instructions and limitations specified in this manual.
- Observe proper polarity orientation between the battery and battery charger.
- Do not disassemble your telephone. There are no user-serviceable parts inside. Refer to qualified service personnel for servicing.

User's manual

E2913B/E1113B

2.4 GHz cordless telephone/ answering system with caller ID/call waiting



Table of contents

Getting started

Quick reference guide.....	2
Parts checklist.....	4
Telephone base installation.....	5
Battery installation & charging.....	7
Installation options.....	8
Belt clip & optional headset.....	10

Telephone operation

Basic operation.....	11
Options while on calls.....	14
Intercom.....	16
Intercom call transfer.....	17
Handset settings.....	18
Sounds.....	21
Display.....	22
Ringer volume.....	24

Directory

Directory.....	25
New directory entries.....	26
Directory search.....	28
To dial, delete or edit entries.....	30

Caller ID operation

Caller ID operation.....	31
To review the call log.....	34

Answering system operation

Answering system operation.....	35
Day & time announcements.....	36
Outgoing announcements.....	37
Changing feature options.....	38
Message playback.....	39
Recording & playing memos.....	40
Message counter displays.....	41
Answering system mode.....	42
Remote access.....	43

Appendix

Screen icons, indicator lights & tones.....	44
Handset display screen messages.....	45
Troubleshooting.....	47
Important safety instructions.....	55
FCC Part 68 & ACTA.....	58
FCC Part 15.....	60
Limited warranty.....	61
Technical specifications.....	64
Index.....	65

Quick reference guide

Cordless handset

▼ CID/-VOLUME

Press to scroll down while in menus. Press to display caller ID information (page 34). While entering names or numbers, press to move the cursor to the left (page 27). Press to decrease the listening volume while on a call (page 14).

PHONE/FLASH

Press to make or answer a call (page 11). During a call, press to receive an incoming call if call waiting is activated (page 14).

MUTE/DELETE

While on a call, press to mute microphone (page 15). While reviewing the call log, press to delete an individual entry, or press and hold to clear the caller ID log (page 34). While entering or editing a name or number, press to delete a character (page 26).

🔊 SPEAKER

Press to activate handset speakerphone. Press again to resume normal handset use (page 11).

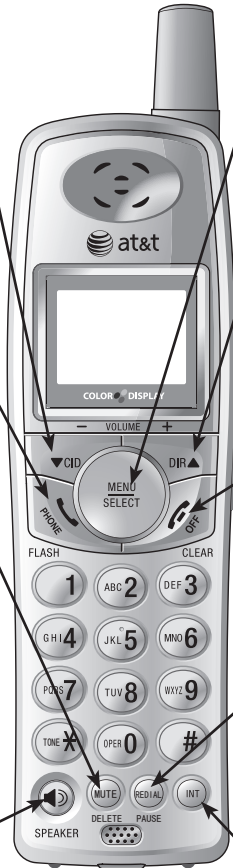

MENU/SELECT

Press to display the menu. Once in the menu, press to select an item or save an entry or setting.

DIR ▲/VOLUME+

Press to scroll up while in menus. Press to display directory entries (page 28). While entering names or numbers, press to move the cursor to the right (page 26). Press to increase the listening volume while on a call (page 14).

OFF/CLEAR

During a call, press to hang up. While using menus, press to cancel an operation, back up to the previous menu, or exit the menu display. While predialing, press to delete digits (page 11).

REDIAL/PAUSE

Press to view redial memory (page 12). While entering numbers, press and hold to insert a dialing pause (page 26).

INT

Press to initiate an intercom conversation between handsets. Press to transfer a call (pages 16-17).

Feature menu

☐ Shows a highlighted item



Menu

Feature menu

	DIRECTORY.....	Page 25
	CALL LOG.....	Page 31
	SETTINGS.....	Page 18
	SOUNDS.....	Page 21
	DISPLAY.....	Page 22
	RINGER VOLUME.....	Page 24

Using menus

Press ▼ **CID/-VOLUME** or **DIR ▲/VOLUME+** to scroll through menu items.

Press **MENU/SELECT** to select or modify a highlighted item.

Press **OFF/CLEAR** to cancel an operation, back up to the previous menu, or exit the menu display.

Quick reference guide

Telephone base

CHARGE/IN USE

- Flashes when another telephone on the same line or one of the handsets is in use.
- Flashes when the answering system is answering an incoming call.
- Flashes while an incoming call is ringing.
- On steady when the handset is properly positioned to charge in the telephone base.



HANDSET LOCATOR

Press to make handsets beep (page 13).

SETUP

Press to review or change answering system options (page 38).

MESSAGE COUNTER

Number of messages (or during playback, message number currently playing).

CLOCK

Press to review or set clock (page 36).

X/DELETE

Press to delete message currently playing; press and hold to delete all old messages (page 39).

◀/REPEAT

Press to repeat message; press **twice** to play previous message (page 39).

▶/PLAY/STOP

Press to start or stop message playback (page 39).

ANNC

Press to review or record announcement; press again to quit (page 37).

RECORD

Press to record a memo (page 40) or after pressing **ANNC** to record an outgoing announcement (page 37).

ANSWER ON

Press to turn answering system on or off (page 42).

▲/VOLUME

Press to adjust playback volume (page 39).

▶/SKIP

Press to skip message (page 39).

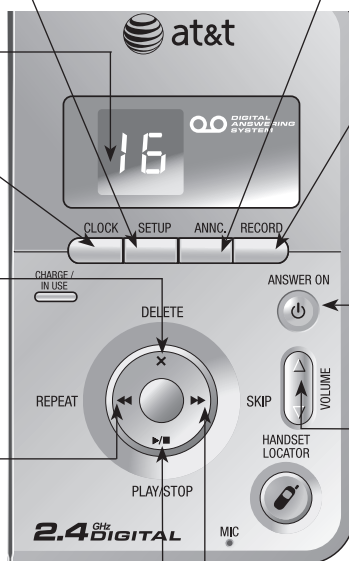

Getting started

Parts checklist

Save your sales receipt and original packaging in case it is necessary to ship your telephone for warranty service.

Check to make sure the telephone package includes the following:

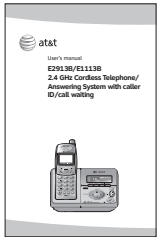

User's manual



Quick start guide



Cordless handsets



Telephone base with mounting bracket installed



Chargers for cordless handsets

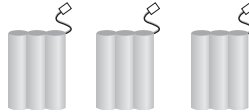

Batteries for cordless handsets



Battery compartment covers



Power adapter for telephone base

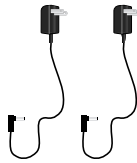

Power adapters for handset chargers



Belt clips for cordless handsets

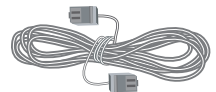

Telephone line cord

Telephone base installation

Choose a central location close to a telephone jack and an electrical outlet not connected to a wall switch. The telephone base can be placed on a flat surface or mounted on a standard wall plate. For optimum range and better reception, place the telephone base in a high and open location.

Avoid placing the telephone base too close to:

- Communication devices such as: personal computers, computer routers, television sets, VCRs, wireless routers (wireless broadband, wi-fi, or 802.11) or other cordless telephones.
- Excessive heat sources.
- Noise sources such as a window with traffic outside, motors, microwave ovens, refrigerators, or fluorescent lighting.
- Excessive dust sources such as a workshop or garage.
- Excessive moisture.
- Extremely low temperature.
- Mechanical vibration or shock such as on top of the washing machine or work bench.

Telephone base installation

1. Plug one end of the telephone line cord into the telephone jack at the bottom of the telephone base.
2. Plug the small end of the power adapter into the power jack at the bottom of the telephone base.
3. Route cords through slots.
4. Plug the large end of the power adapter into an electrical outlet not controlled by a wall switch.
5. Plug the other end of the telephone line cord into a telephone jack.

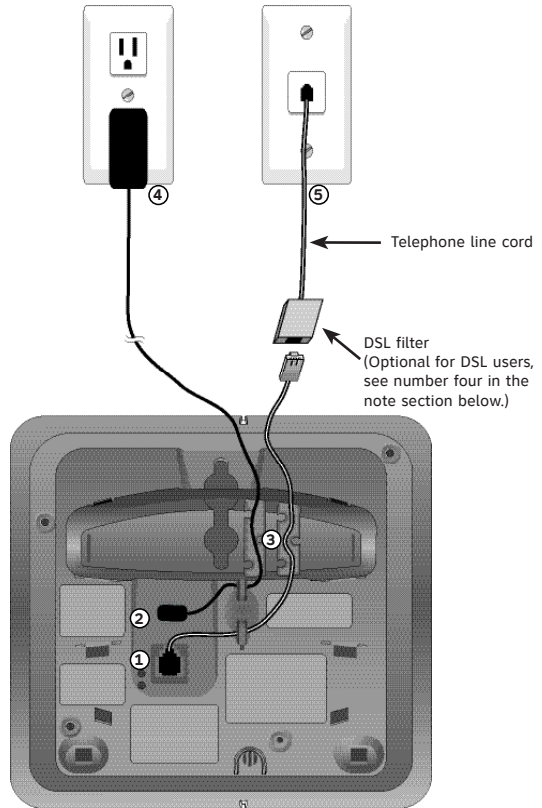

NOTES:

1. Use only the power adapter supplied with this product. To order a replacement power adapter, visit our website at www.telephones.att.com or call 1 (800) 222-3111. In Canada dial 1 (866) 288-4268.
2. Be sure to use an electrical outlet not controlled by a wall switch.
3. This power unit is intended to be correctly oriented in a vertical or floor mount position. The prongs are not designed to hold the plug in place if it is plugged into a ceiling, under-the-table or cabinet outlet.
4. If you receive high speed internet through your telephone line (commonly referred to as DSL), and you are experiencing interference during telephone conversations and/or your caller ID features are not functioning properly, install a DSL filter to the telephone line between the telephone base and the telephone wall jack. Contact your DSL service provider for a DSL filter.

Battery installation & charging

After installing the battery, you may be able to make and receive short calls. For best performance, place the handsets in the telephone base or the charger and charge for 16 hours before use.

You can keep the battery charged by returning the handsets to the telephone base or the charger after use. When the battery is fully depleted, a recharge takes about 12 hours. The average talk time on a fully charged battery is about eight hours, and the standby time is approximately five days. Actual battery life depends on usage conditions and age of battery.

1. Plug the small end of the smaller power adapter into the jack on the underside of the charger, then route the cord through the slot as shown.

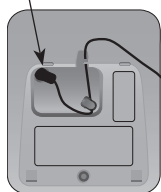

2. Plug the large end of the smaller power adapter into an electrical outlet not controlled by a wall switch.



3. Insert the plug as indicated. Be sure to securely insert the plug, making sure matches the color-coded label inside the battery compartment.

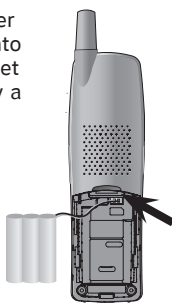

4. Place the battery pack and wires inside the compartment.



5. Slide the battery compartment cover up until it clicks.



6. You may be able to make and receive short calls. For best performance, place the handset in the telephone base or charger to charge for at least 16 hours before first use.

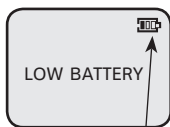

Low battery indicator

Return the handset to the telephone base or charger to recharge when this symbol flashes. (Handset will beep when battery is low.)

To replace the battery, press in and downward on the tab of the battery compartment to open the battery compartment cover. Lift out the old battery and disconnect it from the handset. Follow the instructions on this page to install and charge the new battery.



i **NOTE:** Under normal conditions, the battery should last around one year. This may vary depending on usage.

⚠ Caution: Use only the supplied rechargeable battery or replacement battery (model 27910, part number 89-0099-00-00) or equivalent. To order a replacement battery, visit our website at www.telephones.att.com or call 1 (800) 222-3111. In Canada dial 1 (866) 288-4268.

Installation options



NOTE: The mounting bracket must be used for both tabletop use and wall mounting positions.

Tabletop mount

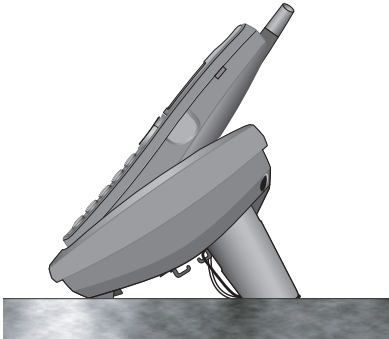

Wall mount

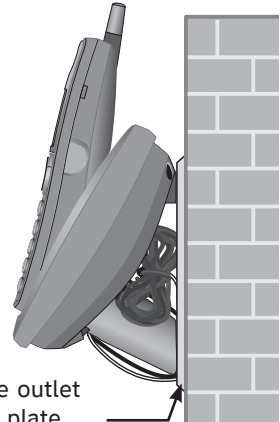

Telephone outlet
mounting plate
with mounting
studs

Wall mounting

The telephone base comes with the bracket mounted for tabletop use. If wall mounting is desired, a telephone outlet wall mounting plate with mounting studs is required. This mounting plate with studs may be available for purchase from many hardware or consumer electronics retailers and may require professional installation.

1. To remove the bracket, hold the telephone base in both hands, press the two bracket tabs and lift the bracket away from slots **a** and **b**.
2. Connect the telephone line cord and power adapter to the jacks on the bottom of the telephone base. Bundle the telephone cord, and secure it with a twist tie before placing it inside the bracket.

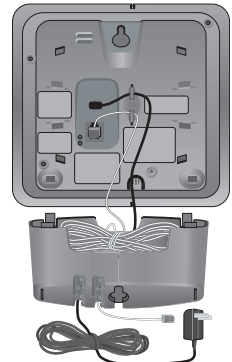
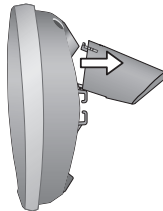
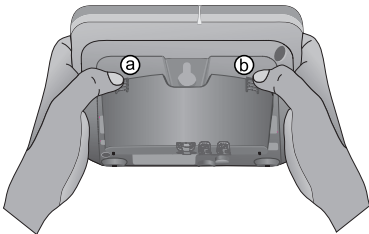

Installation options

3. To attach the bracket for wall mounting, insert the tabs of the bracket into slots ⑥ and ⑦ on the telephone base, then press the other bracket tabs into slots ⑧ and ⑨ as shown on the right.
4. Plug the power adapter into an electrical outlet not controlled by a wall switch. Plug the telephone line cord into a telephone wall jack. To mount the telephone on the wall, position the mounting holes ⑩ and ⑪ over the telephone outlet mounting studs. Press and slide the bracket down firmly so the telephone is held securely on the telephone outlet mounting studs.

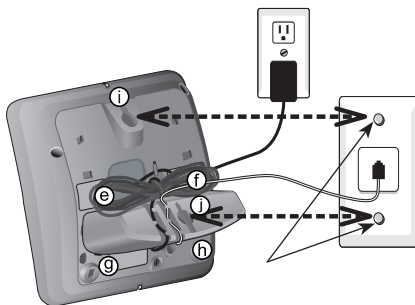

Telephone outlet mounting studs

Tabletop mounting

To return the bracket from the wall mount to tabletop position, follow the directions below.

1. Remove the telephone base from the wall. Unplug the cords from the wall jacks. Remove the bracket from the telephone base.
2. Insert the bracket tabs into slots ③ and ④ on the telephone base, then press the other bracket tabs into slots ① and ②.

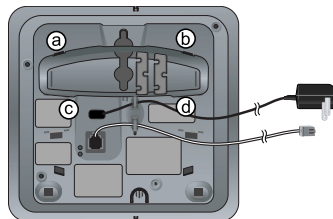
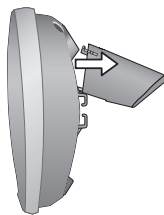
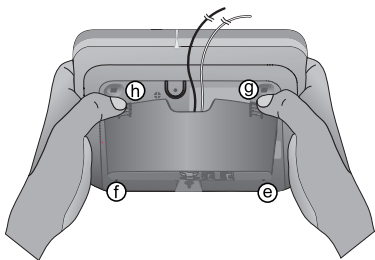

3. Route cords through slots. Plug the other end of the telephone line cord into a telephone wall jack. Plug the large end of the larger power adapter into an electrical outlet not controlled by a wall switch.

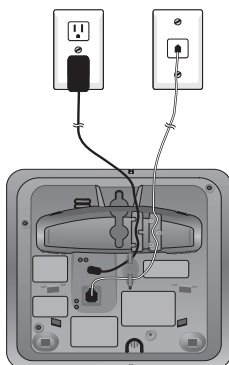

Belt clip & optional headset

Install belt clip as shown below if desired.

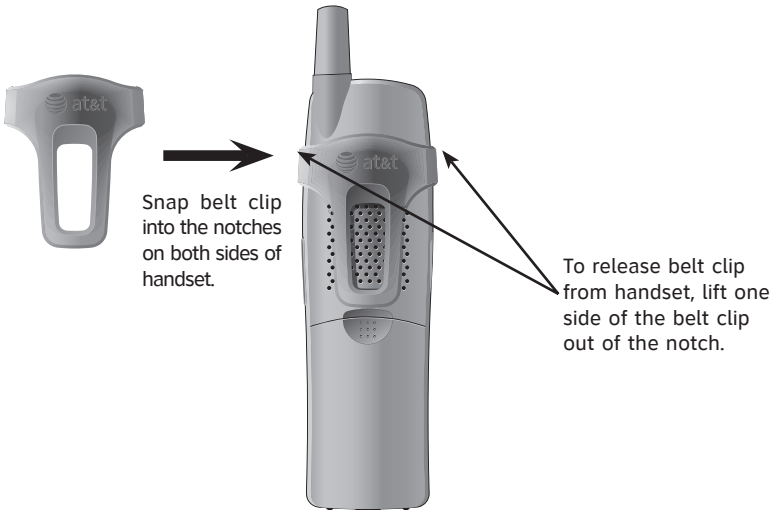

For hands-free telephone conversations, use any industry standard 2.5 mm headset (purchased separately). For best results, use an AT&T 2.5 mm headset. To order an AT&T 2.5 mm headset, visit our website at www.telephones.att.com or call 1 (800) 222-3111. In Canada dial 1 (866) 288-4268.

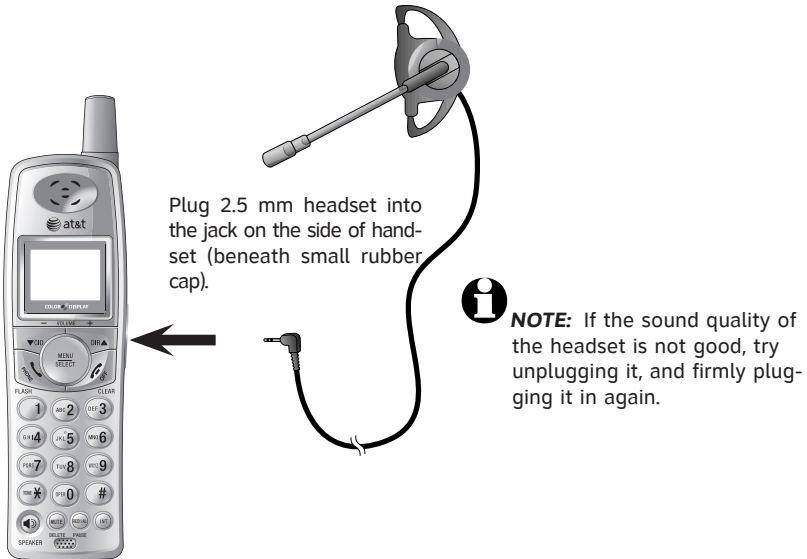

Basic operation

Making and answering calls

To answer an incoming call, press **PHONE/FLASH**, **SPEAKER** or any dial pad key (0-9, * or #) on the handset. To make a call, press **PHONE/FLASH** or **SPEAKER** then dial a number. Press **OFF/CLEAR** or place the handset in the telephone base or charger to hang up.

To predial (preview numbers before dialing), enter numbers first. Press **MUTE/DELETE** or **OFF/CLEAR** anytime to make corrections, then press **SPEAKER** or **PHONE/FLASH** to dial.

The screen displays the elapsed time as you talk (in hours, minutes and seconds).

NOTE: During a call, pressing **PHONE/FLASH** to access services from your local telephone company will not affect the elapsed time.

Hands-free speakerphone calls

To answer a call, press **SPEAKER**. To make a call, press **SPEAKER** then dial a number. During a call, press **SPEAKER** to alternate between hands-free speakerphone and normal handset use. Press **OFF/CLEAR** to hang up.

NOTE: If a headset is plugged into the handset, you will not be able to use the handset speakerphone. To use hands-free speakerphone, make sure the headset is unplugged, then press **SPEAKER** to activate the hands-free speakerphone.

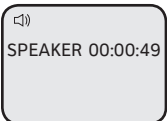
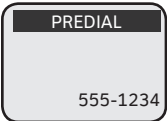

Basic operation

Last number redial



Press **REDIAL/PAUSE** to display the most recently called numbers (up to 32 digits). Press **▼CID/-VOLUME, DIR ▲/VOLUME+** or **REDIAL/PAUSE** repeatedly to view up to five recently called numbers. The handset beeps twice at the beginning or end of the list. Press **↵OFF/CLEAR** to exit. Press **⏻SPEAKER** or **📞PHONE/FLASH** to redial any displayed number. Or press **📞PHONE/FLASH** or **⏻SPEAKER** then **REDIAL/PAUSE** to dial the most recently called number (up to 32 digits).

Press **MUTE/DELETE** to delete the displayed number from the redial memory.

Temporary ring silencing

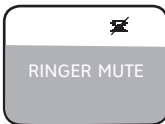





Press **↵OFF/CLEAR** or **MUTE/DELETE** while the telephone is ringing to silence the handset ringer temporarily. This will silence the ringer without disconnecting the call. You can answer the call or let the caller leave a message in your answering system. The next incoming call will ring normally.



NOTE: All handsets will ring with an incoming call. Pressing **↵OFF/CLEAR** or **MUTE/DELETE** on one handset will only silence the ringer of that particular handset but the other handsets will continue to ring.

Basic operation

Handset locator

If the handsets are misplaced, press  **HANDSET LOCATOR** on the telephone base. The handsets will play a paging tone for 60 seconds to help you locate them. To stop the paging tone, press  **PHONE/FLASH**,  **SPEAKER**, or any dial pad key (0-9, *, or #) on the handsets, or press  **HANDSET LOCATOR** on the telephone base.



NOTES:

1. If the handset ringer is set to off (0), the handset locator feature is not available on that handset (page 24).
2. During a page, pressing  **OFF/CLEAR** or **MUTE/DELETE** on the handset (page 12), the ringer of that handset will be silenced, but it will not cancel the page.



Options while on calls

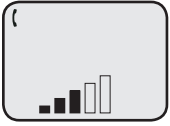

Volume control

Press **▼CID/-VOLUME** to decrease the volume.
Press **DIR▲/VOLUME+** to increase the volume.
When changing the volume level, the new setting is saved.



NOTE: The earpiece, hands-free speakerphone and headset listening volume are adjusted separately.

Call waiting

If you subscribe to call waiting service with your local telephone company, there will be a beep if there is an incoming call while you are already on a call. Press **PHONE/FLASH** to put your current call on hold and take the new call. Press **PHONE/FLASH** anytime to switch back and forth between calls. For more information on caller ID, see page 31.

Multiple handset use

While on a call, a person on another handset can press **PHONE/FLASH** or **SPEAKER** to join the same conversation.

A person on either handset can press **OFF/CLEAR**, or place the handset in the telephone base or charger to drop out of the call, but the call will not be terminated until both handsets hang up.



NOTES:

1. At any time, a maximum of two handsets can be used on the same outside call.
2. When two handsets are used on the same outside call, the call transfer feature cannot be used (page 17).

Options while on calls

Mute

Press **MUTE/DELETE** to silence the microphone. When mute is on,  will show on the handset screen. You will be able to hear the caller, but your caller will not be able to hear you until you press **MUTE/DELETE** again and resume speaking. When mute is turned off, **MICROPHONE ON** will show temporarily on the handset screen. Mute is automatically cancelled when you end a call.



Temporary tone dialing

If you have only dial pulse (rotary) service, you can temporarily switch to touch tone dialing during a call by pressing **TONE/***. This can be useful when sending tone signals for access to answering systems or long distance services.

After you hang up or press **PHONE/FLASH** (to receive a call waiting call), the telephone automatically returns to dial pulse (rotary) service.

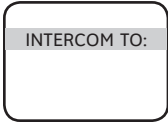

i **NOTE:** At any time, a maximum of two handsets can be used on an intercom call, and another handset can be used on an outside call at the same time.

Intercom

Use the intercom feature for conversations between handsets.

1. Press **INT**. The screen of the originating handset will show **INTERCOM TO:**.
2. Enter the handset number of the destination handset (1, 2 or 3). The display will show **CALLING HANDSET X**. The destination handset will ring, and its screen will show **HANDSET X IS CALLING**.

i **NOTES:**

- Before the intercom call is answered, you can cancel the intercom call by pressing **OFF/CLEAR** or **INT**.
- If the destination handset is not answered within 100 seconds or if it is in the directory or call log mode, or out of range, the originating handset will show the message **NOT AVAILABLE**.

3. On the ringing destination handset, press **PHONE/FLASH**, **INT**, **SPEAKER**, or any dial pad key (0-9, * or #) to answer the intercom call.

i **NOTE:** On the ringing destination handset, pressing **OFF/CLEAR** or **MUTE/DELETE** will temporarily silence the intercom ringer.

To end the intercom call:

- Press **OFF/CLEAR** or **INT** on either handset.
- OR-**
- Place either handset in the charger or telephone base.

Handling incoming calls

The telephone will beep if you receive an outside call during an intercom conversation. You can either:

- Press **PHONE/FLASH** to end the intercom call and answer the incoming call.
- OR-**
- Press **INT** or **OFF/CLEAR** to disconnect the intercom connection without answering the incoming call. The incoming call will continue to ring.

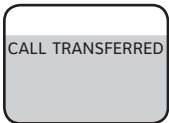
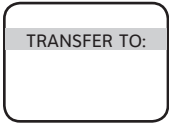
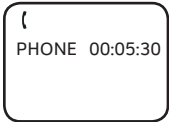

Intercom call transfer

Use the intercom feature to transfer an external call from one handset to another.

1. During a conversation with an external call, press **INT**. The external call is automatically placed on hold. The originating handset's screen will show **TRANSFER TO:**.
2. Enter the handset number of the destination handset (1, 2 or 3). The display will show **CALLING HANDSET X**. The destination handset will ring, and its screen will show **HANDSET X IS CALLING**.
3. On the ringing destination handset, press **PHONE/FLASH**, **INT**, **SPEAKER**, or any dial pad key (0-9, * or #) to answer the intercom call. You can now talk without the external caller hearing the conversation.



NOTES:

- You can alternate between the intercom call and the outside call by pressing **INT** on the originating handset. The display will alternate between **INTERCOM** and **OUTSIDE** to indicate which party is active.
- You can end the intercom call and return to the external call by pressing **PHONE/FLASH** on the originating handset.
- The person on the destination handset can join the external call by pressing **PHONE/FLASH**, connecting both handsets to the outside call.
- To allow the person on the destination handset to join the external call, press and hold **INT** on the originating handset.



NOTES:

1. Before the intercom call is answered, you can cancel the transfer and return to the external call by pressing **OFF/CLEAR**, **PHONE/FLASH**, or **INT**.
2. If the destination handset does not answer the intercom call within 100 seconds, or if the other handset is in the directory or call log mode, or out of range, the originating handset will show **NOT AVAILABLE** on its screen and will automatically return to the external call.
4. Complete the transfer by pressing **OFF/CLEAR** on the originating handset or placing that handset in the telephone base or charger. The originating handset's screen will show **CALL TRANSFERRED** and the other handset will automatically be connected to the external call.



Settings

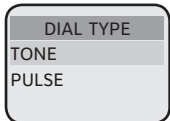
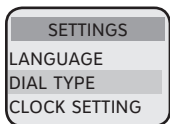
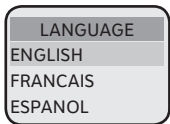
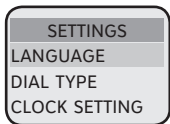
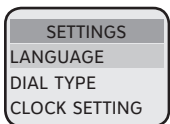

In the **SETTINGS** menu, you can change the language, dial type, and clock setting. You can also clear the voice mail indication.

1. Press **MENU/SELECT** in idle mode to enter the feature menu.
2. Press **▼CID/-VOLUME** to highlight **SETTINGS**, then press **MENU/SELECT** to enter the **SETTINGS** menu.
3. Press **▼CID/-VOLUME** or **DIR ▲/VOLUME+** to scroll through the **SETTINGS** menu, then press **MENU/SELECT** to select the desired option.

To cancel an operation, back up to the previous menu, or exit the menu display press **OFF/CLEAR**. To return to the idle mode press and hold **OFF/CLEAR**.

Language

In this menu, you can select the language used in all screen displays.

1. In the **SETTINGS** menu, press **▼CID/-VOLUME** or **DIR ▲/VOLUME+** to highlight **LANGUAGE**, then press **MENU/SELECT**.
2. Press **▼CID/-VOLUME** or **DIR ▲/VOLUME+** to highlight **ENGLISH**, **FRANCAIS** or **ESPANOL**.
3. Press **MENU/SELECT** to save your preference and be returned to **SETTINGS**.

Dial type

In this menu, you can choose **TONE** or **PULSE** (rotary service) dialing. The factory default setting is **TONE**. Change this to **PULSE** only if you do not have touch-tone dialing service.

1. In the **SETTINGS** menu, press **▼CID/-VOLUME** or **DIR ▲/VOLUME+** to highlight **DIAL TYPE**, then press **MENU/SELECT**.
2. Press **▼CID/-VOLUME** or **DIR ▲/VOLUME+** to highlight **TONE** or **PULSE**.
3. Press **MENU/SELECT** to save your preference and be returned to **SETTINGS**.



NOTE: Changing the dial type on one handset will change the dial type on all registered handsets.



Settings

Clock setting

If you subscribe to caller ID service provided by your local telephone company, the time will automatically be set by an incoming call.

In this menu, you can choose to set the time displayed on the handset screen.

To cancel an operation, back up to the previous menu, or exit the menu display press **OFF/CLEAR**. To return to the idle mode press and hold **OFF/CLEAR**.

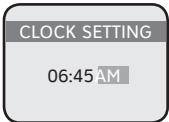
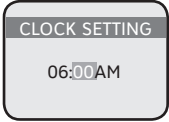
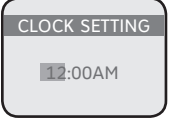
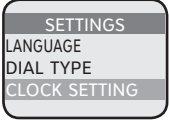

1. Press **MENU/SELECT** in idle mode to enter the feature menu.
2. Press **▼CID/-VOLUME** to highlight **SETTINGS**, then press **MENU/SELECT** to enter the **SETTINGS** menu.
3. Press **▼CID/-VOLUME** or **DIR ▲/VOLUME+** to highlight **CLOCK SETTING**, then press **MENU/SELECT**.
4. Use the dial pad keys (0-9) to enter two digits for the hour (01-12). You can also press **▼CID/-VOLUME** or **DIR ▲/VOLUME+** to set the hour.
5. Press **MENU/SELECT**.
6. Use the dial pad keys (0-9) to enter two digits for the minute (00-59). You can also press **▼CID/-VOLUME** or **DIR ▲/VOLUME+** to set the minute.
7. Press **MENU/SELECT**.
8. Press **▼CID/-VOLUME** or **DIR ▲/VOLUME+** to set **AM** or **PM**.
9. Press **MENU/SELECT** to confirm the clock setting and be returned to **SETTINGS**.



NOTE: Caller ID provides the time. The time will be set automatically only if you subscribe to caller ID service provided by your local telephone company (page 32).



Settings

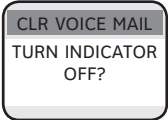
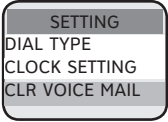



Clear voice mail indication

If you subscribe to voice mail services provided by your local telephone company, **NEW VOICE MAIL** and the  icon will appear on all handset screens when you have new voice mail.

To cancel an operation, back up to the previous menu, or exit the menu display press **OFF/CLEAR**. To return to the idle mode press and hold **OFF/CLEAR**.

To manually turn off the **NEW VOICE MAIL** message, the  icon and **VOICEMAIL** light:

1. Press **MENU/SELECT** in idle mode to enter the feature menu.
2. Press **▼CID/-VOLUME** to highlight **SETTINGS**, then press **MENU/SELECT** to enter the **SETTINGS** menu.
3. Press **▼CID/-VOLUME** or **DIR▲/VOLUME+** to highlight **CLR VOICE MAIL**.
4. Press **MENU/SELECT**.
5. Press **MENU/SELECT** again to remove the displayed message, or press  **OFF/CLEAR** to exit.

This only turns off the displayed **NEW VOICE MAIL** message and the  icon on all cordless handset screens. It does not delete the voice mail message(s).

Use this feature when the telephone indicates there is voice mail when you have none, or when you have accessed your voice mail from a different telephone line (away from home). If there is actually a new voice mail message, your local telephone company will continue to send the signal which will cause the **NEW VOICE MAIL** message and the  icon to be displayed again.



NOTE: When you make a call a pulsing (stutter) dial tone may alert you to a voice mail message from your telephone company.

Sounds



In the **SOUNDS** menu, you can choose one of ten ringer melodies, and turn the key tone on or off.

To cancel an operation, back up to the previous menu, or exit the menu display press **OFF/CLEAR**. To return to the idle mode press and hold **OFF/CLEAR**.

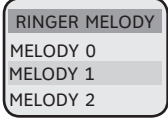
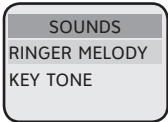

Ringer melody

To choose a ringer melody:

1. Press **MENU/SELECT** in idle mode to enter the feature menu.
2. Use the **▼CID/-VOLUME** or **DIR ▲/VOLUME+** keys to highlight **SOUNDS**, then press **MENU/SELECT** to enter **SOUNDS** menu.
3. Press **MENU/SELECT** again to select **RINGER MELODY**.
4. Press **▼CID/-VOLUME** or **DIR ▲/VOLUME+** to hear the melody options.
5. Press **MENU/SELECT** to save your preference and be returned to **SOUNDS**.

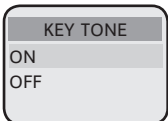
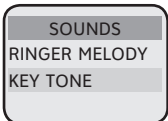

Key tone

The handset is preset to beep with each key press. If you turn off the **KEY TONE**, there will be no beeps when keys are pressed.

To turn the **KEY TONE** on or off:

1. Press **MENU/SELECT** in idle mode to enter the feature menu.
2. Use the **▼CID/-VOLUME** or **DIR ▲/VOLUME+** keys to highlight **SOUNDS**, then press **MENU/SELECT** to enter the **SOUNDS** menu.
3. Press **▼CID/-VOLUME** to highlight **KEY TONE**, then press **MENU/SELECT** to select **KEY TONE**.
4. Press **▼CID/-VOLUME** or **DIR ▲/VOLUME+** to highlight **ON** or **OFF**.
5. Press **MENU/SELECT** to save your preference and be returned to **SOUNDS**.



Display

To cancel an operation, back up to the previous menu, or exit the menu display press **OFF/CLEAR**. To return to the idle mode press and hold **OFF/CLEAR**.

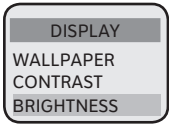
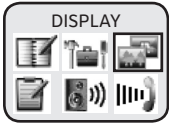

Brightness

To adjust the screen brightness on the handset:

1. Press **MENU/SELECT** to enter the feature menu.
2. Press **▼CID/-VOLUME** or **DIR ▲/VOLUME+** to scroll to **DISPLAY**, then press **MENU/SELECT** to enter the **DISPLAY** menu.
3. Press **▼CID/-VOLUME** or **DIR ▲/VOLUME+** to highlight **BRIGHTNESS**, then press **MENU/SELECT**.
4. Press **▼CID/-VOLUME** or **DIR ▲/VOLUME+** to view a sample of each brightness level.
5. Press **MENU/SELECT** to save your preference and return to **DISPLAY**.



NOTE: When the handset is idle and no keys have been pressed for 15 seconds, the handset display background will appear black to save battery power.

Ringer volume



In this menu, you can set the ringer volume level (1-6), or turn the ringer off (0). When the ringer is turned off, the  will appear on the handset screen.

The ringer volume level also determines the ringer volume for intercom calls (page 16) and the paging tone when initiating the handset locator feature (page 13). If the ringer volume level is set to off (0) on a handset, that handset is silenced for all incoming calls and paging.

To cancel an operation, back up to the previous menu, or exit the menu display press **OFF/CLEAR**. To return to the idle mode press and hold **OFF/CLEAR**.

To adjust the **RINGER VOLUME**:

1. Press **MENU/SELECT** in idle mode to enter the feature menu.
2. Use the **▼CID/-VOLUME** or **DIR▲/VOLUME+** keys to highlight **RINGER VOLUME**, then press **MENU/SELECT** to enter the **RINGER VOLUME** menu.
3. Press **▼CID/-VOLUME** or **DIR▲/VOLUME+** to hear the ringer levels.
4. Press **MENU/SELECT** to save your preference and be returned to the feature menu.



Directory

Shared directory

The directory is stored in the telephone base, and is shared by all handsets. Changes made to the directory on any one handset will be applied to all.



NOTE: Only one handset can review the directory or caller ID log at a time. If another handset attempts to enter the directory, it will display **NOT AVAILABLE AT THIS TIME**.

Memory capacity

The directory can store up to 50 entries. Each entry can contain a number up to 32 digits, and a name up to 16 letters. A convenient search feature can help you find and dial numbers quickly (page 29).

If all memory locations are in use, the screen will display **LIST FULL**. You will not be able to store a new number until you delete an existing one.

Exiting the directory

Press **OFF/CLEAR** to cancel an operation, back up to the previous menu, or exit the menu display. Press and hold **OFF/CLEAR** to return to the idle mode.

If you pause for too long while creating an entry, the procedure will time out and you will have to begin again.

New directory entries



To cancel an operation, back up to the previous menu, or exit the menu display press **OFF/CLEAR**. To return to the idle mode press and hold **OFF/CLEAR**.

To create and store a new directory entry

1. Press **MENU/SELECT** in idle mode to enter the feature menu.
 2. Press **MENU/SELECT** again to enter the **DIRECTORY** menu.
 3. Press **▼CID/-VOLUME** to highlight **STORE**.
 4. Press **MENU/SELECT**.
 5. Enter the telephone number when prompted.
 - Use the dial pad to enter up to 32 digits.
 - Press **▼CID/-VOLUME** or **DIR▲/VOLUME+** to move the cursor to the left or right.
 - Press **MUTE/DELETE** to erase numbers.
 - Press and hold **REDIAL/PAUSE** to enter a three-second dialing pause, (a **p** appears on the screen), if you need to pause for accessing banking or long distance services.
- OR-**
- Copy a number from redial by pressing **REDIAL/PAUSE** then press **▼CID/-VOLUME** or **DIR▲/VOLUME+** to locate the number to copy. Press **MENU/SELECT** to copy the number.
6. Press **MENU/SELECT** to save the number. The display will show **ALREADY SAVED** if the number is already in the directory.



NOTE: Each line can hold 16 digits, so if you enter a number longer than 16 digits, the numbers will be displayed in the following line.

New directory entries



NOTE: The handset will automatically capitalize the first letter of every word.



7. Enter the name when prompted.

- Use the dial pad to enter a name (up to 16 characters). Each time a key is pressed, the character on that key will be displayed. Additional key presses will produce other characters on that key. See the chart below.
 - Press **▼CID/-VOLUME** or **DIR▲/VOLUME+** to move the cursor to the left or right.
 - Press **MUTE/DELETE** to erase letters.

Dial Key	Characters by number of key presses								
1	1	2	3	4	5	6	7	8	9
2	A	B	C	2	a	b	c		
3	D	E	F	3	d	e	f		
4	G	H	I	4	g	h	i		
5	J	K	L	5	j	k	l		
6	M	N	O	6	m	n	o		
7	P	Q	R	S	7	p	q	r	s
8	T	U	V	8	t	u	v		
9	W	X	Y	Z	9	w	x	y	z
0	0								
*	*	?	!	/	()	@		
#	space								

8. Press **MENU/SELECT** to store your new directory entry. The name and the telephone number will then be shown on the screen. To change it later, see page 30.
9. Press **OFF/CLEAR** to return to the **DIRECTORY** menu. Press and hold **OFF/CLEAR** to return to the idle mode.

Directory search

To cancel an operation, back up to the previous menu, or exit the menu display press **OFF/CLEAR**. To return to the idle mode press and hold **OFF/CLEAR**.



To browse through the directory

1. Press **DIR** in idle mode to display the first listing in the directory. **DIRECTORY EMPTY** will be displayed if there are no directory entries.

-OR-

You can also display the first listing in the directory by first pressing **MENU/SELECT**, then **MENU/SELECT** to choose **DIRECTORY**, then press **MENU/SELECT** again to choose **REVIEW**.

2. Press **▼CID/-VOLUME** or **DIR ▲/VOLUME+** to browse through the directory. Entries will be displayed alphabetically by the first letter in the name.

Directory search

To cancel an operation, back up to the previous menu, or exit the menu display press **OFF/CLEAR**. To return to the idle mode press and hold OFF/CLEAR.



To search by name

1. Press **DIR** in idle mode to display the first listing in the directory. **DIRECTORY EMPTY** will be displayed if there are no directory entries.
2. When a name entry is displayed, press a dial pad keys (2-9) to start a quick name search.

The directory will display the first name beginning with the first letter associated with the dial pad key, if there is an entry in the directory that begins with that letter.

3. To see other names that start with the letters on the dial pad key, keep pressing the key. The names will be shown in alphabetical order.

For example, if you have name entries **Jennifer**, **Jessie**, **Kevin** and **Linda** in your directory:

- If you press **5 (JKL)** once, you will see **Jennifer**.
- If you press **5 (JKL)** twice, you will see **Jessie**.
- If you press **5 (JKL)** three times, you will see **Kevin**.
- If you press **5 (JKL)** four times, you will see **Linda**.
- If you press **5 (JKL)** five times, you will see **Jennifer** again.



NOTES:

1. If there is no name entry matching the first letter of the key you press, you will see a name entry that matches the next letter of the key.
2. If you press a key (2-9) and there is no name entry to match those letters, the directory will show the entry that matches the next available letter in the directory.

To dial, delete or change entries

To dial, delete or change a directory entry (name and number), the entry must be displayed on the handset. Use directory search (pages 28-29) to display an entry. To exit the directory press **OFF/CLEAR**.

To dial a displayed number

When a directory entry is displayed, press **PHONE/FLASH** or **SPEAKER** to dial the displayed number.

To delete an entry

When a directory entry is displayed, press **MUTE/DELETE** to delete the displayed entry from the directory. Once deleted, an entry cannot be retrieved.

To change an entry

When a directory entry is displayed:

1. Press **MENU/SELECT** to modify the entry. You will be prompted to **EDIT NUMBER**.
 - Press the dial pad keys to add digits.
 - Press **MUTE/DELETE** to erase digits.
 - Press **▼CID/-VOLUME** or **DIR▲/VOLUME+** to move the cursor.
 - Press and hold **REDIAL/PAUSE** to add a three-second pause if desired.
 - Press **REDIAL/PAUSE**, then **▼CID/-VOLUME** or **DIR▲/VOLUME+** to scroll to a previously dialed number. Press **MENU/SELECT** to add the redial number to the entry.
2. Press **MENU/SELECT**. You will be prompted to **EDIT NAME**.
 - Press the dial pad keys to add characters (page 27).
 - Press **MUTE/DELETE** to erase characters.
 - Press **▼CID/-VOLUME** or **DIR▲/VOLUME+** to move the cursor.
3. Press **MENU/SELECT** to confirm.
4. Press **OFF/CLEAR** to return to the **DIRECTORY** menu. Press and hold **OFF/CLEAR** to return to the idle mode.

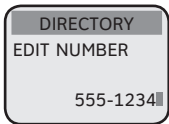
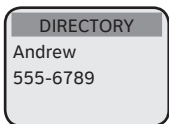



Caller ID operation

Information about caller ID with call waiting

This product has a caller ID function with call waiting feature which works with service from your local telephone company.

Caller ID with call waiting lets you see the name and telephone number of the caller before answering the telephone, even while on another call.

It may be necessary to change your telephone service to use this feature. Contact your telephone company if:

- You have both caller ID and call waiting, but as separate services (you may need combined service).
- You have only caller ID service, or only call waiting service.
- You do not have any caller ID or call waiting services.

This product can be used with regular caller ID service, or this product's other features can be used without subscribing to either caller ID or combined caller ID with call waiting service.

There are fees for caller ID services. In addition, services may not be available in all areas.

Depending on your service, the caller's number, or the caller's name and number may be displayed. This product can provide information only if both you and the caller are in areas offering caller ID service and if both telephone companies use compatible equipment. The time and date are sent by the telephone company along with the call information.



Caller ID operation

Shared caller ID log

The caller ID log is stored in the telephone base, and is shared by all handsets. Changes made on any handset will apply to all.



NOTE: Only one handset can review the directory or caller ID log at a time. If the other handset attempts to enter the call log, its screen will display **NOT AVAILABLE AT THIS TIME.**

How caller ID works

If you subscribe to caller ID service provided by your local telephone company, information about each caller will be displayed between the first and second ring.

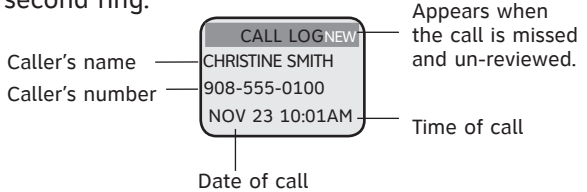

Information about the last 50 incoming calls is stored in the call log. You can review the call log to find out who has called and return the call or save the caller's name and number into the directory.

When the call log is full, the oldest entry is deleted to make room for new incoming call information.

If a call is answered before the information appears on the screen, it will not be saved in the call log.



NOTE: Caller ID features will work only if both you and the caller are in areas offering caller ID service, and if both telephone companies use compatible equipment.

Caller ID operation



Memory match

Names of callers will be displayed only if the information is provided by your local telephone company.

If the telephone number of the caller exactly matches a telephone number in your directory, the name that appears on the screen will match the corresponding name already in the directory.

Example: If Christine Smith calls, her name will appear as Chris if this is how it was entered in the directory.



NOTE: The number shown in your caller ID will be in the format sent by the telephone company. The telephone company usually delivers ten-digit telephone numbers (area code plus telephone number). If the telephone number of the person calling does not exactly match a number in your directory, the name will appear as delivered by the telephone company. For example if the telephone company includes the area code and the directory number does not, the name will appear as delivered by the telephone company.

Missed calls

When a handset is in idle mode with un-reviewed calls, its screen will show **XX MISSED CALLS**.

Un-reviewed entries will be counted as missed calls when the telephone is idle. Each time a call log entry marked **NEW** is reviewed, the number of missed calls decreases by one.

If there are too many missed calls and you don't want to review them one by one but still want to keep them in the caller ID log, press and hold **OFF/CLEAR** for four seconds when the handset is idle. All un-reviewed entries in the caller ID log will be considered old and the counter is reset to 0.

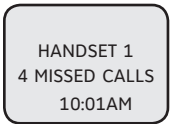

To review the call log

To review the call log

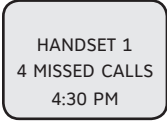

CID

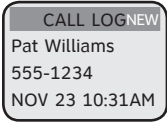

▼

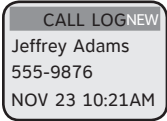

▼



PHONE

- OR -

#



#



#



PHONE

Press **▼CID/-VOLUME** to review the call log. The call log displays the caller ID entries in reverse chronological order. The most recent call is displayed first. Press **▼CID/-VOLUME** or **DIR ▲/VOLUME+** to scroll through the list as shown at left. Press **⏏OFF/CLEAR** to return to the idle screen.



NOTE: You can also display the caller ID entries in the call log, when handset is idle, press **MENU/SELECT**, then **▼CID/-VOLUME** to choose **CALL LOG**, and then press **MENU/SELECT**.

To return a call

Press **☎PHONE/FLASH** or **🔊SPEAKER** to call the displayed number.

Caller ID numbers may appear with an area code that may not be required for local calls, or without a **1** that may be needed for long distance calls. If the number displayed is not in the correct format, you can change how it is dialed.

To change the number before dialing, press **#** repeatedly to see different dialing options (you can choose to dial with or without an area code, and with or without the **1**), then press **☎PHONE/FLASH** or **🔊SPEAKER** to dial the number.

Other options while reviewing the call log

- Press **MUTE/DELETE** to delete the current entry from the call log.
- Press and hold **MUTE/DELETE** to delete all entries from the call log. When asked to confirm, press **MENU/SELECT** to delete all entries, or press **⏏OFF/CLEAR** to exit without deleting any entries.
- Press **MENU/SELECT** to copy this entry into the directory. If the name or number is not provided, you will be prompted to enter them (page 27). Press and hold **⏏OFF/CLEAR** to return to the idle screen.



NOTE: If neither the name nor number are not provided, **UNABLE TO SAVE** will be displayed.

Answering system operation

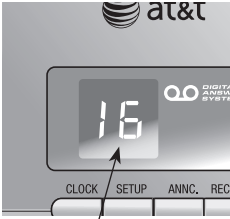

Message counter

Number of messages (or during playback, message number currently playing)

Message capacity

The answering system can record up to 99 messages depending on the length of each message. Individual messages can be up to four minutes long, and total maximum recording time is 14 minutes. Messages will remain available for replay until you delete them.

Voice prompts

Each time you press any answering system key, the answering system uses voice prompts to guide you.

Press repeatedly to hear setup options (page 38).

Press to review or set clock (page 36).

Press to delete message currently playing, **press and hold** to delete all old messages (page 39).

Press to repeat message; press twice to play previous message (page 39).

Press to start or stop message playback (page 39).

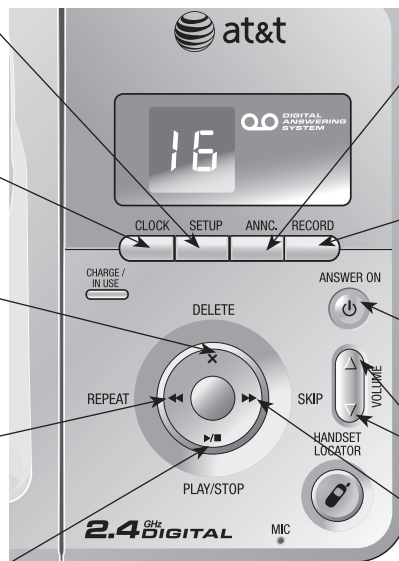

Press to review or record announcement, press again to quit (page 37).

Press to record a memo (page 40) or after pressing **ANNC** to record an outgoing announcement (page 37).

Press to turn answering system on or off (page 42).

Press to adjust playback volume (page 39).

Press to skip message (page 39).



Day & time announcements

To set day and time

Before playing each message, the answering system announces the day and time when the message was received.

Before using the answering system, follow the steps on the left of this page to set the day, time and year, so that messages are dated correctly. If the clock is not set, before new messages are recorded, the system will announce "Time and day not set" before each message is played back.

Caller ID provides the time and date. Set the year so that the day of the week can be calculated from the caller ID information. After you set the time once, it will thereafter be set automatically with incoming caller ID information. The time will be set automatically only if you subscribe to caller ID service provided by your local telephone company (page 32).

The system uses voice prompts to guide you. Each time you press **▶▶SKIP** or **◀◀REPEAT**, the day, hour, minute or year increases or decreases by one. When you hear the correct setting, press **CLOCK** to move to the next setting, or press **PLAY/STOP** to exit the clock menu.

1. **CLOCK**

The system will announce the current clock setting, then announces "To set the clock, press **CLOCK**."

2. **CLOCK**

The system will announce the current year setting, then announces "To change the year, press **SKIP** or **REPEAT**, to change the hour, press **CLOCK**."

3. **▶▶SKIP** or **◀◀REPEAT**

until the system announces the correct year, then press **CLOCK**.

4. **▶▶SKIP** or **◀◀REPEAT**

until the system announces the correct hour, then press **CLOCK**.

5. **▶▶SKIP** or **◀◀REPEAT**

until the system announces the correct minutes, then press **CLOCK**.

6. **▶▶SKIP** or **◀◀REPEAT**

until the system announces the correct day, then press **CLOCK**. The system announces the current clock setting.

To check day and time

You can press **CLOCK** at any time to hear the current day and time without changing it.



NOTE: You can press and hold **▶▶SKIP** or **◀◀REPEAT** to increase or decrease the minutes or years by increments of ten.



Elapsed recording time (seconds).

Press to stop recording.

1. **ANNC**

"Announcement. Press **PLAY** or press **RECORD**."

2. **▶/■ PLAY/STOP**

(Plays announcement previously recorded).

-OR-

1. **ANNC**

"Announcement. Press **PLAY** or press **RECORD**."

2. **RECORD**

"Record after the tone. Press **STOP** when you are done."

3. Speak into microphone.



Microphone

4. **▶/■ PLAY/STOP**

(Announcement is played back).

5. **ANNC**

to exit announcement recording.

Outgoing announcements

The outgoing announcement is the message callers hear when calls are answered by the answering system.

The telephone is factory set with an announcement. If the telephone is set up to record messages, it answers calls with "Hello. Please leave a message after the tone." You can use this announcement, or replace it with a recording of your own voice.

To play your outgoing announcement

Press **ANNC**, then you will hear "Announcement. Press **PLAY** or press **RECORD**." Press **▶/■ PLAY/STOP**. You will hear the outgoing announcement. Press **ANNC** to exit the announcement menu.

To record your outgoing announcement

Press **ANNC**, then you will hear "Announcement. Press **PLAY** or press **RECORD**." Press **RECORD** and begin speaking after you hear "Record after the tone. Press **STOP** when you are done." Speak facing the telephone base from about nine inches away. Press **▶/■ PLAY/STOP** when you are done. Your recorded announcement will be played back. Press **ANNC** to exit the announcement menu.

Elapsed time (in seconds) will be shown in the message window when recording. You can record an announcement up to 90 seconds long. Announcements shorter than two seconds long will not be recorded.

To delete your outgoing announcement

Press **ANNC**, then you will hear "Announcement. Press **PLAY** or press **RECORD**." Press **▶/■ PLAY/STOP** to begin playback. Press **X DELETE** during playback to delete your announcement. Press **ANNC** to exit the announcement menu.

When your announcement is deleted, calls will be answered with the factory set announcement described above.

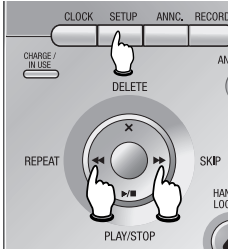

1. **SETUP**
until desired feature is heard (see list at right).

2. **▶SKIP** or **◀REPEAT**
until desired selection is heard.

3. **SETUP**
to set selection and **move** to next menu option.

- OR -

▶/■ PLAY/STOP
to set selection and **exit** menu.

NOTES:

- The message alert tone will beep only if all the conditions below are met:
 - Answering system is on
 - Message alert tone setting is on
 - There are new messages
- Press and hold **▶SKIP** or **◀REPEAT** to increase or decrease the remote access code number by 10.

Changing feature options

You can change how the answering system operates. Press **SETUP** repeatedly to hear each feature. When you hear the feature you want to modify press **▶SKIP** or **◀REPEAT** to change the setting. Press **SETUP** to set selection and move to next menu option, or press **▶/■ PLAY/STOP** to exit.

Feature options (default settings underlined>)

System announces:	Feature description:
"Number of rings," current setting, then "To change the setting press SKIP or REPEAT ; to continue setup, press SETUP ." Options: 2/ <u>4</u> /6/toll saver	Choose number of rings before the system answers a call. When toll saver is active, the system answers after two rings if you have new messages, and after four rings if you have no new messages. When retrieving messages from a long distance call, you may disconnect your call after three rings so that there will be no long distance charge incurred.
"Base ringer," current setting, then "To change the setting press SKIP or REPEAT ; to continue setup, press SETUP ." Options: high/ <u>low</u> /off	Choose telephone base ringer volume to high or low level, or turn the telephone base ringer off.
"Remote access code," current setting, then "To change the setting press SKIP or REPEAT ; to continue setup, press SETUP ." Options: (select two-digit code) <u>19</u>	Select a two-digit number (10-99) for remote access from another telephone (page 42).

"Message alert tone," current setting, then "To change the setting press SKIP or REPEAT ; to continue setup, press SETUP ." Options: on/ <u>off</u>	When on, the telephone beeps every 10 seconds when there are new messages.
--	--

Press any base key (except **RECORD**, **ANSWER ON** and **HANDSET LOCATOR**) to temporarily silence the message alert tone. If you press and hold **X DELETE** you will delete all old messages and the message alert tone will be temporarily silenced. The message alert tone will be re-activated with the next incoming message.

Number of messages (or during playback, message number currently playing).



Press **▶/■ PLAY/STOP** to begin or end message playback.

1.  **▶/■ PLAY/STOP**
 "You have [xx] new messages and [xx] old messages"

Message playback begins. See options at right.

2.  **▶/■ PLAY/STOP**
to end message playback.



NOTES:

1. If **F** is flashing in the message window, memory is full. You will have to delete some messages before new ones can be received.
2. The maximum record time is 14 minutes.
3. If you receive calls when the memory is full, the telephone will ring 10 times, then answer and announce "Memory is full, enter remote access code."
4. New (unheard) messages cannot be deleted.

Message playback

Press **▶/■ PLAY/STOP** to hear messages. The system announces the number of messages, then begins playback.

If you have new messages waiting, you will hear only the new messages (oldest first). If there are no new messages, the system will play back all messages (oldest first).

Announcements during message playback

- When playback begins, you will hear the total number of messages.
- Before each message, you will hear the day and time it was received.
- After the last message, you will hear "End of messages." If the system has less than five minutes of recording time left, you will hear the time remaining.

Options during playback

- Press **⬇ VOLUME** button to adjust speaker volume.
- Press **▶▶ SKIP** to skip to next message.
- Press **◀ REPEAT** to repeat message currently playing. Press twice to hear previous message.
- Press **X DELETE** to delete message being played back.
- Press **▶/■ PLAY/STOP** to stop playback.

To delete all messages

To delete all old messages, press and hold **X DELETE** while the telephone is idle (not during a call or during message playback).



NOTE: If there are many old messages in the mailbox, press and hold **X DELETE** to delete all old messages. This will take up to 20 seconds. The message window will show a flashing - -. During deletion, if there is an incoming call, the answering system will stop deleting messages and exit. In this case, only some of the old messages may be deleted.

Message counter





Message counter displays

The message counter usually displays the total number of memos and incoming messages. See the list below for explanations of other messages in this counter.

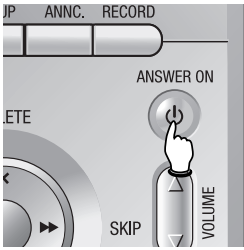

Message counter displays

0	No messages.
0 (<i>flashing</i>)	The clock needs to be set (page 36).
1-99	Total number of messages and memos, or message number currently playing.
1-99 (<i>flashing</i>)	Total number of messages and memos. The number flashes when there are new (un-reviewed) messages. If the telephone loses power, after power is restored, the number in the message counter will flash to indicate the clock needs to be set.
10-99	Current remote access code while setting (page 38).
1-99 (<i>counting</i>)	Elapsed time while recording a memo (page 40) or announcement up to 90 seconds (page 37).
99 (<i>flashing</i>)	Memo recording time has exceeded the maximum counter capacity of 99 seconds.
F (<i>flashing</i>)	Memory is full. Messages must be deleted before new messages can be received.
--	System is answering a call, being accessed remotely, or the clock is being set.
-- (<i>flashing</i>)	System is being setup or initialized.
02, 04, 06, tS	Current number of rings while setting (page 38).
1-8	Displayed for two seconds while telephone base speaker volume being adjusted.
HI, LO, OF	Displayed for two seconds while telephone base ringer volume being adjusted.



1.  Press **ANSWER ON** until the system announces *"Calls will not be answered."*
2.  "Beep,"
The system has been turned off.

-OR-

1.  Press **ANSWER ON** until the system announces *"Calls will be answered."*
2.  "Beep."
The system has been turned on.

Answering system mode

The answering system's default factory setting is **ON** in order to answer and record messages. You can turn the answering system off, but if you do so, the answering system will not answer calls or record incoming messages.

To turn the answering system off

Press **ANSWER ON** until you hear *"Calls will not be answered"* and a confirmation beep. The **ANSWER ON** light will be turned off.



NOTE: If the answering system is off and someone calls, the telephone will ring 10 times then answer and announce *"Please enter your remote access code."* Enter your remote access code to enter remote access mode (page 38). If you do not enter the correct remote access code, the call will be ended automatically.

To turn the answering system on

Press **ANSWER ON** until you hear *"Calls will be answered"* then a beep to confirm the **ON** setting. The **ANSWER ON** light will be turned on.

Call screening

If the answering system is on and the base speaker volume is not off, you will hear the announcement and the incoming message when a call comes in.

Call intercept

While you are call screening, you can intercept the call by pressing **PHONE/FLASH** or **SPEAKER** on the handset.

1. Dial your telephone number from any touch-tone telephone.
2. When system answers, enter two digit remote access code (**19** unless you have changed it).
3. Enter remote commands (see list at right).
4. Hang up to end call and save all undeleted messages.



NOTES:

1. If there are many old messages in the mailbox, after you press **3** twice, it will take up to 20 seconds. During this process, the system will beep every second to alert you that the answering system is deleting all old messages. During this time, if the remote access call is disconnected, the answering system will stop the deletion and exit. In this case, only some of the old messages may be deleted.
2. If you pause for more than four seconds during remote access, the help menu listing all features and commands will be announced. If there is no command for another 20 seconds, the call will end automatically.

Remote access

A two digit security code is required to access your answering system from any touch-tone telephone. This code is **19** by default, see **Changing feature options** (page 38) to change it.









Play all messages 1	Press to hear all messages.
Play new messages 2	Press to hear new messages.
Delete message(s) 3 33	Press once during playback to delete current message. Press twice to delete all old messages.
Repeat or go back 4	Press during the caller's message to repeat the message. Press during the beginning of the day and time announcement to go back to the previous message.
Stop 5	Press to stop any operation (stop playback, stop recording).
Skip to next message 6	Press to skip current message and advance to next message.
Record announcement *7 to begin recording 5 to stop recording	Press * 7 , wait for beep, then begin speaking. Press 5 to stop recording and hear playback of new announcement.
Help menu *5	Press to hear list of features & commands.
Turn system off 0	Press to turn off answering system. Incoming calls will no longer be answered.
Turn system on 0	If off, system will answer after 10 rings. Enter your access code, then press 0 to turn the answering system on.
Exit 8	Press 8 or hang up to end the remote access call.

Screen icons, indicator lights & tones

Screen icons & alert tones

Screen icons



-  The handset is in use.
-  The handset speakerphone is in use.
-  A headset is plugged into the handset and is in use.
-  Microphone is muted.
-  There are new voicemail messages.
-  Ringer off.
-  Battery charging (animated display).
-  Low battery (flashing); place handset in telephone base or charger to recharge.

Handset alert tones

- Two short beeps** The volume level is at the maximum or minimum setting.
- Four short beeps** Low battery warning.
- Two beeps** Out of range from the telephone base while on a call.
- Confirmation tone** Command completed successfully.

Telephone base tones

- One beep every 10 seconds** Message alert feature is on and indicating that you have new messages.
- A series of beeps** The volume level is at the maximum or minimum setting.

Indicator lights



CHARGE / IN USE

- Flashes when another telephone on the same line or one of the handsets is in use.
- Flashes when the answering system is answering an incoming call.
- Flashes during an incoming call's ringing.
- On steady when the handset is properly positioned to charge in the telephone base.

ANSWER ON

On when answering system is on and ready to receive calls.



CHARGE

On when handset is in the charger and charging.

SPEAKER

On when speakerphone is in use.



Handset display screen messages



Screen display messages

XX MISSED CALLS	There are new calls in the caller ID log.
ALREADY SAVED	The telephone number you have entered is already stored in the directory.
CALL LOG EMPTY	You are accessing an empty call log.
CALLING HANDSET X	You have placed an intercom call to another handset.
CALL TRANSFERRED	An external call is transferred to the destination handset.
CHARGING	A handset with a low battery has been placed to charge in the telephone base or charger.
CONNECTING ...	The handset has lost connection with the telephone base.
DIRECTORY EMPTY	You are accessing an empty directory.
ENDED	You have just disconnected a call.
HANDSET X IS CALLING	Another handset is calling.
INCOMING CALL	There is an incoming call.
INTERCOM	The handset is in an intercom call.
INTERCOM ENDED	The intercom call has just been ended by the person on either handset.
LIST FULL	You are attempting to save to a full directory.
LINE IN USE	The other handsets or another telephone on the same line is in use.
LOW BATTERY	The battery needs to be recharged.
MICROPHONE ON	MUTE has been turned off and the person on the other end can hear you.
MICROPHONE MUTED	The handset microphone is now muted.

Handset display screen messages



Screen display messages

NEW VOICE MAIL	There are new voicemail messages.
NO LINE	There is no telephone line connected.
NOT AVAILABLE AT THIS TIME	Someone else is already using the directory or call log which you are trying to access.
NO SIGNAL, CALL ENDED	During a call, the handset is no longer connected with the telephone base. Try moving it closer to the telephone base.
** PAGING **	The telephone base is paging both handsets.
PHONE	The handset is in use.
PLACE IN CHARGER	Battery power is very low. Place the handset in the telephone base or charger to recharge.
SPEAKER	The handset speakerphone is in use.
SAVED	The call log entry was saved to the directory successfully.
NOT AVAILABLE	Failed intercom call.
WARNING CHECK BATTERY!	<p>The battery is not installed or not installed properly in the handset.</p> <p>-OR-</p> <p>The battery needs to be replaced.</p> <p>-OR-</p> <p>An incorrect battery has been installed by mistake. Use only the supplied rechargeable battery or replacement battery (model 27910, part number 89-0099-00-00) or equivalent. To order a replacement battery, visit our website at www.telephones.att.com or call 1 (800) 222-3111. In Canada dial 1 (866) 288-4268.</p>

Troubleshooting

If you have difficulty with your telephone, please try the suggestions below. For Customer Service, visit our website at www.telephones.att.com or call 1 (800) 222-3111. In Canada dial 1 (866) 288-4268.

My telephone does not work at all.

- Make sure the battery is installed and charged correctly (page 7). For optimum daily performance, return the cordless handset to the telephone base after use.
- Make sure the power adapter is securely plugged into an outlet not controlled by a wall switch.
- Make sure the telephone line cord is plugged firmly into the telephone base and the modular wall jack.
- Unplug the telephone's electrical power. Wait for approximately 15 seconds, then plug it back in. Allow up to one minute for the cordless handset and base to synchronize.
- Charge the battery in the cordless handset for at least 16 hours.
- Remove and re-insert the battery. If that still does not work, it may be necessary to purchase a new battery. Please refer to the **Battery installation & charging** section of this user's manual (page 7).
- Disconnect the telephone base from the telephone line wall jack and plug in a working telephone. If this telephone does not work, the problem is probably in the wiring or the local service. Call the local telephone company.

There is no dial tone.

- **First, try all the above suggestions.**
- **Move the cordless handset closer to the telephone base.** It might be out of range.
- **The telephone line cord might be malfunctioning.** Try installing a new telephone line cord.
- **Disconnect the telephone base from the telephone jack and connect a different telephone.** If there is no dial tone on the telephone either, the problem is in your wiring or local service. Contact your local telephone company.

Troubleshooting

- I cannot dial out.
- First, try all the above suggestions.
 - Make sure there is a dial tone before dialing. It is normal if the cordless handset takes a second or two to synchronize with the telephone before producing a dial tone. Wait an extra second before dialing.
 - Check that all the telephones connected to the same telephone line are hung up.
 - Make sure the telephone is set to the correct dial mode (pulse dial or tone dial) for the service in your area. Refer to the **Handset settings** section of this user's manual (page 18) to set the dial mode.
 - If the other telephones in your home are having the same problem, the problem is in the wiring or local service. Contact your local telephone company (charges may apply).
 - Eliminate any background noise. Noise from a television, radio, or other appliances may cause the telephone to not dial out properly. If you cannot eliminate the background noise, first try muting the cordless handset before dialing, or dialing from another room in your home with less background noise.
-

LOW BATTERY is displayed on screen.

- Place the handset in the base or charger for recharging.
 - Remove and re-install the battery and use it normally until fully discharged, then recharge the handset on the telephone base or charger for 16 hours.
 - If the above measures do not correct the problem, the battery may need to be replaced.
-

The battery does not charge in the handset or the handset battery does not accept charge.

- Make sure the handset is placed in the telephone base or charger correctly. The **CHARGE** light on the telephone base or charger should be on.
- If the cordless handset is in the charger or in the telephone base but the **CHARGE** light is not on, refer to **The CHARGE light is off** in this section (page 49).

Troubleshooting

- It may be necessary to purchase a new battery. Please refer to the **Battery installation & charging** section of this user's manual (page 7).
 - The telephone might be malfunctioning. Please refer to the **Limited warranty** section of this user's manual (page 61) for further instruction.
-

The **CHARGE** light is off.

- Clean the metallic charging contacts on the cordless handsets each month using a pencil eraser or a dry non-abrasive fabric.

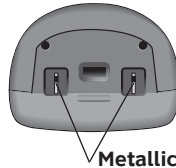

Metallic charging contacts

- Make sure the power adapter and telephone line cords are plugged in correctly and securely.
 - Unplug the power adapter. Wait for 15 seconds before plugging it back in. Allow up to one minute for the cordless handset and telephone base to reset.
 - The telephone might be malfunctioning. Please refer to the **Limited warranty** section of this user's manual for further instruction (page 61).
-

The telephone does not ring when there is an incoming call.

- Make sure the ringer is on. (See page 24 for handset and page 38 for telephone base).
- Make sure the telephone line cord and power adapter are plugged in properly (page 6).
- The cordless handset may be too far from the telephone base. Move it closer to the telephone base.
- There may be too many extension telephones on the telephone line to allow all of them to ring simultaneously. Try unplugging some of them.
- If the other telephones in your home are having the same problem, the problem is in the wiring or local service. Contact the local telephone company (charges may apply).

Troubleshooting

- Other electronic products can cause interference to your cordless telephone. Try installing your telephone as far away as possible from the following electronic devices: wireless routers, radios, radio towers, pager towers, cellular telephones, digital telephones, intercoms, room monitors, televisions, VCRs, personal computers, kitchen appliances, and other cordless telephones.
- **Test a working telephone at the same telephone jack.** If another telephone has the same problem, the problem is in the telephone jack. Contact your local telephone company (charges may apply).
- **The telephone line cord might be malfunctioning.** Try installing a new telephone line cord.
- **Remove and re-install the battery and place the cordless handset in the telephone base.**
- **Wait for the cordless handset to synchronize with the telephone base.** Allow up to one minute for this to take place.

My telephone rings but when I try to answer the call the handset screen shows **CONNECTING...**

- The cordless handset may be too far from the telephone base. Move closer to the telephone base and try to answer the call.

CONNECTING... displays on my cordless handset.

- Ensure that the telephone base is powered up.
- Place the cordless handset in the telephone base for one minute to allow the cordless handset and telephone base to resynchronize channels.
- Move the cordless handset closer to the telephone base. You might have moved out of range.
- If the cordless handset is in its telephone base and the **CHARGE** light does not come on, refer to **The CHARGE light is off** section in this troubleshooting guide (page 49).
- Reset the telephone base. Unplug the telephone base's electrical power. Wait for 15 seconds then plug it back in. Allow up to one minute for the cordless handset and telephone base to reset.

Troubleshooting

- Other electronic products can cause interference with your cordless telephone. Try installing your telephone as far away from these types of electronic devices as possible. These devices include: routers, radios, radio towers, pager towers, cell phones, intercoms, room monitors, televisions, personal computers, kitchen appliances and cordless telephones.

There is noise or interference during a telephone conversation.

- The handset may be out of range. Move it closer to the telephone base.
- Appliances or other cordless telephones plugged into the same circuit as the telephone base can cause interference. Try moving the appliance or telephone base to another outlet.

My calls fade out or cut in and out when I am using the cordless handset.

- Other electronic products can cause interference to your cordless telephone. Try installing your telephone as far away as possible from the following electronic devices: wireless routers, radios, radio towers, pager towers, cellular telephones, digital telephones, intercoms, room monitors, televisions, VCRs, personal computers, kitchen appliances and other cordless telephones.
- If you have a headset plugged into the handset, try unplugging it and firmly plugging it in again.
- Microwave ovens operate on the same frequency as your telephone. It is normal to experience static on your telephone while the microwave oven is operating. Do not install this telephone in the same outlet or near a microwave oven.
- If your telephone is plugged in with a modem or a surge protector, plug the telephone (or modem/surge protector) into a different location. If this solves the problem, re-locate your telephone or modem farther apart from each other, or use a different surge protector.
- The layout of your home or office might be limiting the operating range. Try moving the base to another location, preferably a higher location for better reception.

Troubleshooting

- Disconnect the telephone base from the modular jack and plug in a corded telephone. If calls are still not clear, the problem is probably in the wiring or local service. Contact your local service company (charges may apply).
- Other cordless telephones and 802.11 wireless routers that are used for home computer networks both use internal radios to communicate. The radios may interfere with one another. You can improve the performance of your cordless telephones and your router by:
 - a. Positioning your new telephone as far away from any other already installed cordless telephone in your home as possible. This will hinder the interference of the two systems with one another.
 - b. Positioning your telephone base as far as possible from your router, computer or any other computer devices.
 - c. Selecting channels 4 through 10 for your router (refer to your router's user manual for more information).
- Do you have DSL service? If yes, you need to have a DSL filter installed at every telephone jack that has a telephone connected to it. Contact your DSL service provider for filter information

I hear other calls when using the telephone.

- Disconnect the telephone base from the telephone jack. Plug in a different telephone. If you still hear other calls, the problem is probably in the wiring or local service. Call your local telephone company.

My caller ID features are not working properly.

- Caller ID is a subscription service. You must subscribe to this service from your local telephone company for this feature to work on your telephone.
- The caller may not be calling from an area which supports caller ID.
- Both you and the caller's telephone companies must use equipment which are compatible with caller ID service.
- If you subscribe to DSL service, install a DSL filter to the telephone line between the telephone base and the telephone line jack. Contact your DSL service provider for filter information.

Troubleshooting

The system does not receive caller ID or the system does not display caller ID during call waiting.

- Make sure you subscribe to caller ID with call waiting features services provided by the local telephone company.
- The caller may not be calling from an area which supports caller ID.
- Both you and the caller's telephone companies must use equipment which are compatible with caller ID service.
- If you subscribe to DSL service, install a DSL filter to the telephone line between the telephone base and the telephone line jack. Contact your DSL service provider for filter information.

Common cure for electronic equipment.

- If the telephone is not responding normally, try putting the cordless handset in the telephone base or the charger. If it does not seem to respond, try the following (in the order listed):
 1. Disconnect the power to the telephone base.
 2. Disconnect the battery on the cordless handset.
 3. Wait a few minutes before connecting power to the telephone base.
 4. Re-install the battery and place the cordless handset into the telephone base or charger.
 5. Wait for the cordless handset to synchronize its connection with the telephone base. Allow up to one minute for this to take place.

The answering system does not answer after the correct number of rings.

- Make sure the answering system is on. When the answering system is on, the **ANSWER ON** key on the telephone base will be lit.
- If Toll Saver is activated, the number of rings changes to two when there are new messages waiting (page 38).
- If the memory is full or if the answering system is off, the system will answer after ten rings and announce *"Please enter remote access code."* If the memory is full, you need to delete some old messages in order to make room for new messages.

Troubleshooting

- The announcement message is not clear.
- When recording the announcement, make sure you speak in a normal tone of voice about nine inches from the telephone base.
 - Make sure there is no background noise (television, music, traffic, etc.) when recording.
-

- The answering system does not record message.
- Make sure the answering system is on.
 - If the memory is full, the system will answer after ten rings and announce *"Memory is full. Enter remote access code."* You need to delete some old messages in order to make room for new messages.
-

- The messages on the answering system are incomplete.
- If a caller reaches the maximum recording time of four minutes, for each message, the system will disconnect and part of the message may be lost.
 - If the caller pauses for more than seven seconds, the system stops recording and disconnects the call.
 - If the memory on the system becomes full during a message, the system stops recording and disconnects the call.
 - If the caller's voice is very soft, the system may stop recording and disconnect the call.
-

- The messages on the system are very difficult to hear.
- Press **◆ VOLUME** on the telephone base to increase the speaker volume.
-

- The answering system does not respond to remote commands.
- Make sure your remote access code is correct (page 38).
 - Make sure you are calling from a touch-tone telephone. When dialing a number, you should hear tones. If you hear clicks, then it is not a touch-tone telephone and cannot activate the answering system.
 - The answering system may not detect the remote access code when your announcement is playing. Wait until the announcement is over before entering the code.
 - There may be interference on the telephone line you are using. Press the dial pad keys firmly when dialing.
-

- "Time and day not set" prompts.
- You need to set the answering system clock (page 36).

Important safety instructions



This symbol is to alert you to important operating or servicing instructions that may appear in this user's manual. Always follow basic safety precautions when using this product to reduce the risk of injury, fire, or electric shock.

Safety information

- **Read and understand all instructions in the user's manual. Observe all markings on the product.**
- **Avoid using a telephone during a thunderstorm.** There may be a slight chance of electric shock from lightning.
- **Do not use a telephone in the vicinity of a gas leak.** If you suspect a gas leak, report it immediately, but use a telephone away from the area where gas is leaking. If this product is a cordless model, make sure the base is also away from the area.
- **Do not use this product near water, or when you are wet.** For example, do not use it in a wet basement or shower, or next to a swimming pool, bathtub, kitchen sink, or laundry tub. Do not use liquids or aerosol sprays for cleaning. If the product comes in contact with any liquids, unplug any line or power cord immediately. Do not plug the product back in until it has dried thoroughly.
- **Install this product in a protected location** where no one can trip over any line or power cords. Protect cords from damage or abrasion.
- **If this product does not operate normally, read Troubleshooting in this user's manual.** If you cannot solve the problem, or if the product is damaged, refer to the limited warranty. Do not open this product except as may be directed in your user's manual. Opening the product or reassembling it incorrectly may expose you to hazardous voltages or other risks.
- **If this product has user-replaceable batteries, replace batteries only as described in your user's manual.** Do not burn or puncture batteries — they contain caustic chemicals.
- **If this product has a three-prong (grounding) plug or a polarized plug with one wide prong,** it may not fit in non-polarized outlets. Do not defeat the purpose of these plugs. If they do not fit in your outlet, the outlet should be replaced by an electrician.



CAUTION: Use only the power adapter provided with this product. To obtain a replacement, visit our website at www.telephones.att.com or call 1(800) 222-3111. In Canada dial 1 (866) 288-4268.

Important safety instructions

Especially about cordless telephones

- **Privacy:** The same features that make a cordless phone convenient create some limitations. Telephone calls are transmitted between the base and the handset by radio waves, so there is a possibility that your cordless phone conversations could be intercepted by radio receiving equipment within range of the cordless handset. **For this reason, you should not think of cordless phone conversations as being as private as those on corded phones.**
- **Electrical power:** The telephone base of this cordless telephone must be connected to a working electrical outlet. The electrical outlet should not be controlled by a wall switch. **Calls cannot be made from the handset if the telephone base is unplugged or switched off, or if the electrical power is interrupted.**
- **Power adapter:** The power adapter is intended to be correctly oriented in a vertical or floor mount position. The prongs are not designed to hold the plug in place if it is plugged into a ceiling or an under-the-table/cabinet outlet.
- **Potential TV interference:** Some cordless telephones operate at frequencies that may cause interference to TVs and VCRs. To minimize or prevent such interference, do not place the telephone base of the cordless telephone near or on top of a TV or VCR. If interference is experienced, moving the cordless telephone farther away from the TV or VCR will often reduce or eliminate the interference.
- **Rechargeable batteries:** This product contains either nickel-cadmium or nickel-metal hydride rechargeable batteries. Exercise care in handling batteries in order not to short the battery with conducting material such as rings, bracelets, and keys. The battery or conductor may overheat and cause harm. Observe proper polarity between the battery and the battery charger.
- **Nickel-cadmium rechargeable batteries:** Must be recycled or disposed of properly. Do not dispose of in household garbage. Do not burn or puncture. Like other batteries of this type, if burned or punctured, they could release caustic material which could cause injury.



The RBRC™ Seal means that the manufacturer is voluntarily participating in an industry program to collect and recycle nickel-cadmium rechargeable batteries when taken out of service within the United States. These batteries may be taken to a participating local retailer of replacement batteries or recycling center. Or you may call 1-800-8-BATTERY for locations accepting spent nickel-cadmium Batteries.

Important safety instructions

- **Nickel-metal hydride rechargeable batteries:** Dispose of these batteries in a safe manner. Do not burn or puncture. Like other batteries of this type, if burned or punctured, they could release caustic material which could cause injury.



The RBRC™ Seal means that the manufacturer is voluntarily participating in an industry program to collect and recycle nickel-metal hydride rechargeable batteries when taken out of service within the United States. These batteries may be taken to a participating local retailer of replacement batteries or recycling center. Or you may call 1-800-8-BATTERY for locations accepting spent nickel-metal hydride Batteries.

Precautions for users of implanted cardiac pacemakers

Cardiac pacemakers (applies only to digital cordless telephones):

Wireless Technology Research, LLC (WTR), an independent research entity, led a multidisciplinary evaluation of the interference between portable wireless telephones and implanted cardiac pacemakers. Supported by the U.S. Food and Drug Administration, WTR had recommended to physicians that:

Pacemaker patients

- Should keep wireless phones at least six inches from the pacemaker.
- Should NOT place wireless phones directly over the pacemaker, such as in a breast pocket, when it is turned ON.
- Should use the wireless phone at the ear opposite the pacemaker.

WTR's evaluation did not identify any risk to bystanders with pacemakers from other persons using wireless phones.

Especially about telephones answering systems

Two-way recording: This unit does not sound warning beeps to let the other party know that the call is being recorded. To ensure that you are in compliance with any federal or state regulations regarding recording a telephone call, you should start the recording process and then inform the other party that you are recording the call.

SAVE THESE INSTRUCTIONS

FCC Part 68 & ACTA

This equipment complies with Part 68 of the FCC rules and with technical requirements adopted by the Administrative Council for Terminal Attachments (ACTA). The label on the back or bottom of this equipment contains, among other things, a product identifier in the format US: AAAEQ##TXXXX. This identifier must be provided to your local telephone company upon request.

The plug and jack used to connect this equipment to premises wiring and the telephone network must comply with applicable Part 68 rules and technical requirements adopted by ACTA. A compliant telephone cord and modular plug is provided with this product. It is designed to be connected to a compatible modular jack that is also compliant. An RJ11 jack should normally be used for connecting to a single line and an RJ14 jack for two lines. See Installation Instructions in the user's manual.

The Ringer Equivalence Number (REN) is used to determine how many devices you may connect to your telephone line and still have them ring when you are called. The REN for this product is encoded as the 6th and 7th characters following the US: in the product identifier (e.g., if ## is 03, the REN is 0.3). In most, but not all areas, the sum of all RENs should be five (5.0) or less. For more information, please contact your local telephone company.

This equipment may not be used with Party Lines. If you have specially wired alarm dialing equipment connected to your telephone line, ensure the connection of this equipment does not disable your alarm equipment. If you have questions about what will disable alarm equipment, consult your telephone company or a qualified installer.

If this equipment is malfunctioning, it must be unplugged from the modular jack until the problem has been corrected. Repairs to this telephone equipment can only be made by the manufacturer or its authorized agents. For repair procedures, follow the instructions outlined under the Limited warranty.

If this equipment is causing harm to the telephone network, the telephone company may temporarily discontinue your telephone service. The telephone company is required to notify you before interrupting service. If advance notice is not practical, you will be notified as soon as possible. You will be given the opportunity to correct the problem and the telephone company is required to inform you of your right to file a complaint with the FCC. Your telephone company may make changes in its facilities, equipment, operation, or procedures that could affect the proper functioning of this product. The telephone company is required to notify you if such changes are planned.

FCC Part 68 & ACTA

If this product is equipped with a corded or cordless handset, it is hearing aid compatible.

If this product has memory dialing locations, you may choose to store emergency telephone numbers (e.g., police, fire, medical) in these locations. If you do store or test emergency numbers, please:

- Remain on the line and briefly explain the reason for the call before hanging up.
- Perform such activities in off-peak hours, such as early morning or late evening.

FCC Part 15

This equipment has been tested and found to comply with the requirements for a Class B digital device under Part 15 of the Federal Communications Commission (FCC) rules.

These requirements are intended to provide reasonable protection against harmful interference in a residential installation. This equipment generates, uses and can radiate radio frequency energy and, if not installed and used in accordance with the instructions, may cause harmful interference to radio communications. However, there is no guarantee that interference will not occur in a particular installation.

If this equipment does cause harmful interference to radio or television reception, which can be determined by turning the equipment off and on, the user is encouraged to try to correct the interference by one or more of the following measures:

- Reorient or relocate the receiving antenna.
- Increase the separation between the equipment and receiver.
- Connect the equipment into an outlet on a circuit different from that to which the receiver is connected.
- Consult the dealer or an experienced radio/TV technician for help.

Changes or modifications to this equipment not expressly approved by the party responsible for compliance could void the user's authority to operate the equipment.

To ensure safety of users, the FCC has established criteria for the amount of radio frequency energy that can be safely absorbed by a user or bystander according to the intended usage of the product. This product has been tested and found to comply with the FCC criteria. The handset may be safely held against the ear of the user. The telephone base shall be installed and used such that parts of the user's body other than the hands are maintained at a distance of approximately 20 cm (8 inches) or more. If you choose to use a clipping device, please make sure to only use the supplied AT&T belt clip.

Limited warranty

The AT&T brand is used under license - any repair, replacement or warranty service, and all questions about this product should be directed to: In the United States of America visit www.telephones.att.com or call 1(800) 222-3111. In Canada dial 1 (866) 288-4268.

1. What does this limited warranty cover?

The manufacturer of this AT&T-branded product warrants to the holder of a valid proof of purchase (“CONSUMER” or “you”) that the product and all accessories provided in the sales package (“PRODUCT”) are free from defects in material and workmanship, pursuant to the following terms and conditions, when installed and used normally and in accordance with the PRODUCT operating instructions. This limited warranty extends only to the CONSUMER for products purchased and used in the United States of America and Canada.

2. What will be done if the PRODUCT is not free from defects in materials and workmanship during the limited warranty period (“materially defective PRODUCT”)?

During the limited warranty period, the manufacturer’s authorized service representative will repair or replace at the manufacturer’s option, without charge, a materially defective PRODUCT. If the manufacturer repairs the PRODUCT, they may use new or refurbished replacement parts. If the manufacturer chooses to replace the PRODUCT, they may replace it with a new or refurbished PRODUCT of the same or similar design. The manufacturer will retain defective parts, modules, or equipment. Repair or replacement of the PRODUCT, at the manufacturer’s option, is your exclusive remedy. The manufacturer will return repaired or replacement products to you in working condition. You should expect the repair or replacement to take approximately 30 days.

3. How long is the limited warranty period?

The limited warranty period for the PRODUCT extends for ONE (1) YEAR from the date of purchase. If the manufacturer repairs or replaces a materially defective PRODUCT under the terms of this limited warranty, this limited warranty also applies to repaired or replacement PRODUCT for a period of either (a) 90 days from the date the repaired or replacement PRODUCT is shipped to you or (b) the time remaining on the original one-year limited warranty; whichever is longer.

Limited warranty

4. What is not covered by this limited warranty?

This limited warranty does not cover:

- PRODUCT that has been subjected to misuse, accident, shipping or other physical damage, improper installation, abnormal operation or handling, neglect, inundation, fire, water, or other liquid intrusion; or
- PRODUCT that has been damaged due to repair, alteration, or modification by anyone other than an authorized service representative of the manufacturer; or
- PRODUCT to the extent that the problem experienced is caused by signal conditions, network reliability or cable or antenna systems; or
- PRODUCT to the extent that the problem is caused by use with non-AT&T accessories; or
- PRODUCT whose warranty/quality stickers, PRODUCT serial number plates or electronic serial numbers have been removed, altered or rendered illegible; or
- PRODUCT purchased, used, serviced, or shipped for repair from outside the United States of America or Canada, or used for commercial or institutional purposes (including but not limited to products used for rental purposes); or
- PRODUCT returned without valid proof of purchase (see item 6 below); or
- Charges for installation or setup, adjustment of customer controls, and installation or repair of systems outside the unit.

5. How do you get warranty service?

To obtain warranty service in the United States of America, call 1 (800) 222-3111; in Canada, please dial 1 (866) 288-4268. NOTE: Before calling for service, please review the user's manual - a check of the PRODUCT controls and features may save you a service call.

Except as provided by applicable law, you assume the risk of loss or damage during transit and transportation and are responsible for delivery or handling charges incurred in the transport of the PRODUCT(s) to the service location. The manufacturer will return repaired or replaced PRODUCT under this limited warranty to you, transportation, delivery or handling charges prepaid. The manufacturer assumes no risk for damage or loss of the PRODUCT in transit. If the PRODUCT failure is not covered by this limited warranty, or proof of purchase does not meet the terms of this limited warranty, the manufacturer will notify you and will request that you authorize the cost of repair prior to any further repair activity. You must pay for the cost of repair and return shipping costs for the repair of products that are not covered by this limited warranty.

Limited warranty

6. What must you return with the PRODUCT to get warranty service?

You must:

- a. Return the entire original package and contents including the PRODUCT to the service location along with a description of the malfunction or difficulty; and
- b. Include “valid proof of purchase” (sales receipt) identifying the PRODUCT purchased (PRODUCT model) and the date of purchase or receipt; and
- c. Provide your name, complete and correct mailing address, and telephone number.

7. Other limitations

This warranty is the complete and exclusive agreement between you and the manufacturer of this AT&T branded PRODUCT. It supersedes all other written or oral communications related to this PRODUCT. The manufacturer provides no other warranties for this PRODUCT. The warranty exclusively describes all of the manufacturer’s responsibilities regarding the PRODUCT. There are no other express warranties. No one is authorized to make modifications to this limited warranty and you should not rely on any such modification.

State/Provincial Law Rights: This warranty gives you specific legal rights, and you may also have other rights which vary from state to state or province to province.

Limitations: Implied warranties, including those of fitness for a particular purpose and merchantability (an unwritten warranty that the PRODUCT is fit for ordinary use) are limited to one year from date of purchase. Some states/provinces do not allow limitations on how long an implied warranty lasts, so the above limitation may not apply to you. In no event shall the manufacturer be liable for any indirect, special, incidental, consequential, or similar damages (including, but not limited to lost profits or revenue, inability to use the PRODUCT or other associated equipment, the cost of substitute equipment, and claims by third parties) resulting from the use of this PRODUCT. Some states/provinces do not allow the exclusion or limitation of incidental or consequential damages, so the above limitation or exclusion may not apply to you.

Please retain your original sales receipt as proof of purchase.

Technical specifications

RF frequency band (handset to base)	2400 MHz — 2483.5 MHz
RF frequency band (base to handset)	2400 MHz — 2483.5 MHz
Channels	95
Operating temperature	32°F — 122°F 0°C — 50°C
Telephone base voltage (AC adapter input)	AC117V 60Hz
Telephone base voltage (AC adapter output)	DC9V 400mA
Handset voltage	3.6V 600mAh Ni-MH battery
Charger voltage (AC adapter output)	DC9V 150mA

Telephone operating range

This cordless telephone operates with the maximum power allowed by the Federal Communications Commission (FCC). Even so, the handset(s) and telephone base can communicate over only a certain distance - which can vary with the locations of the telephone base and handset(s), the weather, the layout, and the construction of your home or office.

Index

A

Alert tones, 44
Answering calls, 11
Answering system, 35-43
Announcement, 37

B

Battery charging, 7
Battery installation, 7
Belt clip, 10
Brightness, 23

C

Call intercept, 42
Call screening, 42
Call log, 31
Call transfer, 17
Call waiting, 14
Caller ID, 31-34
Clear voice mail indication, 20
Contrast, 22

D

Delete call log entries, 34
Delete redial entries, 12
Dial Type, 18
Dialing,
 from a CID record, 34
 directory dialing, 30
Directory, 25
 delete entries, 30
 dial number, 30
 edit entries, 30
 name search, 29
 new entries, 26
DSL filter, 6

E

Elapsed time, 11
Ending calls, 11

F

FCC and ACTA, 58

H

Hands-free use, 11
Handset locator, 13
Headset, 10

I

Important safety instructions, 55
Intercom, 16
Intercom call transfer, 17
Incoming call log, 34
Incoming calls answering, 11
Indicator lights, 44

K

Key tone, 21

L

Language, 18
Last number redial, 12
Low battery, 7

M

Making calls, 11
Memory match, 33
Menus, 18
Message playback, 39
Multiple Handset use, 14
Mute, 15

N

Names,
 enter into directory, 27
 search for, 29

Index

O

Operating range, 64

P

Part checklist, 4
Predial, 11
Power adapter, 6

Q

Quick reference guide, 2-3

R

Receiving calls, 11
Recharging, 7
Redial, 12
Remote access, 43
Ring silencing, 12
Ringer melody, 21
Ringer volume, 24

S

Screen display messages, 45
Screen icons, 44
Search for names, 29
Set day and time, 36
Speakerphone, 11

T

Tabletop mounting, 9
Technical specifications, 64
Telephone base installation, 5-6
Temporary ring silencing, 12
Temporary tone dialing, 15
Troubleshooting, 47

V

Volume control, 14 & 39
Voice prompts, 35

W

Wall mounting, 8
Wallpaper, 22
Warranty, 61

Remote access wallet card

Use the wallet card below to help you remember commands to control your answering system from any touch tone telephone.

Cut along dotted line.



Call your phone number, then enter your two-digit access code (preset to **19**).

Action	Remote command
--------	----------------

- | | |
|-------------------------------|-----------|
| Play all messages | 1 |
| Play new messages..... | 2 |
| Delete the message..... | 3 |
| Delete all old messages | 33 |
| Repeat or go back..... | 4 |
| Stop..... | 5 |
| Help menu | *5 |

Fold here.

- | | |
|------------------------------|-----------------------|
| Skip the message..... | 6 |
| Record announcement | *7 |
| Turn system off or on | 0 |
| End remote access call | 8 (or hang up) |

**2.4 GHz Cordless telephone/answering system
E2913B/E1113B**



www.telephones.att.com